

~~DEEL JAMES H & BETTY~~
~~RT 1 BOX 126~~
~~HAYSI VA~~

24256

DATE RECORDED 5-73
 DEED OR WILL BOOK DB 0160 0378
 CONSIDERATION

CLASS 2
 ZONING
 DISTRICT 05

LEGAL DESCRIPTION
 CANE BRANCH
 7.31AC 6.57AC

~~OPPIN FLOYD M & CONICE~~

~~RT 2 BOX 432~~

~~HAYSI, VA 24256~~

~~DEEL DEMPSEY & SHARON G.~~

~~PO Box 721~~

~~HAYSI, VA 24256~~

DATE RECORDED 4-20-95

DEED OR WILL BOOK 308-371

CONSIDERATION 21600

DATE RECORDED 11-21-96

DEED OR WILL BOOK 321-786

CONSIDERATION 25000.

DATE RECORDED

DEED OR WILL BOOK

CONSIDERATION

DATE RECORDED

DEED OR WILL BOOK

CONSIDERATION

1992			
1993			
1994	6,000	15,600	21,600
1995	6000	15600	21600
1996	6000	15600	21600
1997			
1998	2600	-	2600
1999	2,600		2600
2000			
2001			
2002			
2003			

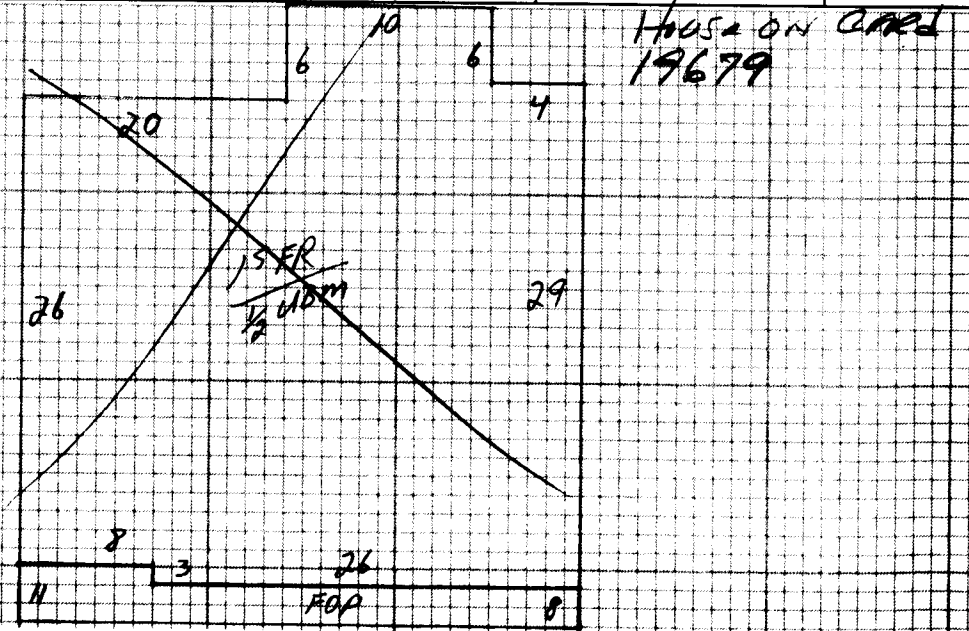

NOTES: .74 ac & House to BART DEEL

Dwelling	✓	Comp. Sh.		Wood Siding	✓	Yr. Built	35	Remod.		Bemt.	[] 2nd []	Plaster		BATH(S)	1 Full 1/2 Bath(s)
		Slate		Brick		No. Stories	1			1st	17 3rd []	Sheet rock	✓	Modern Bath	[] Modern Kitchen []
		Asbestos		Asb. Wood Shg.		B. Level	[]	S. Foyer	[]	Total No. Bedrooms		Ceciled		Cent. Heat	Oil A/C
		Metal	✓	Cin. Block [] Stone []								Panel	✓	Fir. or Wall Furnace	[] Stove(s) []
Wood Frame	✓	Tar & Grav.		Stucco [] Con. Block []		Crawl [] Conc. []		HW	✓	Pine [] Carp. [] Tile []	Unfinished				
Cin. Block		Tile		Aluminum [] Masonite []		Flers [] Cin. Blk. []								Number 270	
Steel Frame		Shakes		Storm Doors [] Storm Win. []		Slab [] Brick []				Disappearing Stairs				Number Chimneys	

					Basement Size	1/2	Attic Floor & Stairs		Brick [] C. Block []	
					Gd. [] Fair [] Poor [] VP []	Bemt. Finish	1/4 [] 1/2 [] 3/4 [] Full []	Attic	Walls [] Fl. []	Stone [] Metal []

PK 1022 31 3168 2

Dwelling																
Porch	0	296	8	2368												
Porch																
Carport																
Garage																
Cent. A/C																
Basement	511	5	33	22												
Bemt. Finish																
Attic																
Fireplace(s)																
Heating																
Bath(s)																

M & L	M & L	Market Value All Improvements	15600
DATE	DATE	Market Value All Land	16000
APRP.	APRP.	TOTAL MARKET VALUE	21600
DATE	DATE		2600
CLASSIFICATION	ZONING		

Total	37372		
Factor	.87		
Replacement	32513		

PROPERTY CLASSIFICATION															Land Cost	\$
SALES HISTORY															Bldg. Cost	\$
															Sale Price	\$
															Rent	\$
															Expenses	\$
															Net Rent	\$

PROPERTY CLASSIFICATION		CLASSIFICATION	ACRES	RATE	ADJ.	CLASSIFICATION	ACRES	RATE	ADJ.
Public Water	✓ Paved	Home Site	7			Home Site			
Public Sewer	Gravel		6.31	400					
Well	Dirt		6.57						
Spring	No Road								
Septic System	✓ Curb & Gutter	Wasteland				Wasteland			
U. G. Utilities	Sidewalk		7.31						

General Remarks:

LEVEL [] SLOPES UP [] SLOPES DOWN []

LOW [] STEEP UP [] STEEP DOWN []

Deel, Dempsey & Sharon G.
 P.O. Box 721
 Haysi, VA 24256

DATE RECORDED 11-21-96
 DEED OR WILL BOOK 321-786
 CONSIDERATION 25,000

CLASS 2
 ZONING
 DISTRICT 05

LEGAL DESCRIPTION
 Cane Branch
 6.57 AC

DATE RECORDED	
DEED OR WILL BOOK	
CONSIDERATION	
DATE RECORDED	
DEED OR WILL BOOK	
CONSIDERATION	
DATE RECORDED	
DEED OR WILL BOOK	
CONSIDERATION	
DATE RECORDED	
DEED OR WILL BOOK	
CONSIDERATION	
DATE RECORDED	
DEED OR WILL BOOK	
CONSIDERATION	

1992			
1993			
1994			
1995			
1996			
1997			
1998	5,700	36,800	39,400
1999	5,700	61,300	63,900
2000			
2001			
2002			
2003			

BUILDING PERMITS

NOTES: Mr. & Mrs. Deel came in on 7-30-99 and said this home belonged on this property, sent the home and 3,100 of land out on Supplement for 1998 and 1999, due to the fact that the land value increased because of the home site being located on that property. May also want to see note on prior card.

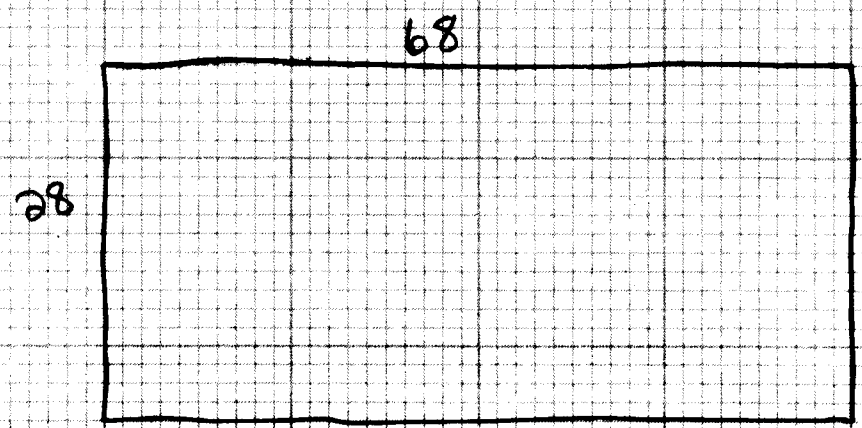

From Card # 8953

Table with property characteristics: Dwelling, Comp. Sh., Wood Siding, Yr. Built, Remod., Bmnt., Plaster, BATH(S), Full 1/2 Bath(s), Slate, Brick, No. Stories, 1st [] 3rd [], Sheet rock, Modern Bath [] Modern Kitchen [], Asbestos, Asb. Wood Shg., S. Level [] S. Foyer [], Total No. Bedrooms, Ceciled, Cent. Heat, A/C, Metal, Cin. Block [] Stone [], Panel, Fir. or Wall Furnace [] Stove(s) [], Wood Frame, Tar & Grav., Stucco [] Con. Block [], Crawl [] Conc. [], HW [] Pine [] Carp. [] Tile [], Unfinished, Cin. Block, Tile, Aluminum [] Masonite [], Riers [] Cin. Blk. [], Basement Size, Attic Floor & Stairs, Gd. [] Fair [] Poor [] VP [], Number Chimneys, Steel Frame, Shakes, Storm Doors [] Storm Win. [], Slab [] Brick [], Disappearing Stairs, Gd. [] Fair [] Poor [] VP [], Brick [] C. Block [],

Table with valuation and classification data: Gd. [] Fair [] Poor [] VP [], Basement Finish, 1/4 [] 1/2 [] 3/4 [] Full [], Attic [] Walls [] Fl. [], Stone [] Metal [], YR., YR., YR., Dwelling, 61,289 (100% Complete 98), 36,903, 61,300 (100% Complete 99).

Table with financial and classification details: 904 5 9520, M & L, DATE, APRP. BA, DATE 8-25-98, 1-13-98, CLASSIFICATION, ZONING, Market Value All Improvements, 36,900, 61,300, Market Value All Land, 5,900, 5,200, Total, 70,448, Factor, 187, Replacement, 61,289, Land Cost, Bldg. Cost, Sale Price, Rent, Expenses, Net Rent.

Table with zoning and utility details: PROPERTY FACTORS, CLASSIFICATION, ACRES, RATE, ADJ., CLASSIFICATION, ACRES, RATE, ADJ., Home Site, 5.57 400, 3500, 2200, Home Site, Wasteland, 5700, Wasteland, BOARD REVIEW NOTES.

Table with general remarks and leveling options: General Remarks, LEVEL [] SLOPES UP [] SLOPES DOWN [], LOW [] STEEP UP [] STEEP DOWN [].