

HENRY DONALD F & DEBORAH RT 1 BOX 294 HAYSI VA 24256	DATE RECORDED	
	DEED OR WILL BOOK	
	CONSIDERATION	
	DATE RECORDED	
	DEED OR WILL BOOK	
	CONSIDERATION	
	DATE RECORDED	
	DEED OR WILL BOOK	
	CONSIDERATION	
	DATE RECORDED	
	DEED OR WILL BOOK	
	CONSIDERATION	
	DATE RECORDED	
	DEED OR WILL BOOK	
	CONSIDERATION	

CLASS	5	LEGAL DESCRIPTION TWIN BRANCH 66AC
ZONING		
DISTRICT	05	

1992	28,600	5800	34,400	
1993	28,600	5800	34,400	
1994				
1995				
1996				
1997				
1998				
1999				
2000				
2001				
2002				
2003				

NOTES:

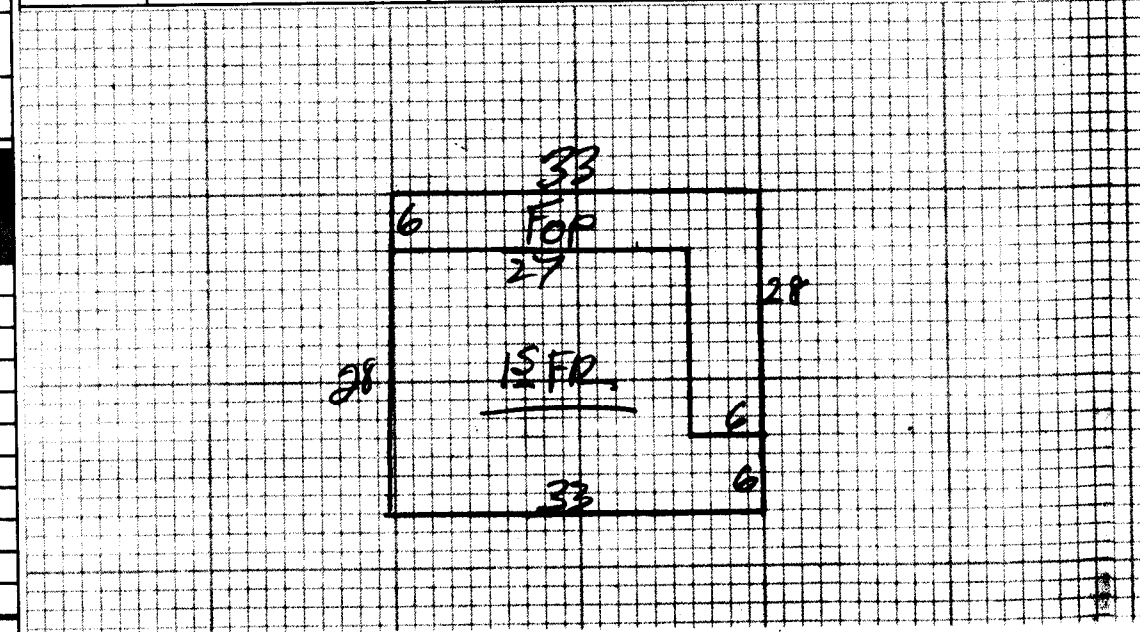

Dwelling <input checked="" type="checkbox"/>	Comp. Sh.	Wood Siding <input checked="" type="checkbox"/>	Yr. <del>1900</del>	Remod.	Bemt. [ ] 2nd [ ]	Plaster	BATHS) Full <input type="checkbox"/> 1/2 Bath(s) <input type="checkbox"/>
	State	Brick	No. Stories	1	1st 5 3rd [ ]	Sheet rock <input checked="" type="checkbox"/>	Modern Bath <input type="checkbox"/> Modern Kitchen <input type="checkbox"/>
	Asbestos	Asb. Wood Shg.	B. Level <input type="checkbox"/> S. Poyer <input type="checkbox"/>	Total No. Bedrooms		Ceclied	Cent. Heat <i>None</i> A/C <input type="checkbox"/>
	Metal <input checked="" type="checkbox"/>	Cin. Block <input type="checkbox"/> Stone <input type="checkbox"/>				Panel <input checked="" type="checkbox"/>	Flr. or Wall Furnace <input type="checkbox"/> Stoves <input type="checkbox"/>
Wood Frame <input checked="" type="checkbox"/>	Tar & Grav.	Stucco <input type="checkbox"/> Con. Block <input type="checkbox"/>	Crawl <input type="checkbox"/> Conc. <input type="checkbox"/>	HW <input type="checkbox"/> Pine <input checked="" type="checkbox"/> Carp. <input type="checkbox"/> Tile <input type="checkbox"/>	Unfinished		
Cin. Block	Tile	Aluminum <input type="checkbox"/> Masonite <input type="checkbox"/>	Flors <input type="checkbox"/> Cin. Blk. <input type="checkbox"/>				Number
Steel Frame	Shakes	Storm Doors <input type="checkbox"/> Storm Wnd. <input type="checkbox"/>	Slab <input type="checkbox"/> Brick <input type="checkbox"/>	Disappearing Stairs	Gd. <input type="checkbox"/> Fair <input type="checkbox"/> Poor <input type="checkbox"/> VP <input type="checkbox"/>	Number Chimneys	
			Basement Size <i>No</i>	Attic Floor & Stairs			Brick <input checked="" type="checkbox"/> C. Block [ ]
			Gd. <input type="checkbox"/> Fair <input type="checkbox"/> Poor <input type="checkbox"/> VP <input checked="" type="checkbox"/>	Basmt. Finish	1/4 <input type="checkbox"/> 1/2 <input type="checkbox"/> 3/4 <input type="checkbox"/> Full <input type="checkbox"/>	Attic <input type="checkbox"/> Walls <input type="checkbox"/> Fl. <input type="checkbox"/>	Stone <input type="checkbox"/> Metal <input type="checkbox"/>

1792, 792, 83.5, 26, 532

YR. 91 YR. YR.

Dwelling	<i>2 BATHS</i>	<i>2105. Reop.</i>	<i>25,872</i>	<i>- 80%</i>	<i>7175</i>	<i>600</i>
Porch	<i>230</i>	<i>8</i>	<i>2640</i>			
Porch						
Carport						
Garage						
Cent. A/C						
Basement						
Bemt. Finish						
Attic						
Fireplace(s)	<i>2000</i>					
Heating						
Bath(s)						

M & L	M & L	Market Value All Improvements	<i>5800</i>
DATE	DATE <i>3-91</i>	Market Value All Land	<i>28,600</i>
APRP.	APRP <i>MM</i>		<i>34,400</i>
DATE	DATE	Owner	
		Make	Year
		Size	Cond.
		Not Home <input type="checkbox"/> Time	
		AM <input type="checkbox"/> PM <input type="checkbox"/>	
CLASSIFICATION	ZONING	Agric.	
<i>5</i>		Hort.	
		Forest	
		Open Space	
		Totals	

Total *31,172*

Factor *83*

Replacement *25,872*

CLASSIFICATION	ACRES	RATE	ADJ.	CLASSIFICATION	ACRES	RATE	ADJ.
Home Site	<i>2</i>			Home Site			
<i>1000 foot</i>	<i>64</i>	<i>400</i>	<i>3000</i>				
			<i>25,600</i>				
Wasteland				Wasteland			
	<i>66</i>		<i>28,600</i>				

General Remarks:

LEVEL  SLOPES UP  SLOPES DOWN

LOW  STEEP UP  STEEP DOWN

BOARD REVIEW NOTES