

RECORD OF OWNERSHIP

BEVERLY BOBBY & DONALD  
 C/O BOB BEVERLY  
 7402 BEVERLY ST.  
 ANNANDALE VA 23003

09361

DATE RECORDED  
 DEED OR WILL BOOK 125-310  
 CONSIDERATION YR-SE

DATE RECORDED  
 DEED OR WILL BOOK  
 CONSIDERATION

DATE RECORDED  
 DEED OR WILL BOOK  
 CONSIDERATION

DATE RECORDED  
 DEED OR WILL BOOK  
 CONSIDERATION

DATE RECORDED  
 DEED OR WILL BOOK  
 CONSIDERATION

BUILDING PERMITS



NOTES:

CLASS 2  
 ZONING  
 DISTRICT 05

LEGAL DESCRIPTION

GEORGES FORK  
 .25AC \*\*\*

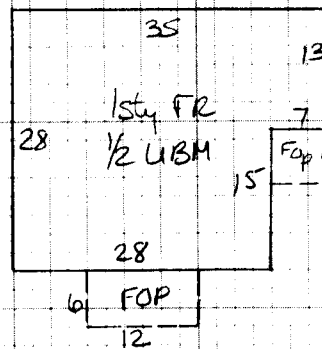
1986	4000	22600	26600
1987	4000	22600	26600
1988	4000	22,600	26,600
1989	4000	22,600	26,600
1990	4000	22600	26,600
1991	4000	22600	26,600
1992			
1993			
1994			
1995			
1996			
1997			



Dwelling <input checked="" type="checkbox"/>	Comp. Sh. <input checked="" type="checkbox"/>	Wood Siding	Yr. Built 48	Remod. <input type="checkbox"/>	Bsmt. [ ] 2nd [ ]	Plaster	BATH(S) / Full <input type="checkbox"/> 1/2 Bath(s) <input type="checkbox"/>
Slate		Brick	No. Stories 1	1st [x] 3rd [ ]	Sheet rock	Modern Bath <input type="checkbox"/> Modern Kitchen <input type="checkbox"/>	
Asbestos		Asb. Wood Shg.	S. Level <input type="checkbox"/> S. Foyer <input type="checkbox"/>	Total No. Bedrooms 2	Ceciled	Cent. Heat elec A/C	
Metal		Cin. Block <input type="checkbox"/> Stone <input type="checkbox"/>			Panel	Fir. or Wall Furnace <input type="checkbox"/> Stove(s) <input type="checkbox"/>	
Wood Frame <input checked="" type="checkbox"/>	Tar & Grav.	Stucco <input type="checkbox"/> Con. Block <input type="checkbox"/>	Crawl <input type="checkbox"/> Conc. <input type="checkbox"/>	HW <input checked="" type="checkbox"/> Pine <input type="checkbox"/> Carp. <input type="checkbox"/> Tile <input type="checkbox"/>	Unfinished		
Cin. Block	Tile	Aluminum <input checked="" type="checkbox"/> Masonite <input type="checkbox"/>	Riers <input type="checkbox"/> Cin. Bk. <input checked="" type="checkbox"/>				Number NO
Steel Frame	Shakes	Storm Doors <input type="checkbox"/> Storm Win. <input type="checkbox"/>	Slab <input type="checkbox"/> Brick <input type="checkbox"/>	Disappearing Stairs	Gd. <input type="checkbox"/> Fair <input type="checkbox"/> Poor <input type="checkbox"/> VP <input type="checkbox"/>		Number Chimneys
		Basement Size 1/2	Basmt. Finish	Attic Floor & Stairs	Brick [ ] C. Block [ ]		
		Gd. <input checked="" type="checkbox"/> Fair <input type="checkbox"/> Poor <input type="checkbox"/> VP <input type="checkbox"/>	Basmt. Finish	1/4 <input type="checkbox"/> 1/2 <input type="checkbox"/> 3/4 <input type="checkbox"/> Full <input type="checkbox"/>	Attic <input type="checkbox"/> Walls <input type="checkbox"/> Fl. <input type="checkbox"/>		Stone [ ] Metal [ ]

1sty 875 315 27562

YR. 86 YR.

Dwelling		D+	28206	20%	22565
Porch 0	114	8	912		
Porch					
Carport					
Garage					
Cent. A/C					

Basement 437 5 2185

Bsmt. Finish

Attic

Fireplace(s)

Heating

Bath(s)

Total 30659

Factor .92

Replacement 28206

M & L	M & L
DATE	DATE
APRP. LF	APRP.
DATE 6-4-85	DATE
CLASSIFICATION 2	ZONING

MOBILE HOME INFORMATION		Market Value All Improvements 22600
Owner		Market Value All Land 4000
Make	Year	26000
Size	Cond.	
Not Home <input type="checkbox"/>	Time	
AM <input checked="" type="checkbox"/> PM <input type="checkbox"/>		
INFORMATION BY		
Agric.		
Hort.		
Forest		
Open Space		
Totals		

Property and Location Information	
Land Cost	
Bldg. Cost	
Sale Price	
Rent	
Expenses	
Net Rent	

FRONTAGE TOPOGRAPHY				LAND VALUE COMPUTATION				LAND VALUE COMPUTATION				
PROPERTY FACTORS	CLASSIFICATION	ACRES	RATE	ADJ.	CLASSIFICATION	ACRES	RATE	ADJ.	CLASSIFICATION	ACRES	RATE	ADJ.
Public Water <input checked="" type="checkbox"/> Paved	Home Site	.25			Home Site		4000		Home Site			
Public Sewer <input type="checkbox"/> Gravel												
Well <input type="checkbox"/> Dirt												
Spring <input type="checkbox"/> No Road <input checked="" type="checkbox"/>												
Septic System <input type="checkbox"/> Curb & Gutter	Wasteland				Wasteland							
U. G. Utilities <input type="checkbox"/> Sidewalk		.25					4000					

General Remarks:

LEVEL  SLOPES UP  SLOPES DOWN

LOW  STEEP UP  STEEP DOWN

PRIVATE Rd

BOARD REVIEW NOTES