

RECORD OF OWNERSHIP

YATES JOHNNY & CAROLYN
 BOX 387
 HAYSI VA 24256

DATE RECORDED 5/96
 DEED OR WILL BOOK 177-057
 CONSID-ERATION YR-SP

CLASS 2
 ZONING
 DISTRICT 04

LEGAL DESCRIPTION
 LAZARUS BRANCH
 1.38AC ***

09238

DATE RECORDED	
DEED OR WILL BOOK	
CONSID-ERATION	
DATE RECORDED	
DEED OR WILL BOOK	
CONSID-ERATION	
DATE RECORDED	
DEED OR WILL BOOK	
CONSID-ERATION	
DATE RECORDED	
DEED OR WILL BOOK	
CONSID-ERATION	

1986	2,000	61,900	63,900
1987	2000	61900	63900
1988	2000	61900	63900
1989	2000	61900	63900
1990	2000	61900	63900
1991	2000	61900	63900
1992			
1993			
1994			
1995			
1996			
1997			

BUILDING PERMITS

NOTES:

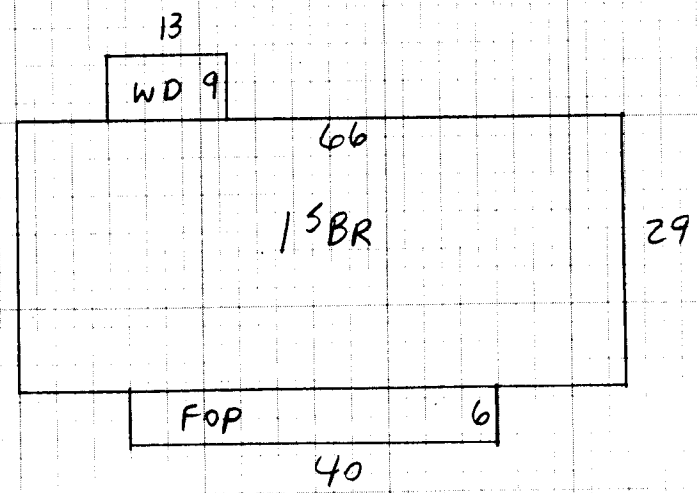

NOTES	Dwelling	<input checked="" type="checkbox"/>	Comp. Sh.	<input checked="" type="checkbox"/>	Wood Siding		Yr. Built 85	Remod.		Bsmt. []	2nd []	Plaster		BATH(S) / Full	1/2 Bath(s)		
			Slate		Brick	<input checked="" type="checkbox"/>	No. Stories	1	1st 16	3rd []	Sheet rock		Modern Bath <input type="checkbox"/>	Modern Kitchen <input type="checkbox"/>			
			Asbestos		Asb. Wood Shg.		S. Level <input type="checkbox"/>	S. Foyer <input type="checkbox"/>	Total No. Bedrooms		Ceciled		Cent. Heat COAL	AC NO			
	CONSTRUCTION		Metal		Cin. Block <input type="checkbox"/>	Stone <input type="checkbox"/>	FOUNDATION		FLOORING		Panel	<input checked="" type="checkbox"/>	Fir. or Wall Furnace <input type="checkbox"/>	Stove(s) <input type="checkbox"/>			
	Wood Frame	<input checked="" type="checkbox"/>	Tar & Grav.		Stucco <input type="checkbox"/>	Con. Block <input type="checkbox"/>	Crawl <input type="checkbox"/>	Conc. <input type="checkbox"/>	HW <input type="checkbox"/>	Pine <input type="checkbox"/>	Carp. <input type="checkbox"/>	Tile <input type="checkbox"/>	Unfinished				
Cin. Block		Tile		Aluminum <input type="checkbox"/>	Masonite <input type="checkbox"/>	Riers <input type="checkbox"/>	Cin. Blk. <input checked="" type="checkbox"/>	ATTIC FINISH		FLOORING		FIREPLACES					
Steel Frame		Shakes		Storm Doors <input type="checkbox"/>	Storm Win. <input type="checkbox"/>	Slab <input type="checkbox"/>	Brick <input checked="" type="checkbox"/>	Disappearing Stairs		Gd. <input checked="" type="checkbox"/>	Fair <input type="checkbox"/>	Poor <input type="checkbox"/>	VP <input type="checkbox"/>	Number	1		
COMPLETION				Basement Size NO		Attic Floor & Stairs		Number				Number Chimneys		1			
				Basmt. Finish		Basmt. Finish		Attic <input type="checkbox"/>		Walls <input type="checkbox"/>		Fl. <input type="checkbox"/>		Brick [4]		C. Block []	
				Gd. <input checked="" type="checkbox"/>		Fair <input type="checkbox"/>		Poor <input type="checkbox"/>		VP <input type="checkbox"/>		Stone []		Metal []			

1782	1914	30.5	58,377															
SUMMARY OF BUILDING																		
Dwelling																		
C																		
63,141																		
-2%																		
61,878																		
Porch	240	10	2400															
Booth	WD	91	4	364														
Carport																		
Garage																		
Cent. A/C																		

Basement		M & L	M & L	MOBILE HOME INFORMATION		Market Value All Improvements		61,878	
Bsmt. Finish		DATE	DATE	Owner		Market Value All Land		2,000	
Attic		APRP.	APRP.	Make	Year	Market Value		63,878	
Fireplace(s)	2000	DATE	DATE	Size	Cond.	USE VALUE APPRAISALS RECAP			
Heating		DATE	DATE	Not Home <input type="checkbox"/>	Time	Agriculture			
Bath(s)		CLASSIFICATION	ZONING	INFORMATION BY		Forest			
Total	63,141	5/29/85	2			Open Space			
Factor	1.0					Totals			
Replacement	63,141								

FRONTS ON																		
LAND VALUE COMPUTATIONS																		
LAND VALUE COMPUTATIONS																		

PROPERTY FACTORS		CLASSIFICATION	ACRES	RATE	ADJ.	CLASSIFICATION	ACRES	RATE	ADJ.
Public Water	<input checked="" type="checkbox"/> Paved	Home Site	1.38			Home Site		2,000	
Public Sewer	Gravel								
Well	Dirt								
Spring	No Road								
Septic System	<input checked="" type="checkbox"/> Curb & Gutter	Wasteland				Wasteland			
U. G. Utilities	Sidewalk								

FRONTAGE TOPOGRAPHY		General Remarks:	
LEVEL <input type="checkbox"/>	SLOPES UP <input type="checkbox"/>	PRIVATE RD	
LOW <input type="checkbox"/>	STEEP UP <input type="checkbox"/>		
	STEEP DOWN <input type="checkbox"/>		

Property and Lease Information		
Land Cost		
\$		
Bldg. Cost		
\$		
Sale Price		
\$		
Rent		
\$		
Expenses		
\$		
Net Rent		
\$		
BOARD REVIEW NOTES		