

RECORD OF OWNERSHIP

YATES BEVERLY F LOUISA  
 RT 2 BOX 53-B 64  
 HAYSI, VA 24256

DATE RECORDED 3/22/95  
 DEED OR WILL BOOK 84-26  
 CONSID-ERATION YR-SP

09209

CLASS 2  
 ZONING  
 DISTRICT 04  
 LEGAL DESCRIPTION PRATER CREEK 1.387 AC \*\*\*

|                   |  |
|-------------------|--|
| DATE RECORDED     |  |
| DEED OR WILL BOOK |  |
| CONSID-ERATION    |  |
| DATE RECORDED     |  |
| DEED OR WILL BOOK |  |
| CONSID-ERATION    |  |
| DATE RECORDED     |  |
| DEED OR WILL BOOK |  |
| CONSID-ERATION    |  |
| DATE RECORDED     |  |
| DEED OR WILL BOOK |  |
| CONSID-ERATION    |  |

|      |       |        |        |
|------|-------|--------|--------|
| 1986 | 7,000 | 50,600 | 57,600 |
| 1987 | 7,000 | 50,600 | 57,600 |
| 1988 | 7,000 | 50,600 | 57,600 |
| 1989 | 7,000 | 50,600 | 57,600 |
| 1990 | 7,000 | 50,600 | 57,600 |
| 1991 | 7,000 | 50,600 | 57,600 |
| 1992 |       |        |        |
| 1993 |       |        |        |
| 1994 |       |        |        |
| 1995 |       |        |        |
| 1996 |       |        |        |
| 1997 |       |        |        |

BUILDING PERMITS

|  |  |  |  |  |  |
|--|--|--|--|--|--|
|  |  |  |  |  |  |
|  |  |  |  |  |  |
|  |  |  |  |  |  |
|  |  |  |  |  |  |

NOTES:

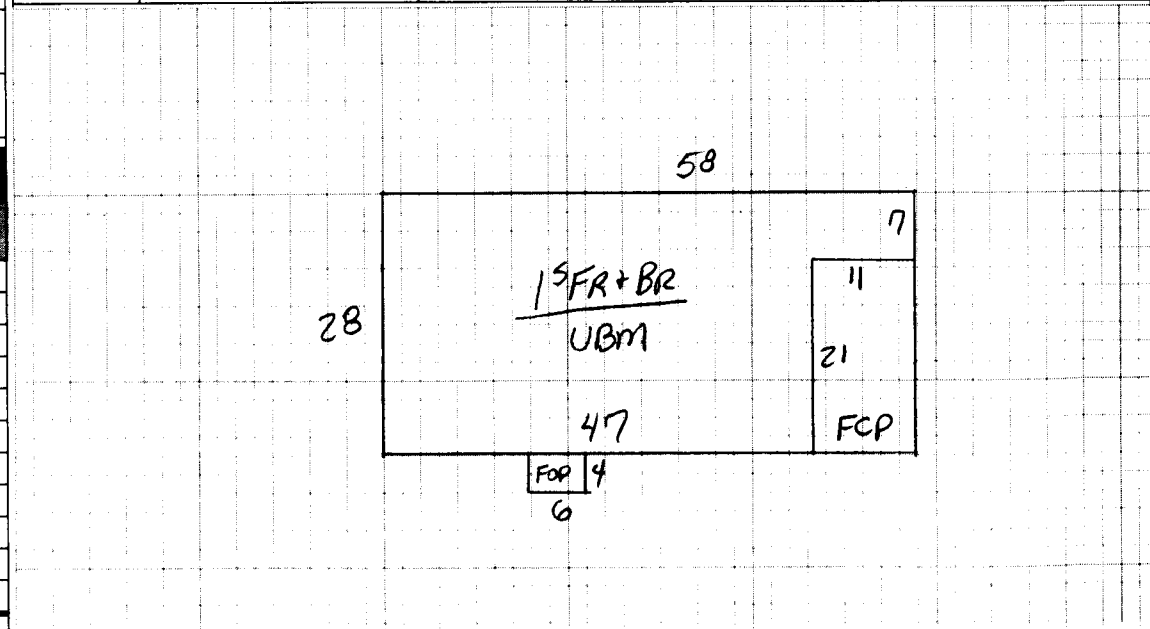

|  |  |  |  |  |   |                                     |   |
|--|--|--|--|--|---|-------------------------------------|---|
| NOTES  | MAIN BUILDING                                | ROOFING  | EXTERIOR FINISH  | GENERAL FEATURES   | FORMER ROOFS  | INTERIOR FINISH                     | PLUMBING & HEATING  |
|  | Dwelling <input checked="" type="checkbox"/> | Comp. Sh. <input checked="" type="checkbox"/>                            | Wood Siding <input checked="" type="checkbox"/>                              | Yr. Built 62 Remod. <input type="checkbox"/>   | Bemt. [ ] 2nd [ ]   | Plaster <input type="checkbox"/>    | BATH(S) / Full <input type="checkbox"/> 1/2 Bath(s) <input type="checkbox"/>    |
|  |  | Slate <input type="checkbox"/>   | Brick <input checked="" type="checkbox"/>                                    | No. Stories 1  | 1st 5 3rd [ ]   | Sheet rock <input type="checkbox"/> | Modern Bath <input type="checkbox"/> Modern Kitchen <input type="checkbox"/>    |
|  |  | Asbestos <input type="checkbox"/>  | Asb. Wood Shg. <input type="checkbox"/>                                      | S. Level <input type="checkbox"/> S. Foyer <input type="checkbox"/>  | Total No. Bedrooms  | Ceciled <input type="checkbox"/>    | Cent. Heat OIL A/C NO   |
| CONSTRUCTION                                   | Metal <input type="checkbox"/>               | Cin. Block <input type="checkbox"/> Stone <input type="checkbox"/>       | FOUNDATION   |  |   | Panel <input type="checkbox"/>      | Fir. or Wall Furnace <input type="checkbox"/> Stove(s) <input type="checkbox"/> |
| Wood Frame <input checked="" type="checkbox"/> | Tar & Grav. <input type="checkbox"/>         | Stucco <input type="checkbox"/> Con. Block <input type="checkbox"/>      | Crawl <input type="checkbox"/> Conc. <input type="checkbox"/>                | HW <input type="checkbox"/> Pine <input type="checkbox"/> Carp. <input checked="" type="checkbox"/> Tile <input checked="" type="checkbox"/> | Unfinished <input type="checkbox"/>   |                                     |   |
| Cin. Block <input type="checkbox"/>            | Tile <input type="checkbox"/>                | Aluminum <input type="checkbox"/> Masonite <input type="checkbox"/>      | Riers <input type="checkbox"/> Cin. Blk. <input checked="" type="checkbox"/> |  |   |                                     |   |
| Steel Frame <input type="checkbox"/>           | Shakes <input type="checkbox"/>              | Storm Doors <input type="checkbox"/> Storm Win. <input type="checkbox"/> | Slab <input type="checkbox"/> Brick <input checked="" type="checkbox"/>      | Disappearing Stairs <input type="checkbox"/>   | Gd. <input type="checkbox"/> Fair <input checked="" type="checkbox"/> Poor <input type="checkbox"/> VP <input type="checkbox"/> |                                     |   |

|             |      |                    |        |   |  |                      |  |  |                     |
|-------------|------|--------------------|--------|---|--|----------------------|--|--|---------------------|
| COMPLETIONS |      | EXTERIOR CONDITION |        | FOUNDATION  |  | INTERIOR CONDITION   |  | FIREPLACES   |                     |
| 15FR        | 1393 | 30                 | 41,790 | Gd. <input type="checkbox"/> Fair <input checked="" type="checkbox"/> Poor <input type="checkbox"/> VP <input type="checkbox"/> | Basmt. Size 100%   | Attic Floor & Stairs | Attic <input type="checkbox"/> Walls <input type="checkbox"/> Fl. <input type="checkbox"/> | Number   | Number Chimneys     |
|             |      |                    |        | Basmt. Finish   | 1/4 <input type="checkbox"/> 1/2 <input type="checkbox"/> 3/4 <input type="checkbox"/> Full <input type="checkbox"/> |                      |  | Brick <input checked="" type="checkbox"/> C. Block [ ] | Stone [ ] Metal [ ] |

|                      |      |   |      |           |       |        |        |      |        |
|----------------------|------|---|------|-----------|-------|--------|--------|------|--------|
| SUMMARY OF BUILDINGS |      |   |      | YR.       | 96    | YR.    |        | YR.  |        |
| Dwelling             |      |   | D+   | 48,571    | -20%  | 38,057 |        |      |        |
| Porch                | 24   | 8 | 192  | 15FR HSE. | 24x29 | D-     | 19,629 | -40% | 11,776 |
| Porch                |      |   |      |           |       |        |        |      |        |
| Carport              | 231  | 8 | 1848 |           |       |        |        |      |        |
| Garage               |      |   |      |           |       |        |        |      |        |
| Cent. A/C            |      |   |      |           |       |        |        |      |        |
| Basement             | 1393 | 5 | 6965 |           |       |        |        |      |        |

|                |        |  |                               |        |
|----------------|--------|--|-------------------------------|--------|
| M & L          | M & L  | MOBILE HOME INFORMATION  | Market Value All Improvements | 50,633 |
| DATE           | DATE   | Owner  | Market Value All Land         | 7,000  |
| APRP.          | APRP.  | Make   | Year                          | 57,633 |
| DATE           | DATE   | Size   | Cond.                         |        |
| 9/13/85        |        | Not Home <input type="checkbox"/> Time                             |                               |        |
| CLASSIFICATION | ZONING | AM <input type="checkbox"/> PM <input checked="" type="checkbox"/> | USE VALUE APPRAISAL RECAP     |        |
| 2              |        |  | Agric.                        |        |
|                |        |  | Hort.                         |        |
|                |        |  | Forest                        |        |
|                |        |  | Open Space                    |        |
|                |        |  | Totals                        |        |

|           |                         |  |  |  |                         |  |  |  |                                 |
|-----------|-------------------------|--|--|--|-------------------------|--|--|--|---------------------------------|
| FRONTS ON | LAND VALUE COMPUTATIONS |  |  |  | LAND VALUE COMPUTATIONS |  |  |  | Property and Income Information |
|           |                         |  |  |  |                         |  |  |  | Land Cost                       |
|           |                         |  |  |  |                         |  |  |  | \$                              |
|           |                         |  |  |  |                         |  |  |  | Bldg. Cost                      |
|           |                         |  |  |  |                         |  |  |  | \$                              |
|           |                         |  |  |  |                         |  |  |  | Sale Price                      |
|           |                         |  |  |  |                         |  |  |  | \$                              |
|           |                         |  |  |  |                         |  |  |  | Rent                            |
|           |                         |  |  |  |                         |  |  |  | \$                              |
|           |                         |  |  |  |                         |  |  |  | Expenses                        |
|           |                         |  |  |  |                         |  |  |  | \$                              |
|           |                         |  |  |  |                         |  |  |  | Net Rent                        |
|           |                         |  |  |  |                         |  |  |  | \$                              |

|                  |               |                |       |      |      |                |       |       |      |
|------------------|---------------|----------------|-------|------|------|----------------|-------|-------|------|
| PROPERTY FACTORS |               | CLASSIFICATION | ACRES | RATE | ADJ. | CLASSIFICATION | ACRES | RATE  | ADJ. |
| Public Water     | Paved         | Home Site      | 1.387 |      |      | Home Site      |       | 7,000 |      |
| Public Sewer     | Gravel        |                |       |      |      |                |       |       |      |
| Well             | Dirt          |                |       |      |      |                |       |       |      |
| Spring           | No Road       |                |       |      |      |                |       |       |      |
| Septic System    | Curb & Gutter | Wasteland      |       |      |      | Wasteland      |       |       |      |
| U. G. Utilities  | Sidewalk      |                |       |      |      |                |       |       |      |

|                                |   |                  |  |
|--------------------------------|---|------------------|--|
| FRONTAGE TOPOGRAPHY            |   | General Remarks: |  |
| LEVEL <input type="checkbox"/> | SLOPES UP <input type="checkbox"/> SLOPES DOWN <input type="checkbox"/> |                  |  |
| LOW <input type="checkbox"/>   | STEEP UP <input type="checkbox"/> STEEP DOWN <input type="checkbox"/>   |                  |  |

BOARD REVIEW NOTES