

EDWARDS PALMER C
 RT 2 BOX 728
 MAYS VA

24256

DEED OR WILL BOOK	DB 0122 0502
CONSIDERATION	
DATE RECORDED	
DEED OR WILL BOOK	
CONSIDERATION	
DATE RECORDED	
DEED OR WILL BOOK	
CONSIDERATION	
DATE RECORDED	
DEED OR WILL BOOK	
CONSIDERATION	
DATE RECORDED	
DEED OR WILL BOOK	
CONSIDERATION	

CLASS	2	LEGAL DESCRIPTION	RUSSELL FORK 10.50AC
ZONING			
DISTRICT	04		

1992			
1993			
1994	9,000	24,700	33,700
1995	9,000	24,700	33,700
1996			
1997			
1998			
1999			
2000			
2001			
2002			
2003			

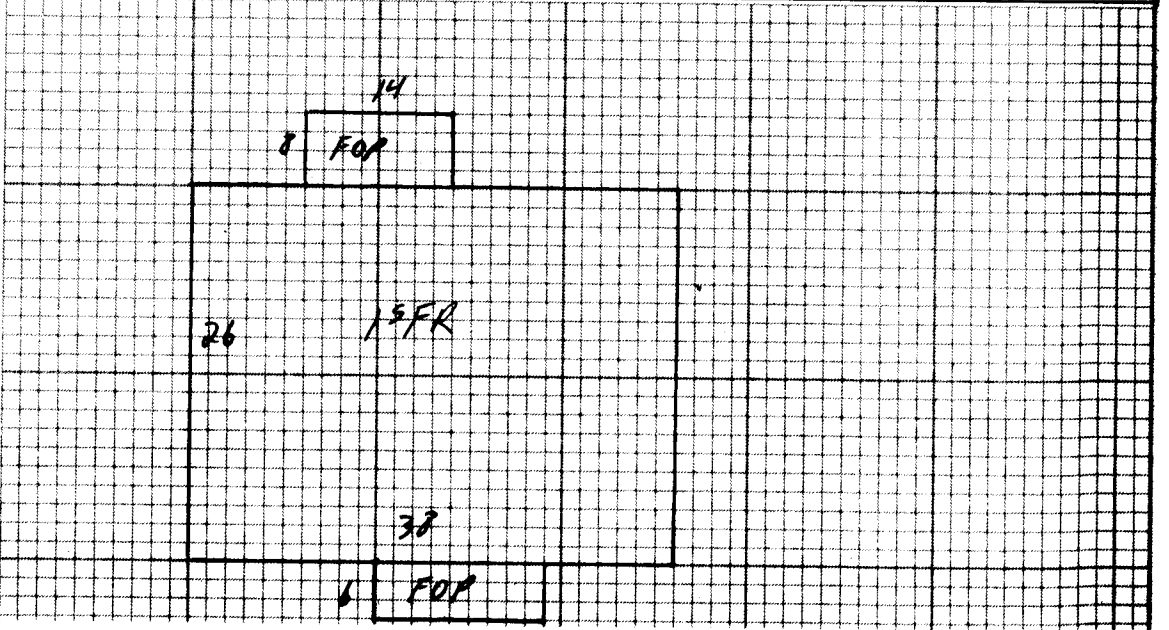

NOTES:

Dwelling	Comp. Sh.	Wood Siding	Yr. Built 70	Remod.	Basmt. [] 2nd []	Plaster	BATH(S) / Full 1/2 Bath(s)
	Slate	Brick	No. Stories		1st [6] 3rd []	Sheet rock	Modern Bath [] Modern Kitchen []
	Asbestos	Awb. Wood Shg.	S. Level [] S. Fever []		Total No. Bedrooms	Ceiled	Cent. Heat oil/gas/NG 70
	Metal	Cin. Block [] Stone []	Crawl [] Conc. []		MS [] Pine [] Cem. [] Tile []	Panel	Flr. or Wall Furnace [] Stove(s) []
Wood Frame	Tar & Grav.	Stucco [] Con. Block []	Fiers [] Cin. Blk. []		Disappearing Stairs	Unfinished	Number 70
Cin. Block	Tile	Aluminum [] Masonite []	Slab [] Brick []		Attic Floor & Stairs	Gd. [] Fair [] Poor [] VP []	Number Chimneys
Steel Frame	Shakes	Storm Doors [] Storm Win. []	Basement Size 70		Attic [] Walls [] Fl. []	Brick [] C. Block []	Stone [] Metal []
			Basmt. Finish		1/4 [] 1/2 [] 3/4 [] Full []	YR. 94	YR.

Dwelling	D	30775	23%	23081
				FV 700
				FV 1440

(2) FT. MISC Bldgs
TR#2 8X22 12X18 Addition

M & L	M & L	Market Value All Improvements	24,700
DATE	DATE	Market Value All Land	9,000
APRP. NC	APRP.		33,700
DATE 2/22/94	DATE	Owned Jimmy Hicks	
CLASSIFICATION 2	ZONING	Made Vanessa Year 73	
		Size 12X60 Cond.	
		Not Home [] Time	
		AM [] PM []	
		Agric.	
		Hort.	
		Forest	
		Open Space	
		Totals	

Land Cost	\$
Bldg. Cost	\$
Sale Price	\$
Rent	\$
Expenses	\$
Net Rent	\$

CLASSIFICATION	ACRES	RATE	ADJ.	CLASSIFICATION	ACRES	RATE	ADJ.
Home Site	2	6000		Home Site			
	8.5	2975					
Westland	10.5	9000		Westland			

Public Water	Paved
Public Sewer	Gravel
Well	Dirt
Spring	No Road
	Curb & Gutter
	Sidewalk

BOARD REVIEW NOTES