

~~MEMBERGASS HELEN G ETALS~~
~~RT 1 BOX 259~~
~~NORA VA~~

24272

DATE RECORDED 8-24-93
 DEED OR WILL BOOK DB 0022 0567
 CONSIDERATION will

~~McCowan Linda Darrell~~
~~RT 1 Box 259~~
~~Nora, VA 24272~~

DATE RECORDED 4-1-94
 DEED OR WILL BOOK 299-314
 CONSIDERATION 13,000

McCowan, Linda Kay Hartscock
 Rt. 1 Box 259
 Nora, VA 24272

DATE RECORDED 5-14-99
 DEED OR WILL BOOK 345,567
 CONSIDERATION —

DATE RECORDED
 DEED OR WILL BOOK
 CONSIDERATION

CLASS 2
 ZONING
 DISTRICT 03

LEGAL DESCRIPTION
 SANDY RIDGE
 5.28AC
 178-170C (A) 1756

1992			
1993			
1994	5,500	12,500	18,000
1995	5,500	12,500	18,000
1996			
1997			
1998	5,500	12,500	18,000
1999			
2000			
2001			
2002			
2003			

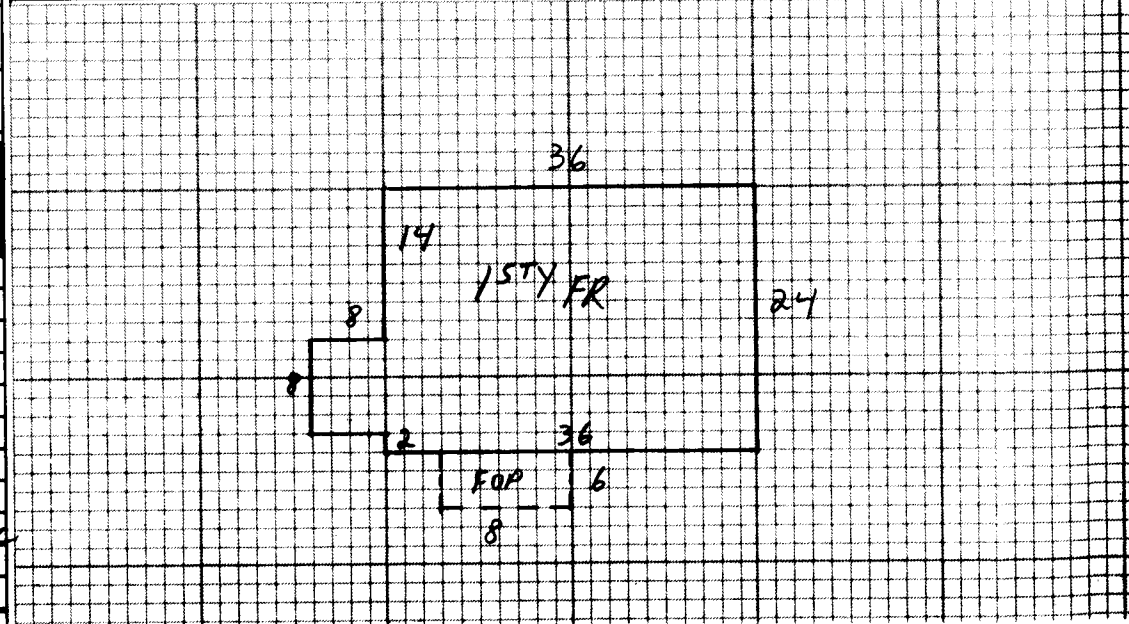

NOTES:

DARRELL REQUESTED CHANGE 6-297
 DARRELL REQUESTED CHANGE IN ADDRESS 8-21-98
 Address change requested by Linda McCowan
 5/11/99

Dwelling	<input checked="" type="checkbox"/>	Comp. Sh.	Wood Siding	Yr. Built 53	Remod.	Bemt. () 2nd ()	Plester	BATHS / Full 1/2 Baths)
		Stone	Brick	No. Stories		1st () 3rd ()	Sheet rock	Modern Bath <input type="checkbox"/> Modern Kitchen <input type="checkbox"/>
		Asbestos	Asb. Wood Shg.	S. Level <input type="checkbox"/> S. Foyer <input type="checkbox"/>	Total No. Bedrooms		Ceiled	Cent. Heat COAL / A/C
		Metal	Cin. Block <input type="checkbox"/> Stone <input type="checkbox"/>				Panel	Fir. or Wall Furnace <input type="checkbox"/> Stove(s) <input type="checkbox"/>
Wood Frame	<input checked="" type="checkbox"/>	Tar & Grav.	Stucco <input type="checkbox"/> Con. Block <input type="checkbox"/>	Crawl <input type="checkbox"/> Conc. <input type="checkbox"/>	NW <input type="checkbox"/> Plac <input type="checkbox"/> Carp. <input type="checkbox"/> Tile <input type="checkbox"/>		Unfinished	
Cin. Block		Tile	Aluminum <input checked="" type="checkbox"/> Masonite <input type="checkbox"/>	Fiers <input type="checkbox"/> Cin. Blk. <input type="checkbox"/>				Number NO
Steel Frame		Shakes	Storm Doors <input type="checkbox"/> Storm Win. <input type="checkbox"/>	Slab <input type="checkbox"/> Brick <input type="checkbox"/>	Disappearing Stairs		Gd. <input type="checkbox"/> Fair <input type="checkbox"/> Poor <input checked="" type="checkbox"/> VP <input type="checkbox"/>	Number Chimneys

Basement Size	Attic Floor & Stairs	Brick () C. Block ()
Gd. <input type="checkbox"/> Fair <input type="checkbox"/> Poor <input type="checkbox"/> VP <input type="checkbox"/>	Basmt. Finish	Stone () Metal ()
1st y 928 29 26 912		
		YR. 94

		Dwelling		D-	22 655	45%	12 460		
			Misc Bldg	8x10			NV		
Porch 0	48	8	384						
Porch									
Carport									
Garage									
Cent. A/C									
Basement									

Basmt. Finish	M & L	M & L	Market Value All Improvements	12 500
Attic	DATE	DATE	Market Value All Land	5 500
Fireplace(s)	APRP. KSK	APRP.	Size	Cond.
Heating	DATE 1-13-94	DATE	Not Home <input checked="" type="checkbox"/> Time	
Bath(s)	CLASSIFICATION 2	ZONING	Agric.	
Total	27 296		Hort.	
Factor	.83		Forest	
Replacement	22 655		Open Space	
			Totals	
			Land Cost	
			\$	
			Bldg. Cost	
			\$	
			Sale Price	
			\$	
			Rent	
			\$	
			Expenses	
			\$	
			Net Rent	
			\$	

	CLASSIFICATION	ACRES	RATE	ADJ.		CLASSIFICATION	ACRES	RATE	ADJ.	
	Home Site	1			4000	Home Site				1470
Public Water	Paved <input checked="" type="checkbox"/>	wooded	4.28	350						
Public Sewer	Gravel									
Well	Dirt									
Spring	No Road									
Septic System	Curb & Gutter	Wasteland				Wasteland				
U. G. Utilities	Sidewalk		5.28		5500					

General Remarks:

LEVEL SLOPES UP SLOPES DOWN

LOW STEEP UP STEEP DOWN

BOARD REVIEW NOTES

100251411