

MCCLELLAN EARL & SARAH RT 1 BOX 340 ST PAUL VA 24283 SKIDMORE, ELMA FOYCE MCCLELLAN	DATE RECORDED	10-14-94
	DEED OR WILL BOOK	DB 0189 306-194 0574
	CONSIDERATION	16800
SKIDMORE RANDALL + KAREN RT 1 BOX 337A ST PAUL VA 24283	DATE RECORDED	1-3-96
	DEED OR WILL BOOK	314-201
	CONSIDERATION	27900
	DATE RECORDED	
	DEED OR WILL BOOK	
	CONSIDERATION	
	DATE RECORDED	
	DEED OR WILL BOOK	
	CONSIDERATION	
	DATE RECORDED	
	DEED OR WILL BOOK	
	CONSIDERATION	

CLASS	2			LEGAL DESCRIPTION SANDY RIDGE 2.74 AC 3.26 AC 17B-170C (A) 173B
ZONING				
DISTRICT	03			
1992				
1993				
1994	4,900	22,600	27,500	
1995	4,900	22,600	27,500	
1996	5,300	22,600	27,900	
1997				
1998				
1999				
2000				
2001				
2002				
2003				

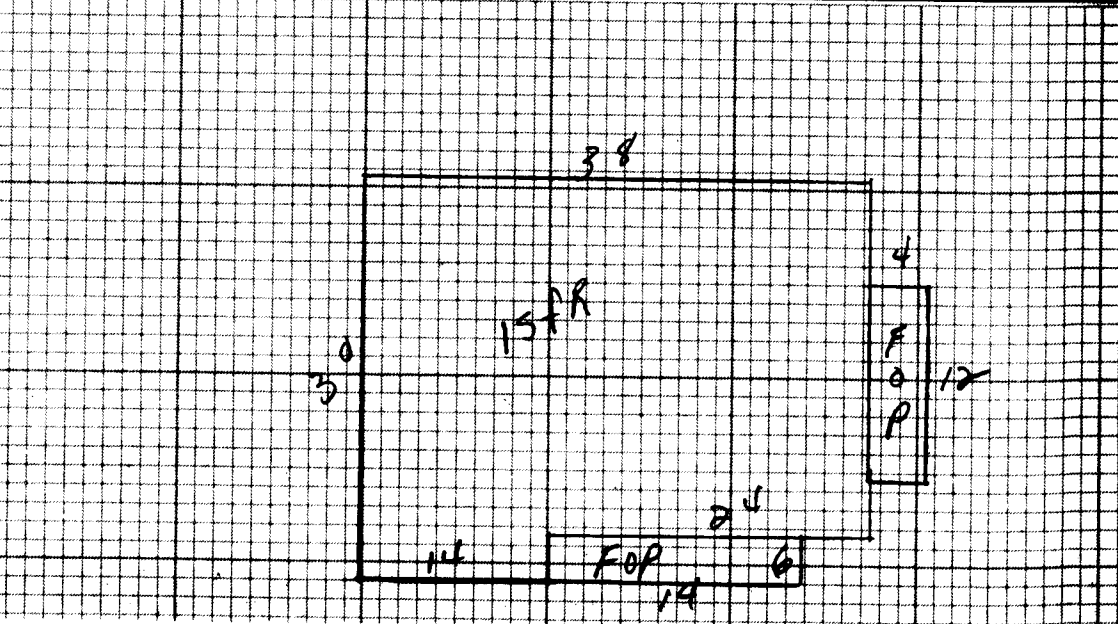

NOTES:
 0.50 AC to Charles B. & Elma Skidmore
 THIS TRACT ADDED BACK 251-724
 TO THIS CARD FROM 17779 DB 314-201

