

KENNEY DISTRICT

00000000004709

HAYES KATHY R RT 1 BOX 311C CLINTWOOD VA 24228	DATE RECORDED	3/25/87
	DEED OR WILL BOOK	DB 0242 0745
	CONSIDERATION	3000
	DATE RECORDED	
	DEED OR WILL BOOK	
	CONSIDERATION	
	DATE RECORDED	
	DEED OR WILL BOOK	
	CONSIDERATION	
	DATE RECORDED	
	DEED OR WILL BOOK	
	CONSIDERATION	
	DATE RECORDED	
	DEED OR WILL BOOK	
	CONSIDERATION	

CLASS	2			LEGAL DESCRIPTION	CANNEY RIDGE .47AC		
ZONING				DISTRICT	03		
1992							
1993							
1994		3,000	34,000		37,000		
1995		3,000	34,000		37,000		
1996							
1997							
1998							
1999							
2000							
2001							
2002							
2003							

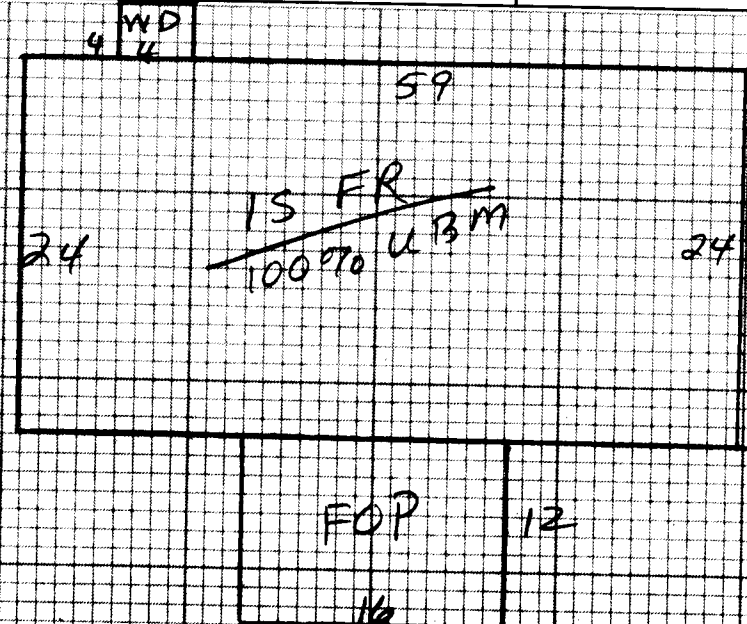

NOTES:

Dwelling	<input checked="" type="checkbox"/>	Comp. Sh.	<input checked="" type="checkbox"/>	Wood Siding	<input checked="" type="checkbox"/>	Yr. Built	79	Remod.		Bmnt.	<input type="checkbox"/>	2nd	<input type="checkbox"/>	Floater		BATHS	2 Full	1/2 Bath(s)			
		Slate		Brick		No. Stories	1			1st	<input checked="" type="checkbox"/>	3rd	<input type="checkbox"/>	Sheet rock		Modern Bath	<input type="checkbox"/>	Modern Kitchen	<input type="checkbox"/>		
		Asbestos		Asb. Wood Shg.		S. Level	<input type="checkbox"/>	S. Foyer	<input type="checkbox"/>	Total No. Bedrooms				Cooled		Cent. Heat	ELEC	A/C	<input checked="" type="checkbox"/>		
		Metal		Cin. Block	<input type="checkbox"/>	Stone	<input type="checkbox"/>							Panel	<input checked="" type="checkbox"/>	Fr. or Wall Furnace	<input type="checkbox"/>	Stove(s)	<input type="checkbox"/>		
Wood Frame	<input checked="" type="checkbox"/>	Tar & Grav.		Stucco	<input type="checkbox"/>	Con. Block	<input type="checkbox"/>	Crawl	<input type="checkbox"/>	Conc.	<input type="checkbox"/>	NW	<input type="checkbox"/>	Pine	<input type="checkbox"/>	Carp.	<input checked="" type="checkbox"/>	Tile	<input type="checkbox"/>	Unfinished	
Cin. Block		Tile		Aluminum	<input checked="" type="checkbox"/>	Masonite	<input type="checkbox"/>	Riers	<input type="checkbox"/>	Cin. Blk.	<input type="checkbox"/>										
Steel Frame		Shakes		Storm Doors	<input type="checkbox"/>	Storm Win.	<input type="checkbox"/>	Slab	<input type="checkbox"/>	Brick	<input type="checkbox"/>	Disappearing Stairs		Gd.	<input type="checkbox"/>	Fair	<input type="checkbox"/>	Poor	<input type="checkbox"/>	VP	<input type="checkbox"/>
								Basement Size	100%			Attic Floor & Stairs									

15FR 1416 29 41064

YR. 1994 YR. YR.

Dwelling																				
Porch	192	8	1536																	
Porch WD	16	7	112																	
Carport																				
Garage																				
Cent. A/C	1416	1	1416																	
Basement	1416	65	9204																	

Dwelling 46398 15% 39439

Conc DWY FV 600

M & L	M & L	Market Value All Improvements	40000-15%	34000
DATE	DATE	Market Value All Land	3500-15%	3000
APPR. 5H	APPR.	Owner	43500	37000
DATE 12/94	DATE	Make		
CLASSIFICATION 2	ZONING	Size		
		Not Home <input type="checkbox"/>		
		Time		
		AM <input type="checkbox"/>		
		PM <input type="checkbox"/>		
		Agric.		
		Hort.		
		Forest		
		Open Space		
		Totals		

Public Water	<input checked="" type="checkbox"/>	Paved	<input checked="" type="checkbox"/>	CLASSIFICATION	ACRES	RATE	ADJ.	CLASSIFICATION	ACRES	RATE	ADJ.
Public Sewer		Gravel		Home Site	.47			Home Site		3500	
Well		Dirt									
Spring		No Road									
Septic System	<input checked="" type="checkbox"/>	Curb & Gutter		Wasteland				Wasteland			
U. G. Utilities		Sidewalk			.47					3500	

General Remarks: BLOCK IN ONE CORNER OF BASEMENT GAVE AWAY AND HAD TO BE REPAIRED, WAS THE ONLY KNOWN DAMAGE SO FAR

BOARD REVIEW NOTES