

KENADY DISTRICT

00000000004665

~~NAME EDWARD LEE~~
~~RT 1 BOX 230~~
~~NORA VA~~

~~24272~~

DATE RECORDED 11-79
 DEED OR WILL BOOK DB 0200 0725
 CONSIDERATION 400.00

Woodruff, Betty & Darvil
 Rt. 1 Box 230
 Nora, VA 24272

DATE RECORDED 9-8-98
 DEED OR WILL BOOK 338,485
 CONSIDERATION 28,100

DATE RECORDED
 DEED OR WILL BOOK
 CONSIDERATION

DATE RECORDED
 DEED OR WILL BOOK
 CONSIDERATION

DATE RECORDED
 DEED OR WILL BOOK
 CONSIDERATION

CLASS 2
 ZONING
 DISTRICT 03

LEGAL DESCRIPTION
 BRUSHY RIDGE
 1.06AC

1992			
1993			
1994	2,500	25,600	28,100
1995	2,500	25,600	28,100
1996			
1997			
1998			
1999			
2000			
2001			
2002			
2003			

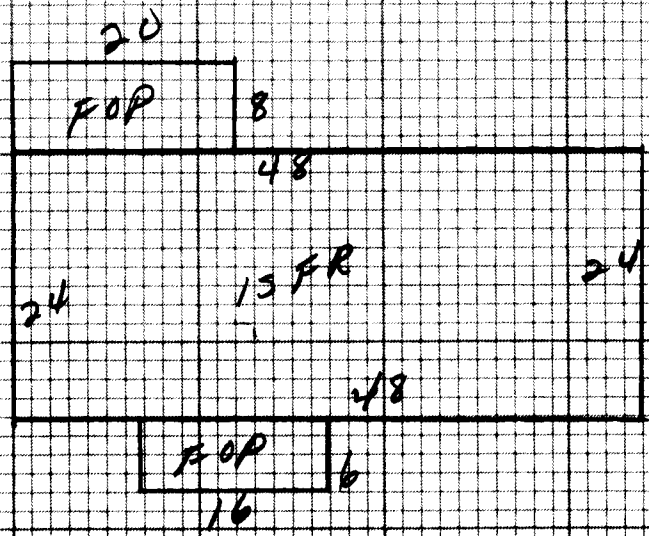

NOTES:

Dwelling	<input checked="" type="checkbox"/>	Comp. Sh.	<input checked="" type="checkbox"/>	Wood Siding		Yr. Built <u>78</u>	Remod.		Bemt. [] 2nd []	Plaster		BATH(S) / Full <input checked="" type="checkbox"/> 1/2 Bath(s)
		Slate		Brick		No. Stories			1st <u>15</u> 3rd []	Sheet rock		Modern Bath <input type="checkbox"/> Modern Kitchen <input type="checkbox"/>
		Asbestos		Aab. Wood Shg.		S. Level <input type="checkbox"/> S. Foyer <input type="checkbox"/>			Total No. Bedrooms	Ceiled		Cent. Heat <u>oil</u> A/C
		Metal		Cin. Block <input type="checkbox"/> Stone <input type="checkbox"/>						Panel	<input checked="" type="checkbox"/>	Flr. or Wall Furnace <input type="checkbox"/> Stove(s) <input type="checkbox"/>
Wood Frame	<input checked="" type="checkbox"/>	Tar & Grav.		Stucco <input type="checkbox"/> Con. Block <input type="checkbox"/>		Crawl <input type="checkbox"/> Conc. <input type="checkbox"/>			HW <input type="checkbox"/> Pine <input type="checkbox"/> Carp. <input type="checkbox"/> Tile <input type="checkbox"/>	Unfinished		
Cin. Block		Tile		Aluminum <input type="checkbox"/> Masonite <input checked="" type="checkbox"/>		Riers <input type="checkbox"/> Cin. Sh. <input checked="" type="checkbox"/>						
Steel Frame		Shakes		Storm Doors <input type="checkbox"/> Storm Win. <input type="checkbox"/>		Slab <input type="checkbox"/> Brick <input type="checkbox"/>			Disappearing Stairs			

1st FR 1152 28 32,256

Basement Size	<u>NO</u>	Attic Floor & Stairs		Ed. <input type="checkbox"/> Fair <input type="checkbox"/> Poor <input checked="" type="checkbox"/> VP <input checked="" type="checkbox"/>	Basmt. Finish	<u>1/4</u> <input type="checkbox"/> <u>1/2</u> <input type="checkbox"/> <u>3/4</u> <input type="checkbox"/> Full <input type="checkbox"/>	Attic <input type="checkbox"/> Walls <input type="checkbox"/> Fl. <input type="checkbox"/>	Stone <input type="checkbox"/> Metal <input type="checkbox"/>	
									YR. <u>94</u>

Dwelling												
Porch	<u>256</u>	<u>8</u>	<u>2048</u>									
Porch												
Carport												
Garage												
Cent. A/C												

Dwelling												

Basement		M & L	M & L			Market Value All Improvements	<u>25600</u>
Basmt. Finish		DATE	DATE	Owner		Market Value All Land	<u>2500</u>
Attic		APPR.	APPR.	Make	Year		<u>28108</u>
Fireplace(s)		<u>M.S.</u>		Size	Cond.		
Heating		DATE	DATE	Not Home <input type="checkbox"/> Time			
Bath(s)		<u>1-21-94</u>		AM <input checked="" type="checkbox"/> PM <input type="checkbox"/>			
		CLASSIFICATION	ZONING				
		<u>2</u>					

Total	<u>34304</u>											
Factor	<u>.87</u>											
Replacement	<u>29844</u>											

Public Water	Paved											
Public Sewer	Gravel	<input checked="" type="checkbox"/>										
Well	Dirt											
Spring	No Road											
Septic System	Curb & Gutter											
U. G. Utilities	Sidewalk											

CLASSIFICATION	ACRES	RATE	ADJ.	CLASSIFICATION	ACRES	RATE	ADJ.
Home Site	<u>1.06</u>			Home Site		<u>2500</u>	
Wasteland				Wasteland		<u>2500</u>	

General Remarks:

LEVEL SLOPES UP SLOPES DOWN

LOW STEEP UP STEEP DOWN

BOARD REVIEW NOTES