

~~24230-11000~~  
~~RT 11000 BOX 533~~  
~~COEBURN VA~~  
 24230

Bond, Baron Neal  
 2996 US 50  
 Batavia, OH 45103

DATE RECORDED  
 DEED OR WILL BOOK  
 CONSIDERATION

DATE RECORDED  
 DEED OR WILL BOOK  
 CONSIDERATION

DATE RECORDED  
 DEED OR WILL BOOK  
 CONSIDERATION

NOTES:

CLASS 2  
 ZONING  
 DISTRICT 03

LEGAL DESCRIPTION  
 SANDY RIDGE  
 3.53AC

1992			
1993			
1994	5,600	10,000	15,600
1995	5,600	10,000	15,600
1996			
1997			
1998			
1999			
2000			
2001			
2002			
2003			

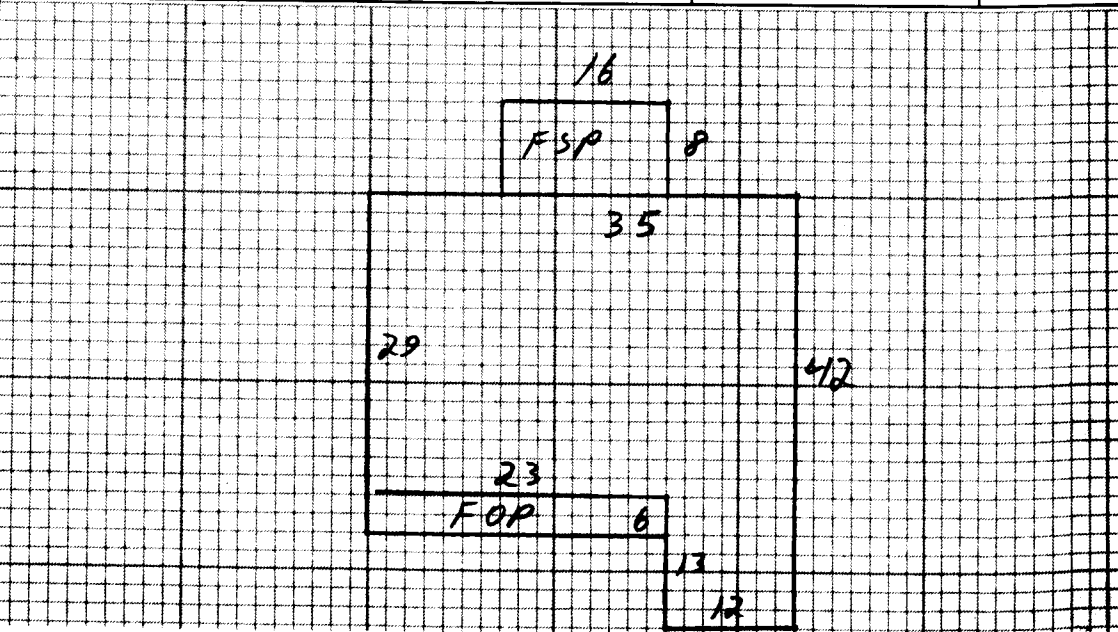

Dwelling	Comp. Sh.	Wood Siding	Yr. Built 28	Basement	Plaster	BATHS 1 Full 1/2 Baths
	Slate	Brick	No. Stories 1	1st	Sheet rock	Modern Bath <input type="checkbox"/> Modern Kitchen <input type="checkbox"/>
	Asbestos	Asb. Wood Shg.	S. Level <input type="checkbox"/> S. Pover <input type="checkbox"/>	Total No. Bedrooms	Cealed	Cent. Heat Coal AC
	Metal	Cin. Block <input type="checkbox"/> Stone <input type="checkbox"/>			Panel	Flr. or Wall Furnace <input type="checkbox"/> Stove <input checked="" type="checkbox"/>
Wood Frame	Tar & Grav.	Stucco <input type="checkbox"/> Con. Block <input type="checkbox"/>	Crawl <input type="checkbox"/> Conc. <input type="checkbox"/>	NW <input type="checkbox"/> Flg <input type="checkbox"/> Cor. <input type="checkbox"/> Trls <input type="checkbox"/>	Unfinished	
Cin. Block	Tile	Aluminum <input checked="" type="checkbox"/> Masonite <input type="checkbox"/>	Floors <input type="checkbox"/> Cin. Blk <input type="checkbox"/>			Number
Steel Frame	Shakes	Storm Doors <input type="checkbox"/> Storm Win. <input type="checkbox"/>	Slab <input type="checkbox"/> Brick <input type="checkbox"/>	Disappearing Stairs	Od. <input type="checkbox"/> Fair <input type="checkbox"/> Poor <input type="checkbox"/> VP <input type="checkbox"/>	Number Chimneys
			Basement Size 10	Attic Floor & Stairs		Brick <input type="checkbox"/> C. Block <input type="checkbox"/>
			Basmt. Finish	1/4 <input type="checkbox"/> 1/2 <input type="checkbox"/> 3/4 <input type="checkbox"/> Full <input type="checkbox"/>	Attic <input type="checkbox"/> Walls <input type="checkbox"/> Fl. <input type="checkbox"/>	Stone <input type="checkbox"/> Metal <input type="checkbox"/>

157R 1171 213 32202 YR. 1999

Dwelling	D-	28600	65%	10010
Porch	0	138	8	1104
Porch		128	9	1152
Carport				
Garage				
Cent. A/C				

Basement	M & L	M & L	Market Value All Improvements	10010
Basmt. Finish	DATE	DATE	Market Value All Land	3600
Attic	APRP. DR	APRP.	Owner	15600
Fireplace(s)	DATE 1-25-94	DATE	Make	
Heating	CLASSIFICATION 2	ZONING	Size	
Bath(s)			Not Home <input type="checkbox"/> Time	
Total	34458		AM <input type="checkbox"/> PM <input checked="" type="checkbox"/>	
Factor	83		Agric.	
Replacement	28600		Forest	
			Open Space	
			Totals	

Land Cost	\$
Bldg. Cost	\$
Sale Price	\$
Rent	\$
Expenses	\$
Net Rent	\$
BOARD REVIEW NOTES	

Public Water	Paved	
Public Sewer	Gravel	
Well	Dirt	
Septic System	Curb & Gutter	Wasteland
U. G. Utilities	Sidewalk	Wasteland
General Remarks:	MINE SWAK WELL HAVE TO HAUL WATER IN SUMMER	