

**KENNY DISTRICT**

**BLEVINS LEON & JUANITA**  
**RT 2 BOX 277**  
**COEBURN VA**

24230

DATE RECORDED **7-78**  
 DEED OR WILL BOOK **DB 0193 0123**  
 CONSIDERATION **30,000**

DATE RECORDED **6-23-99**  
 DEED OR WILL BOOK **346,775**  
 CONSIDERATION **—**

DATE RECORDED  
 DEED OR WILL BOOK  
 CONSIDERATION

DATE RECORDED  
 DEED OR WILL BOOK  
 CONSIDERATION

DATE RECORDED  
 DEED OR WILL BOOK  
 CONSIDERATION

CLASS **5**  
 ZONING  
 DISTRICT **03**

LEGAL DESCRIPTION  
**CANEY RIDGE**  
**3.82 AC**

1992			
1993		<b>50,000</b>	<b>54,100</b>
1994	<b>4,100</b>		
1995	<b>4,100</b>	<b>50,000</b>	<b>54,100</b>
1996			
1997			
1998			
1999			
2000			
2001			
2002			
2003			

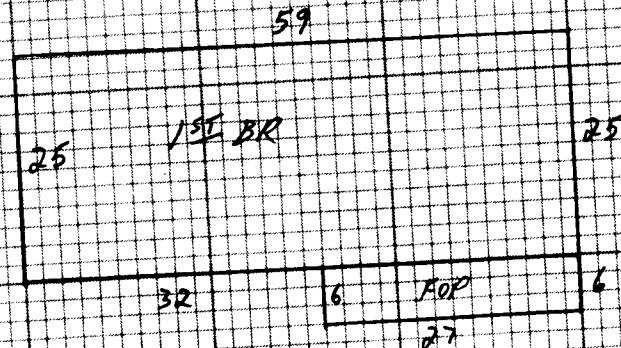

NOTES:

Dwelling	<input checked="" type="checkbox"/>	Comp. Sh.	<input checked="" type="checkbox"/>	Wood Siding		Yr. Built	<u>83</u>	Remod.		Bmnt.	[ ]	2nd	[ ]	Plaster		BATHS	<u>2</u> Full	<u>1/2</u> Baths			
		State		Brick	<input checked="" type="checkbox"/>	No. Stories			<u>1</u>	1st	<u>6</u>	3rd	[ ]	Sheet rock		Modern Bath	<input type="checkbox"/>	Modern Kitchen	<input type="checkbox"/>		
		Asbestos		Asb. Wood Shg.		S. Level	<input type="checkbox"/>	S. Floor	<input type="checkbox"/>	Total No. Bedrooms				Ceiling		Cent. Heat	<u>Electric</u>	A/C	<input checked="" type="checkbox"/>		
		Metal		Cin. Block	<input type="checkbox"/>	Stone	<input type="checkbox"/>							Panel	<input checked="" type="checkbox"/>	Fir. or Wall Furnace	<input type="checkbox"/>	Stove	<input checked="" type="checkbox"/>		
Wood Frame	<input checked="" type="checkbox"/>	Tar & Grav.		Stucco	<input type="checkbox"/>	Con. Block	<input type="checkbox"/>	Crawl	<input type="checkbox"/>	Conc.	<input type="checkbox"/>	HW	<input type="checkbox"/>	Flr	<input type="checkbox"/>	Carpet	<input checked="" type="checkbox"/>	Tile	<input checked="" type="checkbox"/>		
Cin. Block		Tile		Aluminum	<input type="checkbox"/>	Masonite	<input type="checkbox"/>	Riers	<input type="checkbox"/>	Cin. Blk.	<input checked="" type="checkbox"/>										
Steel Frame		Shakes		Storm Doors	<input type="checkbox"/>	Storm Win.	<input type="checkbox"/>	Slab	<input type="checkbox"/>	Brick	<input type="checkbox"/>	Disappearing Stairs		Ed.	<input type="checkbox"/>	Fair	<input type="checkbox"/>	Poor	<input type="checkbox"/>	VP	<input type="checkbox"/>
				Basement Size		<u>10</u>		Attic Floor & Stairs													
				Ed.	<input type="checkbox"/>	Fair	<input type="checkbox"/>	Poor	<input type="checkbox"/>	VP	<input type="checkbox"/>	Basmt. Finish		1/4	<input type="checkbox"/>	1/2	<input type="checkbox"/>	3/4	<input type="checkbox"/>	Full	<input type="checkbox"/>
				Attic	<input type="checkbox"/>	Walls	<input type="checkbox"/>	Fl.	<input type="checkbox"/>					Stone	<input type="checkbox"/>	Metal	<input type="checkbox"/>				

15<sup>th</sup> BR 1475 34 50150

YR. 94

Dwelling																			
Porch	<u>162</u>	<u>10</u>	<u>1620</u>																
Porch																			
Carport																			
Garage																			
Cent. A/C																			

FR. BARN

FV 500

Basement		M & L		M & L		Market Value All Improvements	<u>50,000</u>
Basmt. Finish		DATE		DATE		Market Value All Land	<u>4100</u>
Attic		APRP.		APRP.		Owner	
Fireplace(s)	<u>2000</u>	<u>M.S.</u>				Make	
Heating		DATE	<u>1-25-94</u>	DATE		Year	
Bath(s)		CLASSIFICATION		ZONING		Size	
Total	<u>53770</u>					Cond.	
Factor	<u>1.0</u>					Not Home	<input type="checkbox"/>
Replacement	<u>53770</u>					Time	
						AM	<input type="checkbox"/>
						PM	<input type="checkbox"/>

Land Cost	
\$	
Bldg. Cost	
\$	
Sale Price	
\$	
Rent	
\$	
Expenses	
\$	
Net Rent	
\$	

CLASSIFICATION	ACRES	RATE	ADJ.	CLASSIFICATION	ACRES	RATE	ADJ.
Home Site	<u>1</u>		<u>3000</u>	Home Site			
	<u>2.82</u>	<u>400</u>	<u>1128</u>				
Wasteland				Wasteland			
	<u>3.82</u>		<u>4100</u>				

General Remarks:

LEVEL  SLOPES UP  SLOPES DOWN

LOW  STEEP UP  STEEP DOWN

BOARD REVIEW NOTES