

BAKER JOHN H & PEARL  
RT 1 BOX 261  
CLINTWOOD VA

24228

DATE RECORDED 7/1  
DEED OR WILL BOOK DB 0153 0375

CONSIDERATION

DATE RECORDED

DEED OR WILL BOOK

CONSIDERATION

DATE RECORDED

DEED OR WILL BOOK

CONSIDERATION

DATE RECORDED

DEED OR WILL BOOK

CONSIDERATION

DATE RECORDED

DEED OR WILL BOOK

CONSIDERATION

CLASS 2  
ZONING  
DISTRICT 03

LEGAL DESCRIPTION  
CANEY RIDGE  
.59AC .53 AC

1992			
1993			
1994	3,400	30,900	34,300
1995	3,400	30,900	34,300
1996			
1997			
1998			
1999			
2000	3,000	30,900	33,900
2001			
2002			
2003			

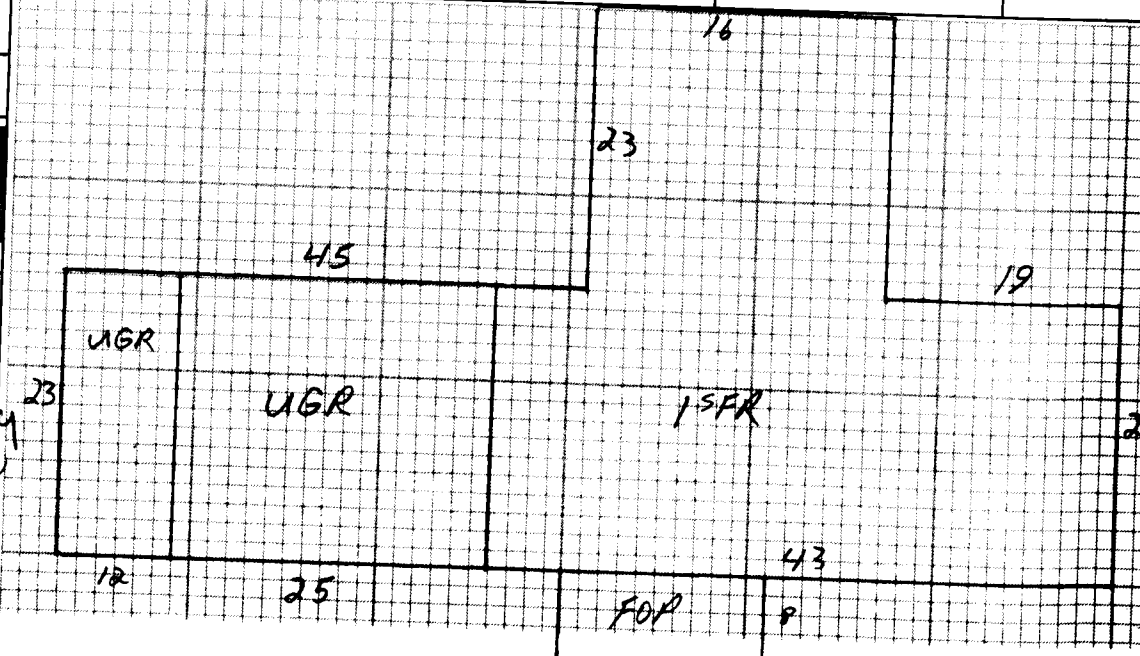

NOTES: According to Ben Sutherland, the attorney who drew up the deed for Walter & Willie Rose, they were to receive .06 AC. See attached sheet, went to Card #19975.

Dwelling	Comp. Sh.	Wood Siding	Yr. Built 73	Remod.	Bemt. ( ) 2nd ( )	Plaster	BATH(s) / Full / 1/2 Bath(s)
MAD	✓ Slate	Brick	No. Stories	1	1st 5 3rd ( )	Sheet rock	Modern Bath <input checked="" type="checkbox"/> Modern Kitchen <input type="checkbox"/>
	Asbestos	Asb. Wood Shg.	B. Level <input type="checkbox"/> S. Foyer <input type="checkbox"/>	Total No. Bedrooms	3	Ceiled	Cent. Heat <input checked="" type="checkbox"/> AC <input checked="" type="checkbox"/> NO
Wood Frame	✓ Tar & Grav.	Cin. Block <input type="checkbox"/> Stone <input type="checkbox"/>	Stucco <input type="checkbox"/> Con. Block <input type="checkbox"/>	Crawl <input type="checkbox"/> Conc. <input type="checkbox"/>	HW <input type="checkbox"/> Pine <input type="checkbox"/> Carp. <input checked="" type="checkbox"/> Tile <input type="checkbox"/>	Unfinished	Panel
Cin. Block	Tile	Aluminum <input type="checkbox"/> Masonite <input checked="" type="checkbox"/>	Riers <input type="checkbox"/> Cin. Blk. <input checked="" type="checkbox"/>	Disappearing Stairs	Gd. <input type="checkbox"/> Fair <input checked="" type="checkbox"/> Poor <input type="checkbox"/> VP <input type="checkbox"/>	Number	1
Steel Frame	Shakes	Storm Doors <input checked="" type="checkbox"/> Storm Win. <input checked="" type="checkbox"/>	Slab <input type="checkbox"/> Brick <input checked="" type="checkbox"/>	Basement Size	70	Attic Floor & Stairs	Number Chimneys
			Gd. <input checked="" type="checkbox"/> Fair <input type="checkbox"/> Poor <input type="checkbox"/> VP <input type="checkbox"/>	Basmt. Finish	1/4 <input type="checkbox"/> 1/2 <input type="checkbox"/> 3/4 <input type="checkbox"/> Full <input type="checkbox"/>	Attic <input checked="" type="checkbox"/> Walls <input checked="" type="checkbox"/> Fl. <input checked="" type="checkbox"/>	Brick <input checked="" type="checkbox"/> C. Block <input type="checkbox"/>

1<sup>st</sup> FR 135729 39353

Dwelling	44003	20%	35200
Porch	152 8 1216		
Garage	851 10 8510		
Basement			
Attic			
Fireplace(s)	1500		
Heating			
Bath(s)			
Total	50579		
Factor	.87		
Replacement	44003		

1 BR Bldg 11x15 1000  
 (1992 was assessed on water base card they stated barn belongs to John Baker)

M & L	M & L	Market Value All Improvements	29900
DATE	DATE	Market Value All Land	3400 3000
APRP.	APRP.	Owner	34300 33900
M.I.S.		Make	
DATE	DATE	Year	
1-25-96		Size	
		Cond.	
CLASSIFICATION	ZONING	Not Home <input type="checkbox"/> Time	
2		AM <input checked="" type="checkbox"/> PM <input type="checkbox"/>	
		Agric.	
		Hort.	
		Forest	
		Open Space	
		Totals	

PROPERTY FACTOR	CLASSIFICATION	ACRES	RATE	ADJ.	CLASSIFICATION	ACRES	RATE	ADJ.
Public Water <input checked="" type="checkbox"/> Paved <input checked="" type="checkbox"/>	Home Site	.59			Home Site			
Public Sewer <input type="checkbox"/> Gravel <input type="checkbox"/>		.53						
Well <input type="checkbox"/> Dirt <input type="checkbox"/>								
Spring <input type="checkbox"/> No Road <input type="checkbox"/>								
Septic System <input checked="" type="checkbox"/> Curb & Gutter <input type="checkbox"/>	Wasteland	.53			Wasteland			
U. G. Utilities <input type="checkbox"/> Sidewalk <input type="checkbox"/>		.59						

General Remarks:  
 House sitting on back of coal mine all around  
 no damage yet. 15% map

Land Cost	
\$	
Bldg. Cost	
\$	
Sale Price	
\$	
Rent	
\$	
Expenses	
\$	
Net Rent	
\$	

BOARD REVIEW NOTES

