

RECORD OF OWNERSHIP

KISER, MYRON D
~~ST RT BOX 160~~ Box 903
~~DANTE VA 24237~~ ST. PAUL VA 24287

| | |
|-------------------|--------------------|
| DATE RECORDED | 11-78 |
| DEED OR WILL BOOK | 195-009 |
| CONSIDERATION | VE- SE 1,200.00 |

03024

| | |
|-------------------|--|
| DATE RECORDED | |
| DEED OR WILL BOOK | |
| CONSIDERATION | |
| DATE RECORDED | |
| DEED OR WILL BOOK | |
| CONSIDERATION | |
| DATE RECORDED | |
| DEED OR WILL BOOK | |
| CONSIDERATION | |
| DATE RECORDED | |
| DEED OR WILL BOOK | |
| CONSIDERATION | |

| | |
|----------|----|
| CLASS | 2 |
| ZONING | |
| DISTRICT | 02 |

LEGAL DESCRIPTION
SANDY RIDGE
1AC

| | | | |
|------|------|------|--------|
| 1986 | 4000 | 7800 | 11,800 |
| 1987 | 4000 | 7800 | 11800 |
| 1988 | 4000 | 7800 | 11800 |
| 1989 | 4000 | 7800 | 11800 |
| 1990 | 4000 | 7800 | 11800 |
| 1991 | 4000 | 7800 | 11800 |
| 1992 | | | |
| 1993 | | | |
| 1994 | | | |
| 1995 | | | |
| 1996 | | | |
| 1997 | | | |

BUILDING PERMITS

| NO. | TYPE | DATE | ISSUED | EXPIRES | REMARKS |
|-----|------|------|--------|---------|---------|
| | | | | | |
| | | | | | |
| | | | | | |
| | | | | | |

NOTES:

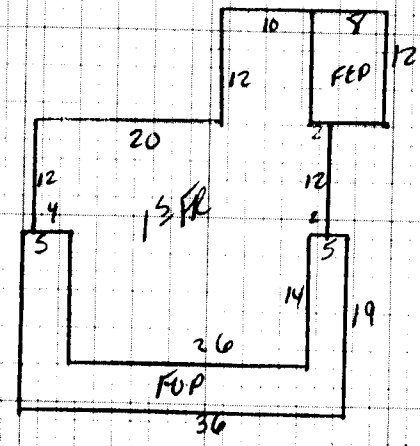

| | | | | | | |
|-------------|-------------|---|--|---|---|--|
| Dwelling | Comp. Sh. | Wood Siding | Yr. Built <u>30</u> Remod. | Bsmt. [] 2nd [] | Plaster | BATH <u>NO</u> Full <input type="checkbox"/> 1/2 Bath(s) |
| Slate | | Brick | No. Stories <u>1</u> | 1st [6] 3rd [] | Sheet rock | Modern Bath <input type="checkbox"/> Modern Kitchen <input type="checkbox"/> |
| Asbestos | | Asb. Wood Shg. | S. Level <input type="checkbox"/> S. Foyer <input type="checkbox"/> | Total No. Bedrooms | Ceciled | Cent. Heat <input type="checkbox"/> A/C |
| Metal | | Cln. Block <input type="checkbox"/> Stone <input type="checkbox"/> | | | Panel | Fir. or Wall Furnace <input type="checkbox"/> Stove(s) <input checked="" type="checkbox"/> |
| Wood Frame | Tar & Grav. | Stucco <input type="checkbox"/> Con. Block <input type="checkbox"/> | Crawl <input type="checkbox"/> Conc. <input type="checkbox"/> | HW <input type="checkbox"/> Pine <input type="checkbox"/> Carp. <input checked="" type="checkbox"/> Tile <input type="checkbox"/> | Unfinished | |
| Cln. Block | Tile | Aluminum <input type="checkbox"/> Masonite <input type="checkbox"/> | Riers <input checked="" type="checkbox"/> Cln. Blk. <input type="checkbox"/> | | | Number <u>NO</u> |
| Steel Frame | Shakes | Storm Doors <input type="checkbox"/> Storm Win. <input type="checkbox"/> | Slab <input type="checkbox"/> Brick <input type="checkbox"/> | Disappearing Stairs | Gd. <input type="checkbox"/> Fair <input type="checkbox"/> Poor <input checked="" type="checkbox"/> VP <input type="checkbox"/> | Number Chimneys |
| | | | Basement Size <u>NO</u> | Attic Floor & Stairs | | Brick [] C. Block [] |
| | | Gd. <input type="checkbox"/> Fair <input type="checkbox"/> Poor <input checked="" type="checkbox"/> VP <input type="checkbox"/> | Basmt. Finish | 1/4 <input type="checkbox"/> 1/2 <input type="checkbox"/> 3/4 <input type="checkbox"/> Full <input type="checkbox"/> | Attic <input type="checkbox"/> Walls <input type="checkbox"/> Fl. <input type="checkbox"/> | Stone [] Metal [] |

13PR 868 315 27,342

| | | | | | | | | | |
|----------------|------------|-----------|-------------|------------|---------------|--------------|-------------|------------|--|
| Dwelling | | | | <u>E-</u> | <u>21,911</u> | <u>-6.5%</u> | <u>7696</u> | | |
| Porch <u>O</u> | <u>310</u> | <u>8</u> | <u>2480</u> | | | | <u>FV</u> | <u>100</u> | |
| Porch <u>E</u> | <u>96</u> | <u>12</u> | <u>1152</u> | <u>UST</u> | | | | | |
| Carport | | | | | | | | | |
| Garage | | | | | | | | | |
| Cent. A/C | | | | | | | | | |
| Basement | | | | | | | | | |
| Bsmt. Finish | | | | | | | | | |
| Attic | | | | | | | | | |
| Fireplace(s) | | | | | | | | | |
| Heating | | | | | | | | | |
| Bath(s) | | | | | | | | | |

| | | | | |
|-----------------|----------|--|-------------------------------|---------------|
| M & L | M & L | MOBILE HOME INFORMATION | Market Value All Improvements | <u>17796</u> |
| DATE | DATE | Owner | Market Value All Land | <u>4000</u> |
| APRP. <u>ml</u> | APRP. | Make | | <u>11,796</u> |
| DATE | DATE | Size | | |
| <u>8-19-85</u> | <u>2</u> | Not Home <input type="checkbox"/> Time | | |
| CLASSIFICATION | ZONING | AM <input type="checkbox"/> PM <input checked="" type="checkbox"/> | | |
| <u>2</u> | <u>2</u> | INFORMATION BY | | |

| | | | | | | | | | | |
|------------------|----------------|----------|------|------|----------------|-------|-------------|------|------------|----|
| PROPERTY FACTORS | CLASSIFICATION | ACRES | RATE | ADJ. | CLASSIFICATION | ACRES | RATE | ADJ. | Land Cost | \$ |
| Public Water | Home Site | <u>1</u> | | | Home Site | | <u>4000</u> | | Bldg. Cost | \$ |
| Public Sewer | | | | | | | | | Sale Price | \$ |
| Well | | | | | | | | | Rent | \$ |
| Spring | | | | | | | | | Expenses | \$ |
| Septic System | Wasteland | <u>1</u> | | | Wasteland | | <u>4000</u> | | Net Rent | \$ |
| U. G. Utilities | | | | | | | | | Totals | \$ |

General Remarks:

LEVEL SLOPES UP SLOPES DOWN

LOW STEEP UP STEEP DOWN

BOARD REVIEW NOTES