

**KIMBA HILTON & SHERRY**  
~~BT RT 50A 333A~~ **H067 Bld 333**  
**DANTE VA** **24237**

CLASS	2	LEGAL DESCRIPTION LICK CREEK 3.0AC
ZONING		
DISTRICT	02	

DATE RECORDED	71
DEED OR WILL BOOK	149-272
CONSIDERATION	\$300.00
DATE RECORDED	
DEED OR WILL BOOK	
CONSIDERATION	
DATE RECORDED	
DEED OR WILL BOOK	
CONSIDERATION	
DATE RECORDED	
DEED OR WILL BOOK	
CONSIDERATION	
DATE RECORDED	
DEED OR WILL BOOK	
CONSIDERATION	

1992	4,000	33,300	37,300
1993	4,000	33,300	37,300
1994			
1995			
1996			
1997			
1998			
1999			
2000			
2001			
2002			
2003			

NOTES:

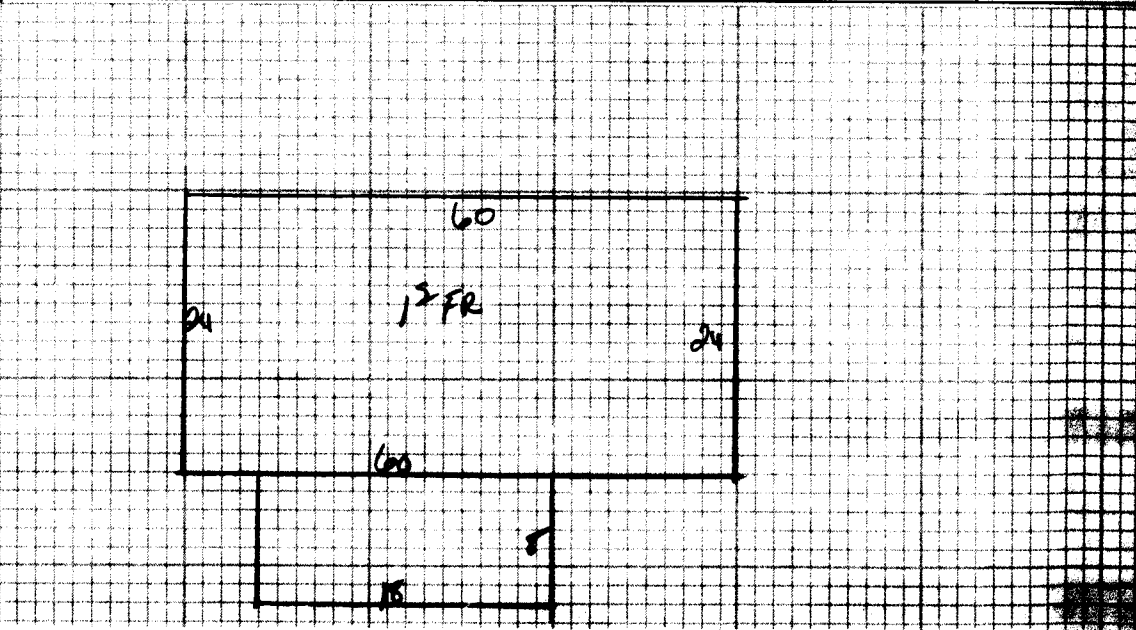
Dwelling	Comp. Sh.	Wood Siding	Yr. Built	Remod.	Bmnt.	1st	2nd	3rd	Plaster
	Asbestos	Brick	No. Stories		1st	2nd	3rd		Sheet rock
Wood Frame	Metal	Asb. Wood Shg.	S. Level	S. Poyer	Total No. Bedrooms			Ceiling	
Cin. Block	Tar & Grav.	Cin. Block	Con. Block	Crawl	Conc.	NW	Pine	Corp.	Tile
Steel Frame	Tile	Aluminum	Masonite	Riers	Cin. Blk.	Disappearing Stairs			Od.
	Stones	Storm Doors	Storm Win.	Slab	Brick	Od.			Fair
				Basement Size	Attic Floor & Stairs				
				Basmt. Finish	1/4			1/2	3/4

177-1480-29 41,760

144 8 1152

1440

36,812

1056

33,130

Picnic Shed

FV 200

Market Value All Improvements	33,300
Market Value All Land	4,000
<b>Total</b>	<b>37,300</b>
Owner	
Make	Year
Size	Cond.
Not Home	Time
AM	PM
CLASSIFICATION	ZONING
2	

CLASSIFICATION	ACRES	RATE	ADJ.	CLASSIFICATION	ACRES	RATE	ADJ.
Home Site	1		3000	Home Site			
Public Water	2	500	1000				
Public Sewer							
Well							
Spring							
Septic System							
M. S. Utilities	3		4000				

General Remarks:

SLOPES UP  SLOPES DOWN

STEEP UP  STEEP DOWN

BOARD REVIEW NOTES