

<del>00000000000000000000</del> <del>00000000000000000000</del> <del>00000000000000000000</del>	DATE RECORDED	
	DEED OR WILL BOOK	
02623	CONSID-ERATION	YR-SP
<i>Steffey, Katherine</i> <i>Box - 151</i> <i>Clinchco, Virginia 24226</i>	DATE RECORDED	
	DEED OR WILL BOOK	
	CONSID-ERATION	
	DATE RECORDED	
	DEED OR WILL BOOK	
	CONSID-ERATION	
	DATE RECORDED	
	DEED OR WILL BOOK	
	CONSID-ERATION	
	DATE RECORDED	
	DEED OR WILL BOOK	
	CONSID-ERATION	

CLASS	2	LEGAL DESCRIPTION CLINCHCO LOT 107 ***
ZONING		
DISTRICT	0211	

1986	2,500	14,700	17,200	
1987	2,500	14,700	17,200	
1988	2,500	14,700	17,200	
1989	2,500	14,700	17,200	
1990	2,500	14,700	17,200	
1991	2,500	14,700	17,200	
1992				
1993				
1994				
1995				
1996				
1997				

BUILDING PERMITS

NOTES:

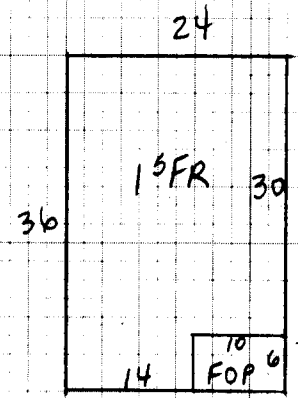
Dwelling	<input checked="" type="checkbox"/>	Comp. Sh.	<input checked="" type="checkbox"/>	Wood Siding	<input checked="" type="checkbox"/>	Yr. Built	<u>20</u>	Remod.	<u>81</u>	Bsmt.	[ ]	2nd	[ ]	Plaster		BATH(S) / Full	1/2 Bath(s)				
		Slate		Brick		No. Stories		1st	<u>5</u>	3rd	[ ]			Sheet rock		Modern Bath	<input type="checkbox"/>	Modern Kitchen	<input type="checkbox"/>		
		Asbestos		Asb. Wood Shg.		S. Level	<input type="checkbox"/>	S. Foyer	<input type="checkbox"/>	Total No. Bedrooms				Ceciled		Cent. Heat	<u>016</u>	A/C			
		Metal		Cin. Block	<input type="checkbox"/>	Stone	<input type="checkbox"/>							Panel	<input checked="" type="checkbox"/>	Fir. or Wall Furnace	<input type="checkbox"/>	Stove(s)	<input type="checkbox"/>		
Wood Frame	<input checked="" type="checkbox"/>	Tar & Grav.		Stucco	<input type="checkbox"/>	Con. Block	<input type="checkbox"/>	Crawl	<input type="checkbox"/>	Conc.	<input type="checkbox"/>	HW	<input type="checkbox"/>	Pine	<input type="checkbox"/>	Carp.	<input type="checkbox"/>	Tile	<input checked="" type="checkbox"/>	Unfinished	
Cin. Block		Tile		Aluminum	<input type="checkbox"/>	Masonite	<input type="checkbox"/>	Riers	<input type="checkbox"/>	Cin. Bk.	<input checked="" type="checkbox"/>										
Steel Frame		Shakes		Storm Doors	<input type="checkbox"/>	Storm Win.	<input type="checkbox"/>	Slab	<input type="checkbox"/>	Brick	<input type="checkbox"/>	Disappearing Stairs		Gd.	<input type="checkbox"/>	Fair	<input checked="" type="checkbox"/>	Poor	<input type="checkbox"/>	VP	<input type="checkbox"/>
				Basement Size		<u>NO</u>		Attic Floor & Stairs													
				Gd.	<input type="checkbox"/>	Fair	<input checked="" type="checkbox"/>	Poor	<input type="checkbox"/>	VP	<input type="checkbox"/>	Basmt. Finish		1/4	<input type="checkbox"/>	1/2	<input type="checkbox"/>	3/4	<input type="checkbox"/>	Full	<input type="checkbox"/>
				Attic	<input type="checkbox"/>	Walls	<input type="checkbox"/>	Fl.	<input type="checkbox"/>	Stone	[ ]	Metal	[ ]								

15 FR 804 32 25,728

YR. 86 YR. YR.

Dwelling																					
Porch	<u>60</u>	<u>8</u>	<u>480</u>																		
Carport																					
Garage																					
Cent. A/C																					

Basement		M & L		M & L		MOBILE HOME INFORMATION	Market Value All Improvements	<u>14,742</u>
Bsmt. Finish		DATE		DATE		Owner	Market Value All Land	<u>2500</u>
Attic		APRP.	<u>M.R.</u>	APRP.		Make		<u>17,242</u>
Fireplace(s)		DATE	<u>4/3/05</u>	DATE		Year		
Heating		CLASSIFICATION	<u>2</u>	ZONING		Size		
Bath(s)		Not Home	<input type="checkbox"/>	Time		Cond.		
Total	<u>26,208</u>	AM	<input checked="" type="checkbox"/>	PM	<input type="checkbox"/>	Agric.		
Factor	<u>.75</u>	Forest		Open Space		Hort.		
Replacement	<u>19,656</u>	Totals				Forest		

Land Cost								
Bldg. Cost								
Sale Price								
Rent								
Expenses								
Net Rent								

PROPERTY FACTORS	CLASSIFICATION	ACRES	RATE	ADJ.	CLASSIFICATION	ACRES	RATE	ADJ.
Public Water	<input checked="" type="checkbox"/>	Paved	<input checked="" type="checkbox"/>	Home Site	<u>Lot #107</u>	<u>2500</u>	Home Site	
Public Sewer		Gravel						
Well		Dirt						
Spring		No Road						
Septic System		Curb & Gutter		Wasteland			Wasteland	
U. G. Utilities		Sidewalk						

General Remarks:

LEVEL  SLOPES UP  SLOPES DOWN

LOW  STEEP UP  STEEP DOWN

BOARD REVIEW NOTES