

~~11664 BEACH BLVD ART 2~~  
~~STATE VA BILOXI, MS 24227~~  
 39531

CLASS 2  
 ZONING  
 DISTRICT 02  
 LEGAL DESCRIPTION  
 SANDY RIDGE  
 .88AC

~~DICKERSON GAINES ETAL~~  
~~291434~~  
~~2 TRACTS~~  
~~301499~~  
 POWERS DONALD R, Bessie  
 Rt 1 Box 424  
 NORTON, VA, 24273

1992	3000	15000	18000
1993	3000	15000	18000
1994			
1995			
1996			
1997			
1998			
1999			
2000			
2001			
2002			
2003			

BUILDING PERMIT

NO.	DATE	NO.	DATE

NOTES: Robert Sutherland  
 PO Box 651  
 Castlewood, Va. 24884  
 DB 242-PG 333- Separation Agreement  
 1000 12600

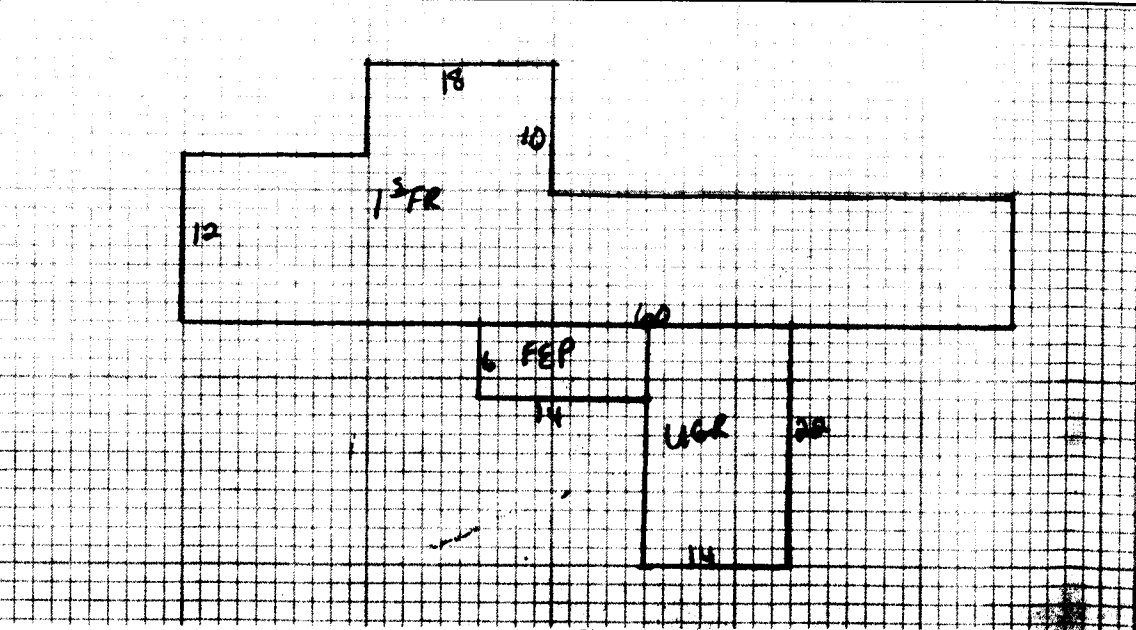

Dwelling	<input checked="" type="checkbox"/>	Camp. Sh.	Wood Siding	Yr. Built	Remod.	Bemt. [ ] 2nd [ ]	Plaster	BATHS / Full	<input checked="" type="checkbox"/> Bathing		
		State	Brick	No. Stories		1st [3] 2nd [ ]	Sheet rock	Modern Bath <input type="checkbox"/>	Modern Kitchen <input type="checkbox"/>		
		Asbestos	Asb. Wood Shg.	S. Level <input type="checkbox"/>	S. Foyer <input type="checkbox"/>	Total No. Bedrooms	Ceiled	Cent. Heat <input checked="" type="checkbox"/>	AD		
		Metal	Cin. Block <input type="checkbox"/>	Stone <input type="checkbox"/>			Panel	Fir. or Wall Furnace <input type="checkbox"/>	Stove <input type="checkbox"/>		
Wood Frame	<input checked="" type="checkbox"/>	Tar & Grav.	Stucco <input type="checkbox"/>	Con. Block <input type="checkbox"/>	Crawl <input type="checkbox"/>	Conc. <input type="checkbox"/>	NW <input type="checkbox"/>	Pine <input type="checkbox"/>	Carp. <input type="checkbox"/>	Tile <input type="checkbox"/>	Unfinished
Cin. Block		Tile	Aluminum <input checked="" type="checkbox"/>	Masonite <input type="checkbox"/>	Flers <input type="checkbox"/>	Cin. Blk. <input type="checkbox"/>					
Steel Frame		Shakes	Storm Doors <input type="checkbox"/>	Storm Win. <input type="checkbox"/>	Slab <input type="checkbox"/>	Brick <input type="checkbox"/>	Disappearing Stairs	Gd. <input type="checkbox"/>	Fair <input type="checkbox"/>	Poor <input type="checkbox"/>	VP <input type="checkbox"/>

1<sup>st</sup> FR 900 30 27,00

Porch E 84 8 672

Garage 308 10 3080

Total 30,752

Factor .75

Replacement 23,064

Gd.  Fair  Poor  VP

Basement Size  
Bemt. Finish

Attic Floor & Stairs  
1/4  1/2  3/4  Full

Attic  Walls  Fl.   
YR. 1991

Brick [ ] C. Block [ ]  
Stone [ ] Metal [ ]

Dwelling

E

23,064

35%

14,991

M & L

Market Value All Improvements

15,000

DATE

Owner

Market Value All Land

3,000

APRP.

Make Year

TOTAL MARKET VALUE

18,000

DATE

Size Cond.

DATE

Not Home  Time

CLASSIFICATION

AM  PM

ZONING

2

Agric.

Hort.

Forest

Open Space

Totals

Land Cost

\$

Bldg. Cost

\$

Sale Price

\$

Rent

\$

Expenses

\$

Net Rent

\$

BOARD REVIEW NOTES

Public Water	Paved	
Public Sewer	Gravel	
Well	<input checked="" type="checkbox"/> Dirt	<input checked="" type="checkbox"/>
Spring	No Road	
Septic System	<input checked="" type="checkbox"/> Curb & Gutter	
U. S. Utilities	Sidewalk	

CLASSIFICATION	ACRES	RATE	ADJ.	CLASSIFICATION	ACRES	RATE	ADJ.
Home Site	.88		3000	Home Site			
Wasteland				Wasteland			
	.18		3000				

General Remarks: Road along 1524

LOW  STEEP UP  STEEP DOWN