

BARTON EARL & BONNIE

BEE VA

24217

Mr. Bonnie Barton
 P.O. Box 239
 Danversport VA, 24239

DATE RECORDED 10/28/74
 DEED OR WILL BOOK DB 0167 0603
 CONSIDERATION

DATE RECORDED
 DEED OR WILL BOOK
 CONSIDERATION
 DATE RECORDED
 DEED OR WILL BOOK
 CONSIDERATION

DATE RECORDED
 DEED OR WILL BOOK
 CONSIDERATION

DATE RECORDED
 DEED OR WILL BOOK
 CONSIDERATION

CLASS 2
 ZONING
 DISTRICT 02

LEGAL DESCRIPTION
 ABNER'S BRANCH
 1.50AC
 178-124A (A) 2132

1992			
1993			
1994	3,500	18,600	22,100
1995	3,500	18,600	22,100
1996			
1997			
1998			
1999			
2000			
2001			
2002			
2003			

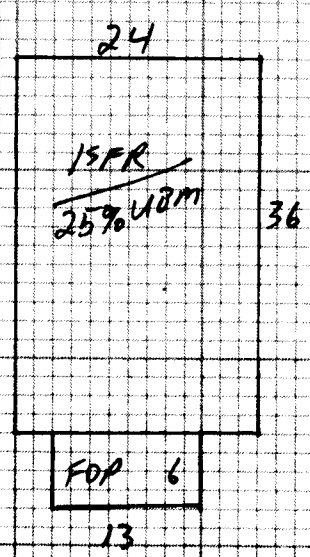

NOTES:

Dwelling	<input checked="" type="checkbox"/>	Comp. Sh.	<input checked="" type="checkbox"/>	Wood Siding		Yr. Built	50	Remod.	70	Bemt.	[] 2nd []	Plaster		BATH(S) / Full	1/2 Bath(s)
		Slate		Brick		No. Stories				1st	[] 3rd []	Sheet rock		Modern Bath	<input type="checkbox"/> Modern Kitchen <input type="checkbox"/>
		Asbestos		Aeb. Wood Shg.		B. Level	<input type="checkbox"/>	S. Foyer	<input type="checkbox"/>	Total No. Bedrooms		Ceclied		Cent. Heat	Oil A/C
		Metal		Cin. Block <input type="checkbox"/> Stone <input type="checkbox"/>								Panel	<input checked="" type="checkbox"/>	Fir. or Wall Furnace	<input type="checkbox"/> Stove(s) <input type="checkbox"/>
Wood Frame	<input checked="" type="checkbox"/>	Tar & Grav.		Stucco <input type="checkbox"/> Con. Block <input type="checkbox"/>		Crawl <input type="checkbox"/> Conc. <input type="checkbox"/>		NW <input type="checkbox"/> Pine <input type="checkbox"/> Carp. <input type="checkbox"/> Tile <input type="checkbox"/>		Unfinished					
Cin. Block		Tile		Aluminum <input checked="" type="checkbox"/> Masonite <input type="checkbox"/>		Riers <input type="checkbox"/> Cin. Blk. <input type="checkbox"/>								Number	70
Steel Frame		Shakes		Storm Doors <input type="checkbox"/> Storm Win. <input type="checkbox"/>		Slab <input type="checkbox"/> Brick <input type="checkbox"/>		Disappearing Stairs		Gd. <input type="checkbox"/> Fair <input type="checkbox"/> Poor <input type="checkbox"/> VP <input type="checkbox"/>				Number Chimneys	

Basement Size	25%	Attic Floor & Stairs		Brick [] C. Block []
Gd. <input type="checkbox"/> Fair <input checked="" type="checkbox"/> Poor <input type="checkbox"/> VP <input type="checkbox"/>		Basmt. Finish	1/4 <input type="checkbox"/> 1/2 <input type="checkbox"/> 3/4 <input type="checkbox"/> Full <input type="checkbox"/>	Attic <input type="checkbox"/> Walls <input type="checkbox"/> Fl. <input type="checkbox"/>
15 FR 864 30 22 920				Stone [] Metal []
				YR. 94

Dwelling		D-	23 216	25%	17 400
Porch	108 6 648				
Porch					
Carport					
Garage					
Cent. A/C					

Basement	216 65 1404	M & L	M & L	Market Value All Improvements	18,600
Basmt. Finish		DATE	DATE	Market Value All Land	3500
Attic		APRP.	APRP.	Owner	22,100
Fireplace(s)				Make	
Heating				Year	
Bath(s)				Size	
Total	27,972	DATE	DATE	Not Home <input type="checkbox"/> Time	
Factor		2/1/94		AM <input type="checkbox"/> PM <input type="checkbox"/>	
Replacement		CLASSIFICATION	ZONING	Agric.	
		2		Hort.	

Land Cost	
Bldg. Cost	
Sale Price	
Rent	
Expenses	
Net Rent	

Public Water	Paved	<input checked="" type="checkbox"/>	CLASSIFICATION	ACRES	RATE	ADJ.	CLASSIFICATION	ACRES	RATE	ADJ.
Public Sewer	Gravel		Home Site	1.2			Home Site			
Well	Dirt	<input checked="" type="checkbox"/>								
Spring	No Road									
Septic System	Curb & Gutter	<input checked="" type="checkbox"/>	Wasteland				Wasteland			
U. G. Utilities	Sidewalk			1.2					3500	

General Remarks: House sits on very steep hill.

LEVEL SLOPES UP SLOPES DOWN

LOW STEEP UP STEEP DOWN

BOARD REVIEW NOTES