

# Ervington District

19 927

Bise, Larry & Janie B.  
Rt. 1 Box 20943  
Clintwood, VA 24228

DATE RECORDED 6-9-73  
DEED OR WILL BOOK 160-483  
CONSIDERATION

CLASS 2  
ZONING  
DISTRICT 02

LEGAL DESCRIPTION  
Reedy Ridge  
2.69 AC

DATE RECORDED  
DEED OR WILL BOOK  
CONSIDERATION

DATE RECORDED  
DEED OR WILL BOOK  
CONSIDERATION

DATE RECORDED  
DEED OR WILL BOOK  
CONSIDERATION

DATE RECORDED  
DEED OR WILL BOOK  
CONSIDERATION

1992  
1993  
1994  
1995  
1996  
1997  
1998  
1999  
2000  
2001  
2002  
2003

6,000      27,000      33,000

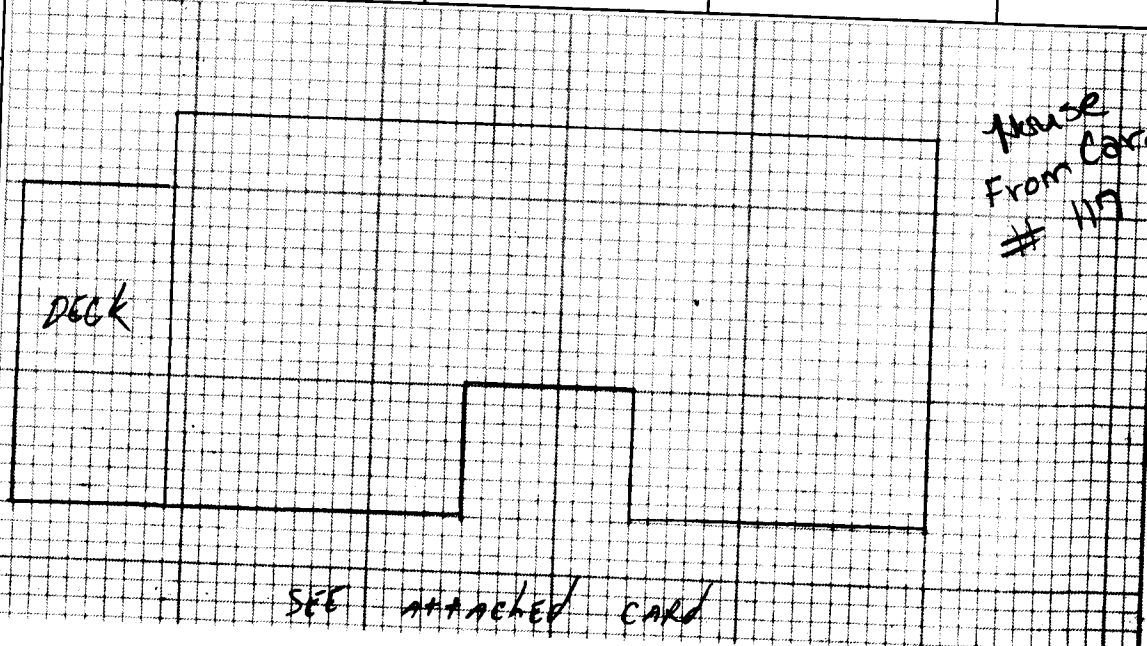

NOTES: New Survey done on property. See attached plat.

Dwelling	Comp. Sh.	Wood Siding	Yr. Built <u>40</u>	Remod. <u>70</u>	Basmt.	Plaster	BATH(S) Full <input type="checkbox"/> 1/2 Bath(s) <input type="checkbox"/>
State	Brick	No. Stories <u>1</u>	1st <input checked="" type="checkbox"/>	2nd <input type="checkbox"/>	3rd <input type="checkbox"/>	Sheet rock	Modern Bath <input type="checkbox"/> Modern Kitchen <input type="checkbox"/>
Asbestos	Aeb. Wood Shg.	S. Level <input type="checkbox"/> S. Foyer <input type="checkbox"/>	Total No. Bedrooms		Ceiled	Cent. Heat <u>014</u>	A/C <input type="checkbox"/>
Metal	Cin. Block <input type="checkbox"/> Stone <input type="checkbox"/>	Crawl <input type="checkbox"/> Conc. <input type="checkbox"/>	HW <input type="checkbox"/> Pine <input type="checkbox"/> Carp. <input type="checkbox"/> Yls <input type="checkbox"/>		Unfinished	Panel	Fir. or Wall Furnace <input type="checkbox"/> Stove(s) <input type="checkbox"/>
Wood Frame	Tar & Grav.	Stucco <input type="checkbox"/> Con. Block <input type="checkbox"/>	Riers <input type="checkbox"/> Cin. Blk. <input checked="" type="checkbox"/>				Number <u>00</u>
Cin. Block	Tile	Aluminum <input checked="" type="checkbox"/> Masonite <input type="checkbox"/>	Stab <input type="checkbox"/> Brick <input type="checkbox"/>		Disappearing Stairs		Number Chimneys
Steel Frame	Shakes	Storm Doors <input type="checkbox"/> Storm Win. <input type="checkbox"/>	Basement Size <u>00</u>		Attic Floor & Stairs		Brick <input type="checkbox"/> C. Block <input type="checkbox"/>

<u>15FR 1333 295 39323</u>	Gd. <input type="checkbox"/> Fair <input checked="" type="checkbox"/> Poor <input type="checkbox"/> VP <input type="checkbox"/>	Basmt. Finish	1/4 <input type="checkbox"/> 1/2 <input type="checkbox"/> 3/4 <input type="checkbox"/> Full <input type="checkbox"/>	Attic <input type="checkbox"/> Walls <input type="checkbox"/> Fl. <input type="checkbox"/>	YR. <u>94</u>	YR.	YR.
----------------------------	---	---------------	--	--	---------------	-----	-----

Porch	<u>224 8 1792</u>	Dwelling	<u>FR gen.</u>	<u>23434</u>	<u>01</u>	<u>39113</u>	<u>407</u>	<u>23467</u>
Porch	<u>200 7 1400</u>		<u>FR St.</u>					
Carport			<u>CON. Drive</u>					
Garage								
Cent. A/C								

Basement	M & L	M & L	Market Value All Improvements	<u>2700</u>	<u>27000</u>
Basmt. Finish	DATE	DATE	Market Value All Land	<u>6,000</u>	<u>6,000</u>
Attic	APPR. <u>MS</u>	APPR.	Owner	<u>2700</u>	<u>33,000</u>
Fireplace(s)	DATE <u>2-7-94</u>	DATE	Make		
Heating	CLASSIFICATION	ZONING	Size		
Bath(s)			Not Home <input type="checkbox"/> Time		
Total	<u>42515</u>		AM <input type="checkbox"/> PM <input type="checkbox"/>		
Factor	<u>92</u>		Agric.		
Replacement	<u>39113</u>		Hort.		
			Forest		
			Open Space		
			Totals		

Land Cost	\$
Bldg. Cost	\$
Sale Price	\$
Rent	\$
Expenses	\$
Net Rent	\$

PROPERTY FACTOR	CLASSIFICATION	ACRES	RATE	ADJ.	CLASSIFICATION	ACRES	RATE	ADJ.
Public Water <input checked="" type="checkbox"/> Paved <input checked="" type="checkbox"/>	Home Site	<u>1.69</u>	<u>1200</u>		Home Site			
Public Sewer <input type="checkbox"/> Gravel <input type="checkbox"/>								
Well <input type="checkbox"/> Dirt <input type="checkbox"/>								
Spring <input type="checkbox"/> No Road <input type="checkbox"/>								
Septic System <input checked="" type="checkbox"/> Curb & Gutter <input type="checkbox"/>	Wasteland				Wasteland			
U. G. Sidewalk <input type="checkbox"/>								

4000  
2,0280  
See attached Card  
6,000

General Remarks:

SLOPES UP  SLOPES DOWN

LOW  STEEP UP  STEEP DOWN

BOARD REVIEW NOTES

# LEGEND

STANDARD SYMBOLS THAT MAY APPEAR ON THIS DRAWING:

- IRON PIN SET THIS SURVEY UNLESS OTHERWISE SHOWN
- NO MONUMENT SET
- X—X— FENCE

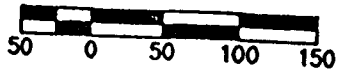

SCALE 1"=100'

THE BASIS OF BEARINGS WAS A SOLAR OBSERVATION USING THE HOUR ANGLE METHOD

## SURVEY PLAT NOTES:

- (1) THIS FIELD SURVEY WAS PERFORMED WITHOUT AN ABSTRACT OF TITLE, TITLE OPINION OR TITLE SEARCH BEING FURNISHED TO THE SURVEYOR. NO LIABILITY IS ASSUMED BY THE UNDERSIGNED FOR LOSS RELATING TO ANY MATTER THAT MIGHT BE DISCOVERED BY AN ABSTRACT OR TITLE SEARCH.
- (2) NO WARRANTY OR GUARANTEE IS IMPLIED AS TO THE EXISTENCE OF ANY EASEMENTS OF ANY TYPE.
- (3) NO WARRANTY OR GUARANTEE IS IMPLIED AS TO THE EXISTENCE OF ACTS OF POSSESSION BY ADJOINING LANDOWNERS TO THE LANDS SHOWN BY THIS SURVEY.
- (4) NO WARRANTY OR GUARANTEE IS IMPLIED AS TO THE EXISTENCE OF ANY CEMETERIES OR GRAVES.
- (5) NO WARRANTY OR GUARANTEE IS IMPLIED AS TO THE EXISTENCE OF ANY UTILITIES OF ANY TYPE OR ANY BURIED PIPELINES AND TANKS OF ANY TYPE OR ANY UNDERGROUND LINES, TUNNELS, CULVERTS OR STRUCTURES OF ANY TYPE.
- (6) NO WARRANTY OR GUARANTEE IS IMPLIED AS TO THE EXISTENCE OF ANY RESTRICTIVE COVENANTS OF ANY TYPE.

## SURVEYOR'S REPORT

I, ROY K. BALTHIS, A LICENSED LAND SURVEYOR IN THE COMMONWEALTH OF VIRGINIA, DO HEREBY REPORT, SUBJECT TO THE SURVEY PLAT NOTES SHOWN HEREON, THAT THE FIELD SURVEY AND MAP PREPARED BY MYSELF OR UNDER MY SUPERVISION SUBSTANTIALLY MEETS THE STANDARDS OF PRACTICE FOR LAND SURVEYING IN VIRGINIA. THE BOUNDARY SURVEY SHOWN HEREON WAS BASED ON A CURRENT FIELD SURVEY COMPLETED ON 10 MAY, 1999.

*Roy K. Balthis*, LS 1449

5-17-99



CHARLES KRAM  
TRACT NO. 1  
DB 192, PG 113

PLASTAKE  
(FOUND)

JIMMY BAKER  
DB 304, PG 52

IRON PIN  
(SET)

ROOF BOLT  
(FOUND)

IRON PIN  
(SET)

LARRY O. BISE  
JANIE B. BISE  
DB 161, PG 535

ROOF BOLT  
(FOUND)

N 67°39'15" E  
214.84'

N 13°30'32" E  
221.84'

N 00°22'27" W  
151.96'

N 66°18'46" W  
134.82'

N 62°21'36" E  
142.86'

N 62°21'36" E  
268.24'

N 03°44'47" W  
407.64'

N 84°35'47" W  
132.81'

S 38°58'10" E  
353.30'

S 38°58'10" E  
165.00'

S 64°22'15" S  
175.00'

S 64°22'15" S  
175.00'

S 64°22'15" S  
175.00'

S 64°22'15" S  
175.00'

S 64°22'15" S  
175.00'

1.417 ACRES

4.172 ACRES

0.759 ACRES

DB 161, PG 535

LARRY O. BISE  
JANIE B. BISE  
DB 161, PG 535  
0.520 ACRES

NOTE:  
ROUTE 639 RIGHT-OF-WAY  
DB 225, PG 30

PLAT PREPARED FOR: LARRY BISE

SHOWING A BOUNDARY SURVEY OF A 4.172 ACRE PARCEL OF THE LARRY O. BISE JANIE B. BISE PARCEL (DB 161, PG 535) SITUATED ON FREEBY RIDGE IN THE OLD MAGISTERIAL DISTRICT OF DICKENSON COUNTY, VIRGINIA

PLAT PREPARED BY: ROY K. BALTHIS, LS  
7923 S. MTR. ROAD  
POUND, VA. 24279

17 MAY, 1999

SCALE 1"=100'

LINE	QUADR.	LINE BEARINGS
1.	N	76°12'45"
2.	N	31°13'30"
3.	N	67°39'15"
4.	S	35°11'52"
5.	S	18°52'02"
6.	S	04°01'46"
7.	N	89°55'27"
8.	S	84°14'38"
9.	S	72°17'49"
10.	S	64°22'15"
11.	S	72°09'47"
12.	S	84°30'07"
13.	N	81°46'05"
14.	N	80°26'59"
15.	N	84°35'38"
16.	N	00°32'27"
17.	S	64°22'15"

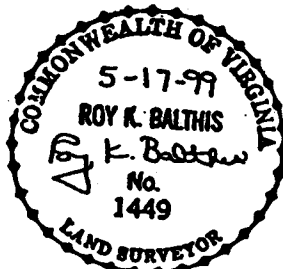

VIRGINIA: IN THE OFFICE OF THE CLERK OF THE CIRCUIT COURT OF DICKENSON COUNTY, presented in said office, and upon the certificate of acknowledgment thereto annexed, admitted to record at 1:10 o'clock P.M. after payment of \$120.00 tax imposed by Sec. 58.1-802. 6-10 1999. This deed was this day

Original returned this date to: *Buddy Waller*

TESTE: JOYNTA CLERK  
BY: *Joynta Clerk* D CLERK