

CLINTWOOD Lumber Supply
 P.O. Box 1217
 CLINTWOOD, VA. 24228

DATE RECORDED 4-9-98
 DEED OR WILL BOOK 334-222
 CONSIDERATION 160,000

CLASS	H	LEGAL DESCRIPTION	HOLLY CREEK
ZONING			2-AC
DISTRICT	6		

DATE RECORDED	
DEED OR WILL BOOK	
CONSIDERATION	
DATE RECORDED	
DEED OR WILL BOOK	
CONSIDERATION	
DATE RECORDED	
DEED OR WILL BOOK	
CONSIDERATION	
DATE RECORDED	
DEED OR WILL BOOK	
CONSIDERATION	

1992			
1993			
1994			
1995			
1996			
1997			
1998			
1999	8,000	43,900	51,900
2000			
2001			
2002			
2003			

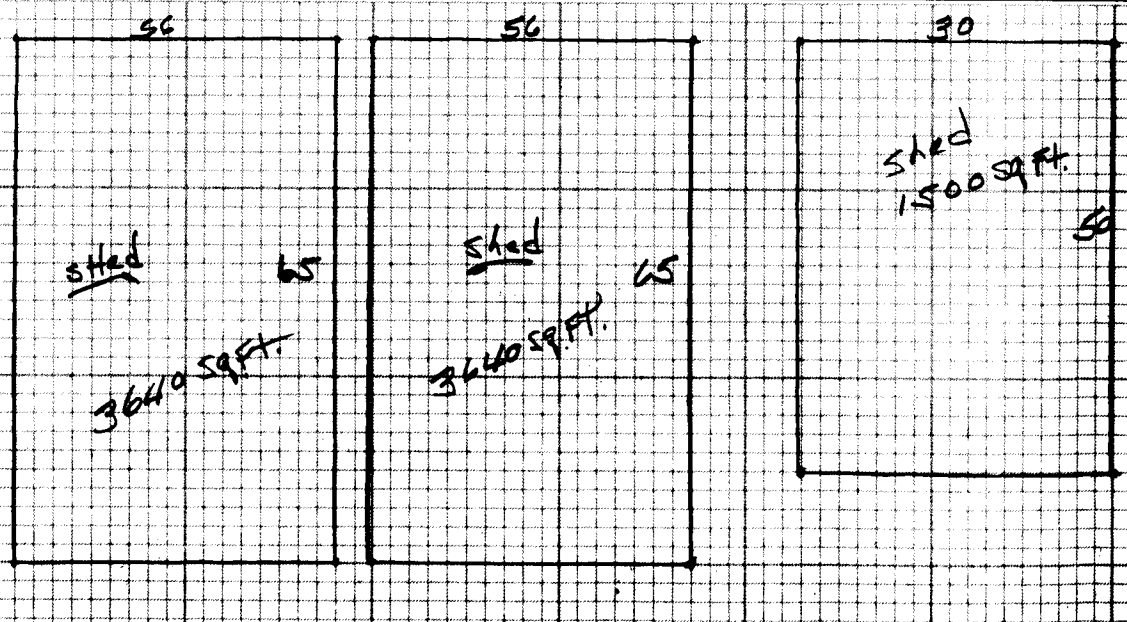

NOTES: FROM BOB + BILLY YATES CARD # 1965

