

~~Equitable Resources Energy Co.~~
~~1989 East Stone Dr~~
~~Kingsport TN 37662~~

Equitable Production Company
 East Region
 1989 East Stone Drive
 Po Box 1983
 Kingsport TN 37662-1983

DATE RECORDED
 DEED OR WILL BOOK
 CONSIDERATION

DATE RECORDED
 DEED OR WILL BOOK
 CONSIDERATION

DATE RECORDED
 DEED OR WILL BOOK
 CONSIDERATION

DATE RECORDED
 DEED OR WILL BOOK
 CONSIDERATION

DATE RECORDED
 DEED OR WILL BOOK
 CONSIDERATION

CLASS 4
 ZONING . . .
 DISTRICT 02

LEGAL DESCRIPTION
 Lick Creek Compressor Facility
 B-16
 ERVINTON DIST
 Imp. ONLY

1992			
1993		1,135,130 1,418,912	1,135,130 1,418,912
1994		1,135,130 1,418,912	1,135,130 1,418,912
1995		1,135,130 1,418,912	1,135,130 1,418,912
1996		1,135,130 1,418,912	1,135,130 1,418,912
1997			
1998			
1999			
2000			
2001			
2002			
2003			

NOTES: Information was provided by EXOC. ON 12-9-96 RR. This Compressor Facility had not been assessed. Evaluations were done for 1993, 1994, 1995 AND 1996 Capital cost Reduced BY 20% RR

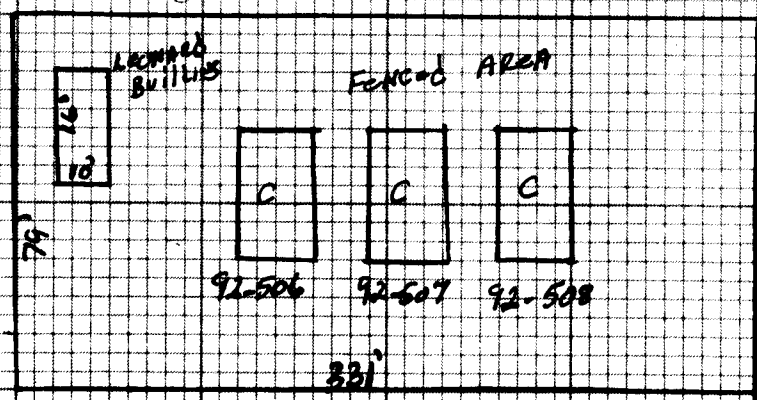

Fresh water Tank
15'
18'



