

MULLINS ZACHARY & GLENNA MAE
RT 2 BOX ~~231A~~ 156-C
CLINTWOOD VA

24228

DATE RECORDED 1-30-87
DEED OR WILL BOOK DB [unclear]
CONSIDERATION 2350

CLASS 2
ZONING
DISTRICT 01

LEGAL DESCRIPTION
GEORGES FORK
1.72AC

| YEAR | VALUE OF LAND | VALUE OF IMPROV. | TOTAL VALUE | TAXES |
|------|---------------|------------------|-------------|-------|
| 1992 | | | | |
| 1993 | | | | |
| 1994 | 3,500 | 25,100 | 28,600 | |
| 1995 | 3,500 | 25,100 | 28,600 | |
| 1996 | | | | |
| 1997 | | | | |
| 1998 | 3,500 | 25,100 | 28,600 | |
| 1999 | | | | |
| 2000 | | | | |
| 2001 | | | | |
| 2002 | | | | |
| 2003 | | | | |

| | |
|-------------------|--|
| DATE RECORDED | |
| DEED OR WILL BOOK | |
| CONSIDERATION | |
| DATE RECORDED | |
| DEED OR WILL BOOK | |
| CONSIDERATION | |
| DATE RECORDED | |
| DEED OR WILL BOOK | |
| CONSIDERATION | |
| DATE RECORDED | |
| DEED OR WILL BOOK | |
| CONSIDERATION | |

BUILDING PERMITS

| NO. | TYPE | DATE | IN COMP. | DATE FINAL | APPROVAL | APPROVAL |
|-----|------|------|----------|------------|----------|----------|
| | | | | | | |
| | | | | | | |
| | | | | | | |

NOTES: VALUE OF MINERALS

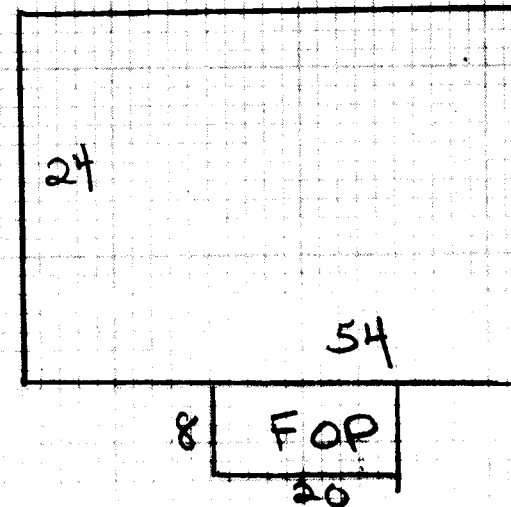

| | | | | | | |
|--|--|--|---|--|--|--|
| Dwelling <input checked="" type="checkbox"/> | Comp. Sh. <input checked="" type="checkbox"/> | Wood Siding <input checked="" type="checkbox"/> | Yr. Built <u>86</u> Remod. <input type="checkbox"/> | Bemt. [] 2nd [] | Plaster | BATH(S) Full <input type="checkbox"/> 1/2 Bath(s) <input type="checkbox"/> |
| Slate | Brick | No. Stories | 1st <u>15</u> 3rd [] | Sheet rock | Modern Bath <input type="checkbox"/> Modern Kitchen <input type="checkbox"/> | |
| Asbestos | Asb. Wood Shg. | S. Level <input type="checkbox"/> S. Foyer <input type="checkbox"/> | Total No. Bedrooms | Ceciled | Cent. Heat <input type="checkbox"/> A/C <input type="checkbox"/> | |
| Metal | Cin. Block <input type="checkbox"/> Stone <input type="checkbox"/> | | | Panel | Fir. or Wall Furnace <input type="checkbox"/> Stove(s) <input type="checkbox"/> | |
| Wood Frame <input checked="" type="checkbox"/> | Tar & Grav. | Stucco <input type="checkbox"/> Con. Block <input type="checkbox"/> | Crawl <input type="checkbox"/> Conc. <input type="checkbox"/> | HW <input type="checkbox"/> Pine <input type="checkbox"/> Carp. <input type="checkbox"/> Tile <input type="checkbox"/> | Unfinished | |
| Cin. Block | Tile | Aluminum <input type="checkbox"/> Masonite <input type="checkbox"/> | Riers <input type="checkbox"/> Cin. Bik. <input type="checkbox"/> | | | |
| Steel Frame | Shakes | Storm Doors <input type="checkbox"/> Storm Win. <input type="checkbox"/> | Slab <input type="checkbox"/> Brick <input type="checkbox"/> | Disappearing Stairs | Gd. <input type="checkbox"/> Fair <input type="checkbox"/> Poor <input type="checkbox"/> VP <input type="checkbox"/> | Number |

| | | | | | |
|--|----------------------|---------------|--|--|------------------------|
| Basement Size <u>NO</u> | Attic Floor & Stairs | Basmt. Finish | 1/4 <input type="checkbox"/> 1/2 <input type="checkbox"/> 3/4 <input type="checkbox"/> Full <input type="checkbox"/> | Attic <input type="checkbox"/> Walls <input type="checkbox"/> Fl. <input type="checkbox"/> | Number Chimneys |
| Gd. <input type="checkbox"/> Fair <input type="checkbox"/> Poor <input type="checkbox"/> VP <input type="checkbox"/> | | | | | Brick [] C. Block [] |
| | | | | | Stone [] Metal [] |

| TYPE | AREA | RATE | VALUE | DATE | VALUE | YR. | MARKET VALUE | MARKET VALUE | MARKET VALUE |
|----------|------|------|-------|------|-------|------|--------------|--------------|--------------|
| ISFR | 1296 | 22 | 28512 | | | 1994 | | | |
| Dwelling | | | | | | | 25919 | 58 | 24600 |
| | | | | | | | | FV | 500 |

| | | | | | | | | | |
|-----------|-----|---|------|--|--|--|--|--|--|
| Porch | 160 | 8 | 1280 | | | | | | |
| Porch | | | | | | | | | |
| Carport | | | | | | | | | |
| Garage | | | | | | | | | |
| Cent. A/C | | | | | | | | | |
| Basement | | | | | | | | | |

| | | | | | |
|--------------|----------------|--------|--|-------------------------------|-------|
| Bemt. Finish | M & L | M & L | MOBILE HOME INFORMATION | Market Value All Improvements | 25100 |
| Attic | DATE | DATE | Owner | Market Value All Land | 3500 |
| Fireplace(s) | APRP. | APRP. | Make Year | TOTAL MARKET VALUE | 28600 |
| Heating | DATE | DATE | Size Cond. | | |
| Bath(s) | CLASSIFICATION | ZONING | Not Home <input type="checkbox"/> Time | | |

| | | | | | |
|-------------|-------|--|--|--|--|
| Total | 29792 | | | | |
| Factor | 87 | | | | |
| Replacement | 25919 | | | | |
| | | | | | |
| | | | | | |

| Percentage | Depth | Square Footage | Unit Price | Depth Factor | Front Ft. Rate | TOTAL | ADJ. | 10 TOTAL APPRAISAL | Unit Price | Depth Factor | Front Ft. Rate | TOTAL | ADJ. | 10 TOTAL APPRAISAL |
|------------|-------|----------------|------------|--------------|----------------|-------|------|--------------------|------------|--------------|----------------|-------|------|--------------------|
| | | | | | | | | | | | | | | |

| | | | | | | | | |
|------------------|--|-------|------|------|------------------|-------|------|------|
| PROPERTY FACTORS | CLASSIFICATION | ACRES | RATE | ADJ. | CLASSIFICATION | ACRES | RATE | ADJ. |
| Utilities | Home Site | 1.72 | | | Home Site | | 3500 | |
| Public Water | Paved | | | | | | | |
| Public Sewer | Gravel <input checked="" type="checkbox"/> | | | | | | | |
| Well | Dir | | | | | | | |
| Spring | No Road | | | | | | | |
| Septic System | Curb & Gutter | | | | | | | |
| U. G. Utilities | Sidewalk | | | | | | | |
| | Wasteland | | | | Wasteland | | | |
| | Total Acreage | 1.72 | | | Total Acreage | | 3500 | |
| | Total Value Land | | | | Total Value Land | | | |

| | | | |
|--------------------------------|------------------------------------|--------------------------------------|------------------|
| LEVEL <input type="checkbox"/> | SLOPES UP <input type="checkbox"/> | SLOPES DOWN <input type="checkbox"/> | General Remarks: |
| LOW <input type="checkbox"/> | STEEP UP <input type="checkbox"/> | STEEP DOWN <input type="checkbox"/> | |

BOARD REVIEW NOTES