

RECORDED OWNERSHIP

CLASS 2  
ZONING  
DISTRICT 05

LEGAL DESCRIPTION  
CANE CREEK  
2.59AC  
\*\*\*

STANLEY SALLY O & ETALS  
~~RT 3 BOX 496~~ BOX 1714  
CLINTWOOD, VA 24228

DATE RECORDED 2-4-72  
DEED OR WILL BOOK 164-117  
CONSID-ERATION YR- SP

10946

|  |                   |  |
|--|-------------------|--|
|  | DATE RECORDED     |  |
|  | DEED OR WILL BOOK |  |
|  | CONSID-ERATION    |  |
|  | DATE RECORDED     |  |
|  | DEED OR WILL BOOK |  |
|  | CONSID-ERATION    |  |
|  | DATE RECORDED     |  |
|  | DEED OR WILL BOOK |  |
|  | CONSID-ERATION    |  |
|  | DATE RECORDED     |  |
|  | DEED OR WILL BOOK |  |
|  | CONSID-ERATION    |  |

|      |      |        |        |
|------|------|--------|--------|
| 1986 | 3000 | 12,500 | 15,500 |
| 1987 | 3000 | 12,500 | 15,500 |
| 1988 | 3000 | 12,500 | 15,500 |
| 1989 | 3000 | 12,500 | 15,500 |
| 1990 | 3000 | 12,500 | 15,500 |
| 1991 | 3000 | 12,500 | 15,500 |
| 1992 |      |        |        |
| 1993 |      |        |        |
| 1994 |      |        |        |
| 1995 |      |        |        |
| 1996 |      |        |        |
| 1997 |      |        |        |

BUILDING PERMITS

|  |  |  |  |  |  |
|--|--|--|--|--|--|
|  |  |  |  |  |  |
|  |  |  |  |  |  |
|  |  |  |  |  |  |

NOTES:

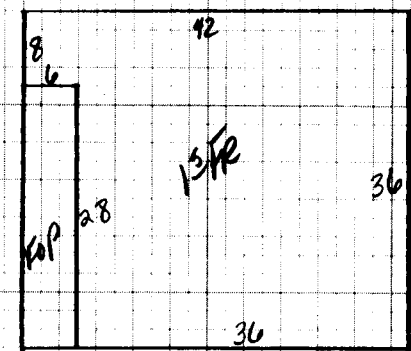

|             |             |                                  |                           |                                    |                                  |                                       |                            |
|-------------|-------------|----------------------------------|---------------------------|------------------------------------|----------------------------------|---------------------------------------|----------------------------|
| Dwelling    | Comp. Sh.   | Wood Siding                      | Yr. Built 201             | Remod.                             | Bsmt. [ ] 2nd [ ]                | Plaster                               | BATH(S) / Full 1/2 Bath(s) |
|             | Slate       | Brick                            | No. Stories               | 1st [5] 3rd [ ]                    | Sheet rock                       | Modern Bath [ ] Modern Kitchen [ ]    |                            |
|             | Asbestos    | Asb. Wood Shg.                   | S. Level [ ] S. Foyer [ ] | Total No. Bedrooms                 | Ceciled                          | Cent. Heat OK A/C                     |                            |
|             | Metal       | Cin. Block [ ] Stone [ ]         |                           |                                    | Panel                            | Fir. or Wall Furnace [ ] Stove(s) [ ] |                            |
| Wood Frame  | Tar & Grav. | Stucco [ ] Con. Block [ ]        | Crawl [ ] Conc. [ ]       | HW [ ] Pine [ ] Carp. [ ] Tile [ ] | Unfinished                       |                                       |                            |
| Cin. Block  | Tile        | Aluminum [ ] Masonite [ ]        | Riers [ ] Cin. Bik. [ ]   |                                    |                                  | Number NO                             |                            |
| Steel Frame | Shakes      | Storm Doors [ ] Storm Win. [ ]   | Slab [ ] Brick [ ]        | Disappearing Stairs                | Gd. [ ] Fair [ ] Poor [ ] VP [ ] | Number Chimneys                       |                            |
|             |             | Basement Size NO                 | Attic Floor & Stairs      |                                    |                                  | Brick [ ] C. Block [ ]                |                            |
|             |             | Gd. [ ] Fair [ ] Poor [ ] VP [ ] | Basmt. Finish             | 1/4 [ ] 1/2 [ ] 3/4 [ ] Full [ ]   | Attic [ ] Walls [ ] Fl. [ ]      | Stone [ ] Metal [ ]                   |                            |

1-AR 1344 30 40,320

YR. 86

|           |                |        |       |        |
|-----------|----------------|--------|-------|--------|
| Dwelling  | E              | 31,248 | -1000 | 12,499 |
| Porch     | UGR WIRE FENCE | 24X22  |       | NV NV  |
| Porch     |                |        |       |        |
| Carport   |                |        |       |        |
| Garage    |                |        |       |        |
| Cent. A/C | PRIVATE RD     |        |       |        |

|              |                |        |                               |        |
|--------------|----------------|--------|-------------------------------|--------|
| Basement     | M & L          | M & L  | Market Value All Improvements | 12,499 |
| Bsmt. Finish | DATE           | DATE   | Market Value All Land         | 3000   |
| Attic        | APRP.          | APRP.  | Owner                         | 15,500 |
| Fireplace(s) | DATE           | DATE   | Make                          |        |
| Heating      | LF             |        | Year                          |        |
| Bath(s)      | DATE           | DATE   | Size                          |        |
|              | 6-19-85        |        | Not Home [ ] Time             |        |
| Total        | 41,664         |        | AM [ ] PM [ ]                 |        |
| Factor       | .75            |        |                               |        |
| Replacement  | 31,248         |        |                               |        |
|              | CLASSIFICATION | ZONING |                               |        |
|              | 2              |        |                               |        |

|            |  |
|------------|--|
| Land Cost  |  |
| Bldg. Cost |  |
| Sale Price |  |
| Rent       |  |
| Expenses   |  |
| Net Rent   |  |

| PROPERTY FACTORS | CLASSIFICATION | ACRES | RATE | ADJ. | CLASSIFICATION | ACRES | RATE | ADJ. |
|------------------|----------------|-------|------|------|----------------|-------|------|------|
| Public Water     | Home Site      | 2.59  |      |      | Home Site      |       |      |      |
| Public Sewer     |                |       |      |      |                |       |      |      |
| Well             |                |       |      |      |                |       |      |      |
| Spring           |                |       |      |      |                |       |      |      |
| Septic System    | Wasteland      |       |      |      | Wasteland      |       |      |      |
| U. G. Utilities  |                | 2.59  |      |      |                |       |      |      |
|                  |                |       |      |      |                |       |      |      |

General Remarks:

LEVEL [ ] SLOPES UP [ ] SLOPES DOWN [ ]

LOW [ ] STEEP UP [ ] STEEP DOWN [ ]

BOARD REVIEW NOTES