

~~SUTHERLAND EULIS L & ANNA~~  
~~C/O CHERYL A HILL~~ *Judy Marshall*  
~~HCO 5 BOX 667 Rt. 1 Box 494~~  
~~GOEBURN VA Clinched, Va.~~  
*24230*  
*24226*

DATE RECORDED *5-3-83*  
 DEED OR WILL BOOK *DB 216-263*  
 CONSIDERATION *2000*

*Marshall, Richard & Judy*  
*Rt 1 Box 494*  
*Clinched, VA 24224*

DATE RECORDED *7/13/98*  
 DEED OR WILL BOOK *337-1*  
 CONSIDERATION *2 tract 41,500*

DATE RECORDED  
 DEED OR WILL BOOK  
 CONSIDERATION

DATE RECORDED  
 DEED OR WILL BOOK  
 CONSIDERATION

DATE RECORDED  
 DEED OR WILL BOOK  
 CONSIDERATION

BUILDING PERMITS

NO.	TYPE	DATE	% COMP.	DATE FINAL	APPRAISAL	APPRAISAL

NOTES:  
 \_\_\_\_\_  
 \_\_\_\_\_  
 \_\_\_\_\_  
 \_\_\_\_\_

CLASS *2*  
 ZONING  
 DISTRICT *02*  
 LEGAL DESCRIPTION  
 CROOKED BRANCH  
 2.60 AC

YEAR	VALUE OF LAND	VALUE OF IMPROV.	TOTAL VALUE	
1992				
1993				
1994	2,500		2,500	
1995	2,500	26000	28,500-	
1996				
1997				
1998				
1999				
2000				
2001				
2002				
2003				

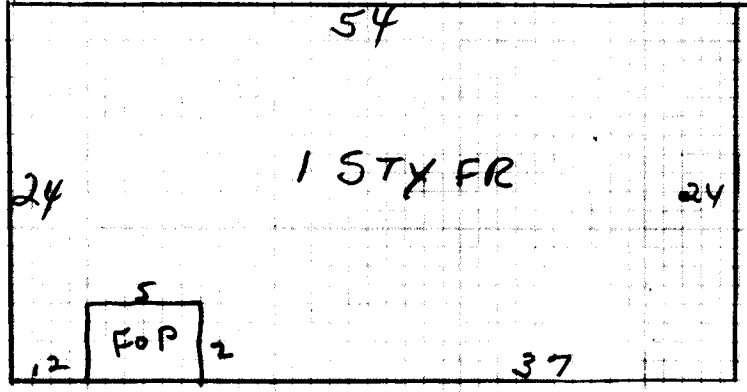

Dwelling	Comp. Sh.	Wood Siding	Yr. Built	Remod.	Bsmt. [ ] 2nd [ ]	Plaster	BATH(S) Full 1/2 Bath(s)
	Slate	Brick	No. Stories		1st [ ] 3rd [ ]	Sheet rock	Modern Bath <input type="checkbox"/> Modern Kitchen <input type="checkbox"/>
	Asbestos	Asb. Wood Shg.	S. Level <input type="checkbox"/> S. Foyer <input type="checkbox"/>		Total No. Bedrooms	Ceciled	Cent. Heat <input type="checkbox"/> A/C <input type="checkbox"/>
	Metal	Cin. Block <input type="checkbox"/> Stone <input type="checkbox"/>				Panel	Fir. or Wall Furnace <input type="checkbox"/> Stove(s) <input type="checkbox"/>
Wood Frame	Tar & Grav.	Stucco <input type="checkbox"/> Con. Block <input type="checkbox"/>	Crawl <input type="checkbox"/> Conc. <input type="checkbox"/>	HW <input type="checkbox"/> Pine <input type="checkbox"/> Carp. <input type="checkbox"/> Tile <input type="checkbox"/>	Unfinished		
Cin. Block	Tile	Aluminum <input type="checkbox"/> Masonite <input type="checkbox"/>	Riers <input type="checkbox"/> Cin. Blk. <input type="checkbox"/>				
Steel Frame	Shakes	Storm Doors <input type="checkbox"/> Storm Win. <input type="checkbox"/>	Slab <input type="checkbox"/> Brick <input type="checkbox"/>	Disappearing Stairs	Gd. <input type="checkbox"/> Fair <input type="checkbox"/> Poor <input type="checkbox"/> VP <input type="checkbox"/>		Number

ITEM	SIZE	RATE	VALUE	RATE	VALUE	Gd. <input type="checkbox"/> Fair <input type="checkbox"/> Poor <input type="checkbox"/> VP <input type="checkbox"/>	Basement Size	Attic Floor & Stairs	Brick [ ] C. Block [ ]
							Basmt. Finish	1/4 <input type="checkbox"/> 1/2 <input type="checkbox"/> 3/4 <input type="checkbox"/> Full <input type="checkbox"/>	Stone [ ] Metal [ ]

USE	DESCRIPTION	SIZE	GRADE	AGE	RATE	REPLACEMENT	COND.	DEPR.	YR.	YR.	YR.
Dwelling									94		
Porch											
Porch											
Carport											
Garage											
Cent. A/C											

*House moved from Carl # 12937 IMP ONLY*

Bsmt. Finish	M & L	M & L	MOBILE HOME INFORMATION	Market Value All Improvements	26,000
Attic	DATE	DATE	Owner	Market Value All Land	2500
Fireplace(s)	APPR. <i>M.S.</i>	APPR.	Make	TOTAL MARKET VALUE	2500
Heating	DATE <i>1-27-94</i>	DATE	Size	Cond.	
Bath(s)	CLASSIFICATION <i>2</i>	ZONING	Not Home <input type="checkbox"/> Time	AM <input type="checkbox"/> PM <input type="checkbox"/>	

FRONTAGE		DEPTH	SQUARE FOOTAGE	UNIT PRICE	DEPTH FACTOR	FRONT FT. RATE	TOTAL	ADJ.	IS <i>34</i>	UNIT PRICE	DEPTH FACTOR	FRONT FT. RATE	TOTAL	ADJ.	IS
									2000						
									500						
									2500						

PROPERTY FACTORS	CLASSIFICATION	ACRES	RATE	ADJ.	CLASSIFICATION	ACRES	RATE	ADJ.
Utilities	Home Site	1			Home Site			
Public Water	Paved	1.6	300					
Public Sewer	Gravel							
Well	Dirt							
Spring	No Road							
Septic System	Curb & Gutter							
U. G. Utilities	Sidewalk	2.6						

General Remarks: *House site grown up*

LEVEL <input type="checkbox"/>	SLOPES UP <input type="checkbox"/>	SLOPES DOWN <input type="checkbox"/>
LOW <input type="checkbox"/>	STEEP UP <input type="checkbox"/>	STEEP DOWN <input type="checkbox"/>

Property and Income Information	
Land Cost	
Bldg. Cost	
Sale Price	
Rent	
Expenses	
Net Rent	

BOARD REVIEW NOTES