

**DEED RECORDED
RT 2 BOX 126
HAYSI VA**

24256

CLASS	2	LEGAL DESCRIPTION GREENBRIAR SAC		
ZONING				
DISTRICT	04			

DATE RECORDED	
DEED OR WILL BOOK	<i>n/a</i>
CONSIDERATION	
DATE RECORDED	
DEED OR WILL BOOK	
CONSIDERATION	
DATE RECORDED	
DEED OR WILL BOOK	
CONSIDERATION	
DATE RECORDED	
DEED OR WILL BOOK	
CONSIDERATION	
DATE RECORDED	
DEED OR WILL BOOK	
CONSIDERATION	

1992	<i>4600</i>	<i>21800</i>	<i>26400</i>	
1993	<i>4600</i>	<i>21800</i>	<i>26,400</i>	
1994				
1995				
1996				
1997				
1998				
1999				
2000				
2001				
2002				
2003				

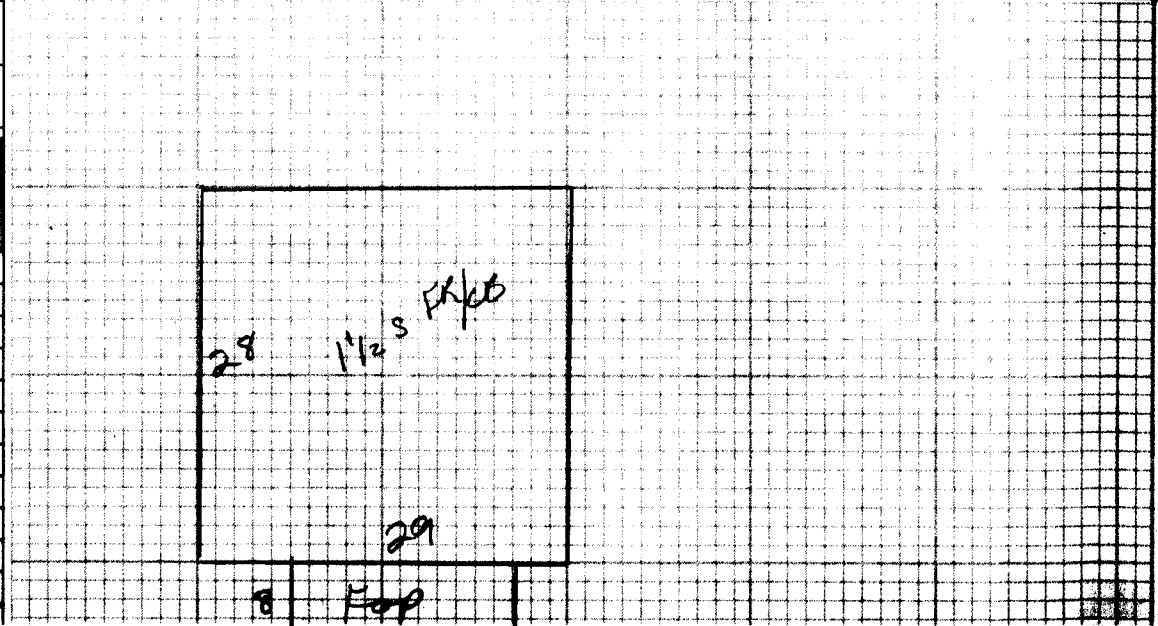

NOTES:

Roofing	Comp. Sh.	Wood Siding	Yr. Built 50	Remod. 76	Basmt. 1 2nd 2	Plaster	BATHES Full 1/2 Bathing
	Slate	Brick	No. Stories 1 1/2		1st 3rd 1	Sheet rock	Modern Bath Modern Kitchen
	Asbestos	Asb. Wood Shg.	B. Level S. Floor		Total No. Bedrooms	Ceclied	Cent. Heat oil AG
	Metal	Cin. Block Stone				Panel	Fir. or Wall Furnace
Wood Frame	Tar & Grav.	Stucco Con. Block	Crawl Conc.		HW Pine Carp. Tile	Unfinished	
Cin. Block	Tile	Aluminum Masonite	Riers Cin. Blk.				Number 70
Steel Frame	Shakes	Storm Doors Storm Win.	Slab Brick		Disappearing Stairs	Gd. Fair Poor VP	Number Chimneys
			Basement Size 1/2		Attic Floor & Stairs		Brick C. Block
			Gd. Fair Poor VP		Basmt. Finish	1/4 1/2 3/4 Full	Stone Metal

1/2 Fcks	1218	30	26540
Porch	128	6	768
Basement	406	6.5	2639
Total			39947
Factor			.87
Replacement			34753

Dwelling	D	34753	45%	1911
	15 FR GARAGE 18x40 PD			FV 2000
				FV 700
M & L	M & L	DATE	DATE	Market Value All Improvements 21800
APRP. KS	APRP.	APRP. 1-17-91	DATE	Market Value All Land 4600
CLASSIFICATION 2	ZONING	Not Home	Time AM PM	TOTAL MARKET VALUE 26400
		Agric.		Land Cost \$
		Hort.		Bldg. Cost \$
		Forest		\$
		Open Space		Expenses \$
		Totals		Net Rent \$
				Net Rent \$
				BOARD REVIEW NOTES

	CLASSIFICATION	ACRES	RATE	ADJ.		CLASSIFICATION	ACRES	RATE	ADJ.
Public Water Paved	Home Site	1			2500	Home Site			
Public Sewer	Home Site	7	300		2100				
Well	Wasteland	8			4600				

General Remarks:

LEVEL SLOPE UP SLOPE DOWN

LOW STEEP UP STEEP DOWN