

~~WENS FERL & GLENNA~~  
~~T 2 BOX 524~~  
~~HAYSI VA~~

24256

ROON JAMES E & LINDA K.  
 PO BOX 162  
 HAYSI, VA. 24256

DATE RECORDED 5-57  
 DEED OR WILL BOOK DB 0113 0128  
 CONSIDERATION

DATE RECORDED 3-11-96  
 DEED OR WILL BOOK 315-696  
 CONSIDERATION <sup>2 tracts</sup> 35000

DATE RECORDED  
 DEED OR WILL BOOK  
 CONSIDERATION

DATE RECORDED  
 DEED OR WILL BOOK  
 CONSIDERATION

DATE RECORDED  
 DEED OR WILL BOOK  
 CONSIDERATION

CLASS 2  
 ZONING  
 DISTRICT 04

LEGAL DESCRIPTION  
 LAUREL BRANCH  
 3AC

|      |       |        |        |
|------|-------|--------|--------|
| 1992 |       |        |        |
| 1993 |       |        |        |
| 1994 | 3,600 | 35,500 | 39,100 |
| 1995 | 3,600 | 35,500 | 39,100 |
| 1996 |       |        |        |
| 1997 |       |        |        |
| 1998 |       |        |        |
| 1999 |       |        |        |
| 2000 |       |        |        |
| 2001 |       |        |        |
| 2002 |       |        |        |
| 2003 |       |        |        |

NOTES:

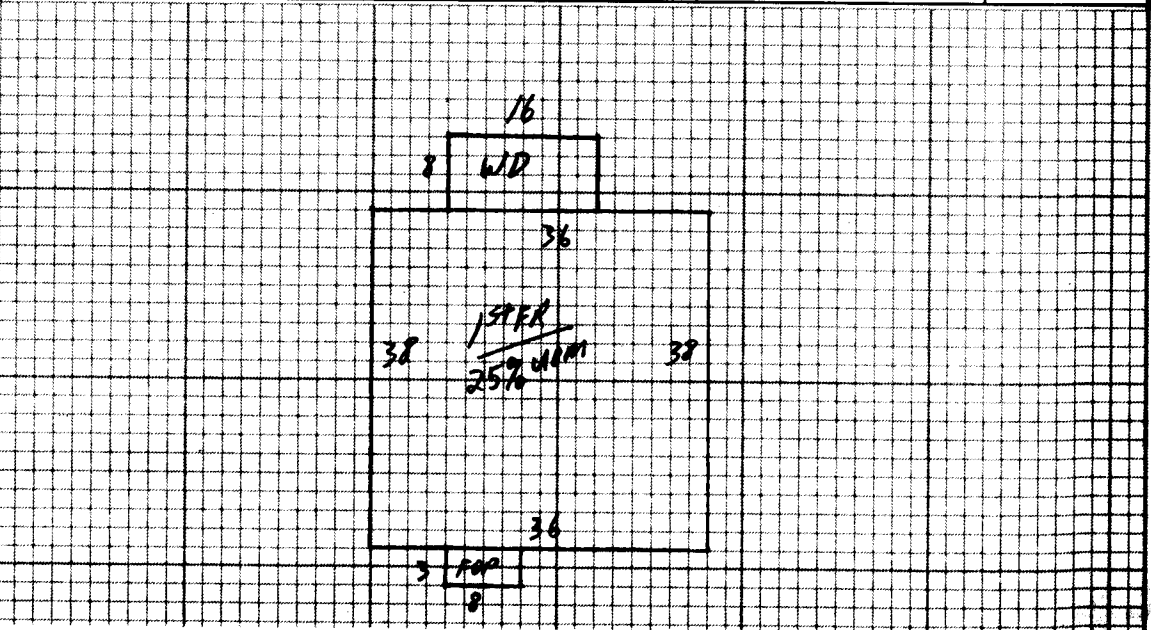

|             |                                     |             |                                     |  |  |   |  |   |   |   |
|-------------|-------------------------------------|-------------|-------------------------------------|--|--|---|--|---|---|---|
| Dwelling    | <input checked="" type="checkbox"/> | Comp. Sh.   | <input checked="" type="checkbox"/> | Wood Siding  |  | Yr. Built <u>57</u> Remod. <u>78</u>                                | Basmt. <input type="checkbox"/> 2nd <input type="checkbox"/>   | Plaster   |   | BATHS / Full <input type="checkbox"/> 1/2 Baths <input type="checkbox"/>        |
|             |                                     | Slate       |                                     | Brick  |  | No. Stories <u>1</u>  | 1st <input checked="" type="checkbox"/> 3rd <input type="checkbox"/>   | Sheet rock  | <input checked="" type="checkbox"/>   | Modern Bath <input type="checkbox"/> Modern Kitchen <input type="checkbox"/>    |
|             |                                     | Asbestos    |                                     | Asb. Wood Shg.   |  | S. Level <input type="checkbox"/> S. Foyer <input type="checkbox"/> | Total No. Bedrooms   | Ceiled  |   | Cent. Heat <u>COAL</u> A/C <u>NO</u>  |
|             |                                     | Metal       |                                     | Cin. Block <input type="checkbox"/> Stone <input type="checkbox"/>             |  |   |  | Panel   | <input checked="" type="checkbox"/>   | Fir. or Wall Furnace <input type="checkbox"/> Stove(s) <input type="checkbox"/> |
| Wood Frame  | <input checked="" type="checkbox"/> | Tar & Grav. |                                     | Stucco <input type="checkbox"/> Con. Block <input type="checkbox"/>            |  | Crawl <input type="checkbox"/> Conc. <input type="checkbox"/>       | HW <input type="checkbox"/> Pile <input type="checkbox"/> Comp. <input type="checkbox"/> Tile <input type="checkbox"/> | Unfinished  |   | Number <u>NO</u>  |
| Cin. Block  |                                     | Tile        |                                     | Aluminum <input type="checkbox"/> Masonite <input checked="" type="checkbox"/> |  | Piers <input type="checkbox"/> Cin. Blk. <input type="checkbox"/>   |  |   |   | Number Chimneys   |
| Steel Frame |                                     | Shakes      |                                     | Storm Doors <input type="checkbox"/> Storm Win. <input type="checkbox"/>       |  | Slab <input type="checkbox"/> Brick <input type="checkbox"/>        | Disappearing Stairs  | Gd. <input type="checkbox"/> Fair <input checked="" type="checkbox"/> Poor <input type="checkbox"/> VP <input type="checkbox"/> |   | Brick <input type="checkbox"/> C. Block <input type="checkbox"/>                |
|             |                                     |             |                                     | Basement Size <u>25'0"</u>   |  | Attic Floor & Stairs  |  | Basmt. Finish   | <input type="checkbox"/> Gd. <input type="checkbox"/> Fair <input type="checkbox"/> Poor <input type="checkbox"/> VP <input type="checkbox"/> | Stone <input type="checkbox"/> Metal <input type="checkbox"/>                   |
|             |                                     |             |                                     |  |  |   |  |   | YR. <u>94</u>   | YR.   |

FR 1368 335 45828

|              |  |  |  |          |  |              |            |                |  |
|--------------|--|--|--|----------|--|--------------|------------|----------------|--|
| Dwelling     |  |  |  | <u>D</u> |  | <u>42472</u> | <u>20%</u> | <u>33978</u>   |  |
|              |  |  |  |          |  |              |            | <u>FV 1500</u> |  |
| WD 128 6 768 |  |  |  |          |  |              |            |                |  |

15' CB Bldg  
15' FR UCP

|             |                    |                |        |  |              |
|-------------|--------------------|----------------|--------|--|--------------|
| ement       | <u>342 65 2223</u> | M & L          | M & L  | Market Value All Improvements                                      | <u>35500</u> |
| mt. Finish  |                    | DATE           | DATE   | Market Value All Land  | <u>3600</u>  |
| ic          |                    | APRP.          | APRP.  | Size   | Cond.        |
| place(s)    |                    | <u>MS</u>      |        | Not Home <input type="checkbox"/> Time                             |              |
| ating       |                    | DATE           | DATE   | AM <input type="checkbox"/> PM <input checked="" type="checkbox"/> |              |
| h(s)        |                    | CLASSIFICATION | ZONING | Agric.   |              |
| Total       | <u>48819</u>       |                |        | Hort.  |              |
| Factor      | <u>87</u>          |                |        | Forest   |              |
| Replacement | <u>42472</u>       |                |        | Open Space   |              |
|             |                    |                |        | Totals   |              |

|            |  |
|------------|--|
| Land Cost  |  |
| \$         |  |
| Bldg. Cost |  |
| \$         |  |
| Sale Price |  |
| \$         |  |
| Rent       |  |
| \$         |  |
| Expenses   |  |
| \$         |  |
| Net Rent   |  |
| \$         |  |

| CLASSIFICATION | ACRES    | RATE       | ADJ.        | CLASSIFICATION | ACRES | RATE | ADJ.        |
|----------------|----------|------------|-------------|----------------|-------|------|-------------|
| Home Site      | <u>1</u> |            |             | Home Site      |       |      |             |
| <u>woods</u>   | <u>2</u> | <u>300</u> |             |                |       |      |             |
|                |          |            | <u>3000</u> |                |       |      | <u>600</u>  |
| Wasteland      |          |            |             | Wasteland      |       |      |             |
|                | <u>3</u> |            |             |                |       |      | <u>3600</u> |

Public Water  Paved   
 Public Sewer  Gravel   
 Oil  Dirt   
 Driveway  No Road   
 Septic System  Curb & Gutter   
 Sidewalk

General Remarks:

SLOPES UP  SLOPES DOWN   
 STEEP UP  STEEP DOWN

BOARD REVIEW NOTES