

SANDLICK DISTRICT

00000000007593

O'QUINN PEGGY  
BOX 289  
HAYSI VA

24256

DATE RECORDED 3-25-88  
DEED OR WILL BOOK DB 0250 0145  
CONSIDERATION 56,080.67

STANLEY, CHARLES SCOTT  
PO BOX #2264  
HAYSI, VA 24256

DATE RECORDED 9-8-94  
DEED OR WILL BOOK 303-523  
CONSIDERATION 40000

CLASS 2  
ZONING  
DISTRICT 04

LEGAL DESCRIPTION  
WHITES BRANCH BIG RIDGE  
.68AC  
178 - 178 A (A) 1562

1992			
1993			
1994	5,500	55,700	61,200
1995	5,500	55,700	61,200
1996			
1997			
1998			
1999			
2000			
2001			
2002			
2003			

BUILDING PERMITS

NO.	TYPE	DATE	SCOPE	STATUS

NOTES: Changed address per Roger Stanley 3-2-00

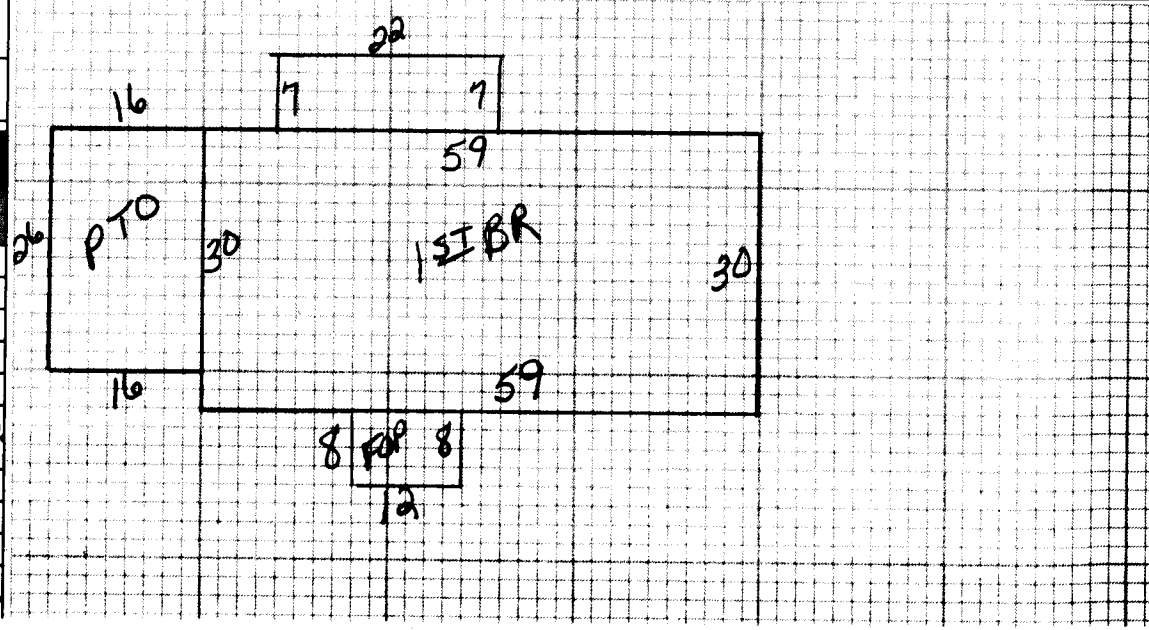

Dwelling	<input checked="" type="checkbox"/>	Comp. Sh.	<input checked="" type="checkbox"/>	Wood Siding		Yr. Built	72	Remod.		Bmnt.	[ ]	2nd	[ ]	Plaster		BATH(S)	Full	1/2 Bath(s)			
		Slate		Brick	<input checked="" type="checkbox"/>	No. Stories	1			1st	6	3rd	[ ]	Sheet rock	<input checked="" type="checkbox"/>	Modern Bath	<input type="checkbox"/>	Modern Kitchen	<input type="checkbox"/>		
		Asbestos		Asb. Wood Shg.		S. Level	<input type="checkbox"/>	S. Foyer	<input type="checkbox"/>	Total No. Bedrooms				Ceciled		Cent. Heat	012	A/C	NO		
		Metal		Cin. Block	<input type="checkbox"/>	Stone	<input type="checkbox"/>							Panel	<input checked="" type="checkbox"/>	Fir. or Wall Furnace	<input type="checkbox"/>	Stove(s)	<input type="checkbox"/>		
Wood Frame	<input checked="" type="checkbox"/>	Tar & Grav.		Stucco	<input type="checkbox"/>	Con. Block	<input type="checkbox"/>	Crawl	<input type="checkbox"/>	Conc.	<input type="checkbox"/>	HW	<input type="checkbox"/>	Pine	<input type="checkbox"/>	Carp.	<input checked="" type="checkbox"/>	Tile	<input type="checkbox"/>		
Cin. Block		Tile		Aluminum	<input type="checkbox"/>	Masonite	<input type="checkbox"/>	Riers	<input type="checkbox"/>	Cin. Blk.	<input type="checkbox"/>			Unfinished							
Steel Frame		Shakes		Storm Doors	<input type="checkbox"/>	Storm Win.	<input type="checkbox"/>	Slab	<input type="checkbox"/>	Brick	<input type="checkbox"/>	Disappearing Stairs		Gd.	<input type="checkbox"/>	Fair	<input type="checkbox"/>	Poor	<input type="checkbox"/>	VP	<input type="checkbox"/>

1st BR 177034 60180

P70 416 3 1248  
 Porch 96 8 768  
 Porch 154 7 1078

Carport  
 Garage  
 Cent. A/C  
 Basement  
 Bmnt. Finish  
 Attic  
 Fireplace(s)  
 Heating  
 Bath(s)

Total 63274  
 Factor 10  
 Replacement 63274

Gd.	<input checked="" type="checkbox"/>	Fair	<input type="checkbox"/>	Poor	<input type="checkbox"/>	VP	<input type="checkbox"/>	Basement Size	70	Attic Floor & Stairs		Brick	[ ]	C. Block	[ ]	Stone	[ ]	Metal	[ ]
Basmt. Finish		1/4	<input type="checkbox"/>	1/2	<input type="checkbox"/>	3/4	<input type="checkbox"/>	Full	<input type="checkbox"/>	Attic	<input type="checkbox"/>	Walls	<input type="checkbox"/>	Fl.	<input type="checkbox"/>	YR.	94	YR.	

Dwelling																			

M & L		M & L		Market Value All Improvements	55681
DATE		DATE		Market Value All Land	5500
APRP.	M 5	APRP.		Market Value All Other	61200
DATE	2-25-94	DATE			
CLASSIFICATION	2	ZONING			

CONTIN.																			
---------	--	--	--	--	--	--	--	--	--	--	--	--	--	--	--	--	--	--	--

PROPERTY FACTORS																			
Public Water	Paved	<input checked="" type="checkbox"/>	CLASSIFICATION	Home Site	2 TR.	ACRES	.68	RATE		ADJ.		CLASSIFICATION	Home Site	ACRES		RATE		ADJ.	
Public Sewer	Gravel										5500								
Well	Dir	<input checked="" type="checkbox"/>																	
Spring	No Road																		
Septic System	Curb & Gutter	<input checked="" type="checkbox"/>																	
U. G. Utilities	Sidewalk																		

General Remarks:

LEVEL  SLOPES UP  SLOPES DOWN   
 LOW  STEEP UP  STEEP DOWN

BOARD REVIEW NOTES