

REBBITTS, GERALD
 RT 2 BOX 158
 CLINTWOOD, VA. 24228

DATE RECORDED 8-6-56
 DEED OR WILL BOOK 111-59
 CONSIDERATION YR-
 SE

CLASS 2
 ZONING
 DISTRICT 01

LEGAL DESCRIPTION
 GEORGES FORK
 8.74AC ***

00827

DATE RECORDED
 DEED OR WILL BOOK
 CONSIDERATION

DATE RECORDED
 DEED OR WILL BOOK
 CONSIDERATION

DATE RECORDED
 DEED OR WILL BOOK
 CONSIDERATION

DATE RECORDED
 DEED OR WILL BOOK
 CONSIDERATION

| | | | |
|------|----------------------|--------|--------|
| 1986 | 9900 | 32100 | 42000 |
| 1987 | 8870 | 28300 | 37200 |
| 1988 | 8870 | 28300 | 37200 |
| 1989 | 8,870 | 28,300 | 37,200 |
| 1990 | 8870 | 28300 | 37200 |
| 1991 | 8870 ⁸⁹⁰⁰ | 28300 | 37200 |
| 1992 | | | |
| 1993 | | | |
| 1994 | | | |
| 1995 | | | |
| 1996 | | | |
| 1997 | | | |

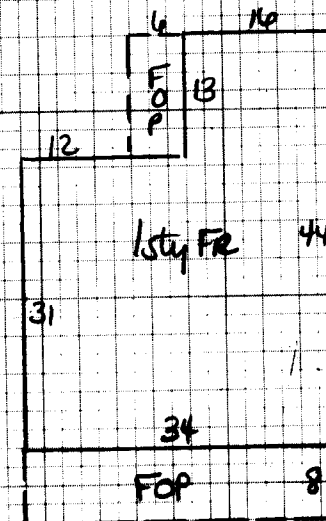

NOTES:

| | | | | | | |
|-------------|-------------|--|--|---|--|---|
| Dwelling | Comp. Sh. | Wood Siding | Yr. Built 50 Remod. | Bmnt. [] 2nd [] | Plester | BATH(S) / Full 1/2 Bath(s) |
| | Slate | Brick | No. Stories 1 | 1st 16 3rd [] | Sheet rock | Modern Bath <input type="checkbox"/> Modern Kitchen <input type="checkbox"/> |
| | Asbestos | Aab. Wood Shg. | B. Level <input type="checkbox"/> B. Foyer <input type="checkbox"/> | Total No. Bedrooms | Cooled | Cent. Heat COAL A/C |
| | Metal | Cin. Block <input type="checkbox"/> Stone <input type="checkbox"/> | | | Panel | Fir. or Wall Furnace <input type="checkbox"/> Stove(s) <input type="checkbox"/> |
| Wood Frame | Tar & Grav. | Stucco <input checked="" type="checkbox"/> Con. Block <input type="checkbox"/> | Crawl <input type="checkbox"/> Conc. <input type="checkbox"/> | HW <input type="checkbox"/> Pine <input type="checkbox"/> Carp. <input checked="" type="checkbox"/> Tile <input type="checkbox"/> | Unfinished | |
| Cin. Block | Tile | Aluminum <input checked="" type="checkbox"/> Masonite <input type="checkbox"/> | Riers <input type="checkbox"/> Cin. Blk. <input checked="" type="checkbox"/> | | | Number NO |
| Steel Frame | Shakes | Storm Doors <input type="checkbox"/> Storm Win. <input type="checkbox"/> | Slab <input type="checkbox"/> Brick <input checked="" type="checkbox"/> | Disappearing Stairs | Gd. <input type="checkbox"/> Fair <input type="checkbox"/> Poor <input type="checkbox"/> VP <input type="checkbox"/> | Number Chimneys |
| | | | Basement Size NO | Attic Floor & Stairs | | Brick [] C. Block [] |
| | | Gd. <input type="checkbox"/> Fair <input type="checkbox"/> Poor <input type="checkbox"/> VP <input type="checkbox"/> | Bmnt. Finish | 1/4 <input type="checkbox"/> 1/2 <input type="checkbox"/> 3/4 <input type="checkbox"/> Full <input type="checkbox"/> | Attic <input type="checkbox"/> Walls <input type="checkbox"/> Fl. <input type="checkbox"/> | Stone [] Metal [] |

154y 1002 385 38491 YR. **80** YR. YR.

| | | | | | |
|---|-------------------|---------------------|--------------|-------------|--------------|
| Dwelling | | D+ | 37987 | 20% | 30289 |
| | | | | -30% | 26600 |
| Porch <input checked="" type="checkbox"/> | 350 8 2800 | CB GAR | 24x26 | | 1400 |
| Porch | | 2sty CB BLDG | | | 300 |
| Carport | | STG BLDG | | | NV |
| Garage | | | | | |
| Cent. A/C | | | | | 28300 |

| | | | |
|--------------------------|-------------------------|---|--------------------|
| M & L | M & L | Market Value All Improvements | 32700 |
| DATE | DATE | Market Value All Land | 9900 8870 |
| APRP. DD | APRP. | Size | 42000 37200 |
| DATE 2-27-85 | DATE | Not Home <input checked="" type="checkbox"/> Time | |
| Factor .92 | CLASSIFICATION 2 | ZONING | |
| Replacement 37987 | | | |

| | | | |
|-------------|--------------|------------|--|
| Total | 41291 | Land Cost | |
| Factor | .92 | Bldg. Cost | |
| Replacement | 37987 | Sale Price | |
| | | Expenses | |
| | | Net Rent | |
| | | | |

| CLASSIFICATION | ACRES | RATE | ADJ. | CLASSIFICATION | ACRES | RATE | ADJ. |
|----------------|-------------|------------|------|----------------|-------|------|------|
| Home Site | 1 | | | Home Site | | | |
| | 7.74 | 500 | | | | | |
| | | | | | | | |
| Wasteland | | | | Wasteland | | | |
| | 8.74 | | | | | | |
| | | | | | | | |

General Remarks:

LEVEL SLOPES UP SLOPES DOWN

LOW STEEP UP STEEP DOWN

BOARD REVIEW NOTES