

~~FULLER KURKE~~
~~DRAWER 1~~
~~NAYSI, VA 24256~~

DATE RECORDED	4/75
DEED OR WILL BOOK	190-290
CONSIDERATION	YR - SE

07694

Fuller, Ruth Ann
Drawer 1
Naysi, Va 24256

DATE RECORDED	4-8-87
DEED OR WILL BOOK	244-75
CONSIDERATION	<i>Gift</i>

DATE RECORDED	
DEED OR WILL BOOK	
CONSIDERATION	

DATE RECORDED	
DEED OR WILL BOOK	
CONSIDERATION	

DATE RECORDED	
DEED OR WILL BOOK	
CONSIDERATION	

BUILDING PERMITS

NOTES: 48,300 1,230,200
Office Moved to Card # 17911
3 Tracts to Carlomin Corp D.B 272-731

CLASS	4	LEGAL DESCRIPTION	PRATER CREEK
ZONING			58 TRACTS
DISTRICT	04		3.833 AC
			1.80

1986	29,500	4,280,800	1,310,300
1987	35700	1,533,000	1,568,700
1988	35700	1,533,000	1,568,700
1989	21,000	41,800	62,800
1990	21000	41800	62800
1991	21000		21000
1992	7100	—	7100
1993			
1994			
1995			
1996			
1997			

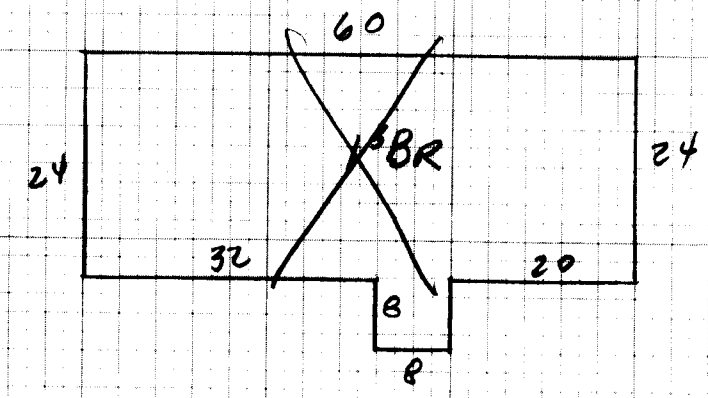

Dwelling	Comp. Sh.	<input checked="" type="checkbox"/> Wood Siding	Yr. Built 70 Remod.	Bsmt. [] 2nd []	Plaster	BATH(S) Full <input checked="" type="checkbox"/> 1/2 Bath(s)
OFFICE D.H. <input checked="" type="checkbox"/>	Slate	Brick <input checked="" type="checkbox"/>	No. Stories 1	1st 5 3rd []	Sheet rock	Modern Bath <input type="checkbox"/> Modern Kitchen <input type="checkbox"/>
	Asbestos	Asb. Wood Shg.	S. Level <input type="checkbox"/> S. Foyer <input type="checkbox"/>	Total No. Bedrooms	Ceciled	Cent. Heat HEAT A/C PUMP
	Metal	Cin. Block <input type="checkbox"/> Stone <input checked="" type="checkbox"/>			Panel	Fir. or Wall Furnace <input type="checkbox"/> Stove(s) <input type="checkbox"/>
Wood Frame <input checked="" type="checkbox"/>	Tar & Grav.	Stucco <input type="checkbox"/> Con. Block <input type="checkbox"/>	Crawl <input type="checkbox"/> Conc. <input type="checkbox"/>	HW <input type="checkbox"/> Pine <input type="checkbox"/> Carp. <input type="checkbox"/> Tile <input type="checkbox"/>	Unfinished	
Cin. Block	Tile	Aluminum <input type="checkbox"/> Masonite <input type="checkbox"/>	Riers <input type="checkbox"/> Cin. Blk. <input type="checkbox"/>			
Steel Frame	Shakes	Storm Doors <input type="checkbox"/> Storm Win. <input type="checkbox"/>	Slab <input type="checkbox"/> Brick <input type="checkbox"/>	Disappearing Stairs	Gd. <input type="checkbox"/> Fair <input checked="" type="checkbox"/> Poor <input type="checkbox"/> VP <input type="checkbox"/>	Number NO
				Attic Floor & Stairs		Number Chimneys
				Basement Finish	Basmt. Finish	Brick [] C. Block []
						Stone [] Metal []
						YR. 86 YR. YR.

1 BR. 1504 3.72 47,706

*Office
structure
to
card #
17911*

Dwelling	OFFICE	DT	49,210	-15%	41,829		
Porch							
Porch							
Carport							
Garage							
Cent. A/C	1504 1	1504					
Basement							
Bsmt. Finish							
Attic							
Fireplace(s)							
Heating							
Bath(s)							
Total							
Factor							
Replacement		49,210					

BELT + STRUCTURE APPROX 300'
PLANT APPROX 90 TPA @ 22,500/yr
SCALES 37,500

M & L	M & L	MOBILE HOME INFORMATION	Market Value All Improvements	1,280,829	1,533,000	41,187
DATE	DATE	Owner	Market Value All Land	29,500	35,700	20,150
APRP.	APRP.	Make		1,310,329	1,568,700	62,337
DATE	DATE	Size				
CLASSIFICATION	ZONING	Not Home <input type="checkbox"/> Time				
4		AM <input checked="" type="checkbox"/> PM <input type="checkbox"/>				

DATE	DATE
9/10/85	
CLASSIFICATION	ZONING
4	

FRONT ON									
----------	--	--	--	--	--	--	--	--	--

PROPERTY FACTORS		CLASSIFICATION	ACRES	RATE	ADJ.	CLASSIFICATION	ACRES	RATE	ADJ.
Public Water	Paved	Home Site		13000		Home Site		35400	
Public Sewer	Gravel	<input checked="" type="checkbox"/> Industrial	2.95	14,000				29,500	
Well	Dirt	RESIDUAL	.88	300				300	
Spring	No Road	Commercial	2.95	7,000				20,650	
Septic System	Curb & Gutter		.97					6790	
U. G. Utilities	Sidewalk	Wasteland						7090	
			3.83					35700	

General Remarks: ACCESS TO ACCORDING TO OTHER PERS. PLANT AND EQUIPMENT ACCORDING TO NO CHANGE. 4-12-88 SEE ATTACHED COPY AS TO WHY IMPS. HAVE BEEN TRANSFERRED (TO CARD # 17911)
BELT STRUCTURE 300' x 125' x 125'

NATIONAL ENERGY CORPORATION

DRAWER 1

HAYSI, VIRGINIA 24256

April 11, 1989

Mr. Ralph D. Vanover
Commissioner of the Revenue
P. O. Box 1067
Clintwood, Virginia 24228

Dear Mr. Vanover:

In regard to property on Prater Creek consisting of 3.833 Acres, please be advised that the only building on this property is an office trailer.

The tippie and other structures which had been assessed on this tract are on property owned by Haysi Railroad Company. The tippie and other structures are owned by National Energy Corporation. National Energy Corporation leases the property from Haysi Railroad Company.

Thanking you very much for your assistance in this matter.

Yours very truly,

NATIONAL ENERGY CORP.



Rual Fuller
President