

SANDLICK DISTRICT

0000000000703B

FIELDS CLARENCE - WILSON & DONINA  
 BOX 380  
 VA

24256

|                   |                 |
|-------------------|-----------------|
| DATE RECORDED     |                 |
| DEED OR WILL BOOK | DB 0070<br>0099 |
| CONSIDERATION     | 315-448<br>GIFT |
| DATE              |                 |

|          |    |
|----------|----|
| CLASS    | 2  |
| ZONING   |    |
| DISTRICT | 04 |

LEGAL DESCRIPTION  
 BARTLICK  
 5.95 AC

*315/448*  
 Recorded 3/11/96  
 17 AC April 28, 1988  
 Part  
 Florence & Bruce  
 Senter  
*Joyce Mullis*

|                   |  |
|-------------------|--|
| RECORDED          |  |
| DEED OR WILL BOOK |  |
| CONSIDERATION     |  |

|      |       |        |        |
|------|-------|--------|--------|
| 1992 |       |        |        |
| 1993 |       |        |        |
| 1994 | 8,200 | 21,800 | 30,000 |
| 1995 | 8,200 | 21,800 | 30,000 |
| 1996 | 8200  | 21800  | 30000  |
| 1997 | 8200  | 21800  | 30000  |
| 1998 | 8200  | 21800  | 21400  |
| 1999 |       |        |        |
| 2000 |       |        |        |
| 2001 |       |        |        |
| 2002 |       |        |        |
| 2003 |       |        |        |

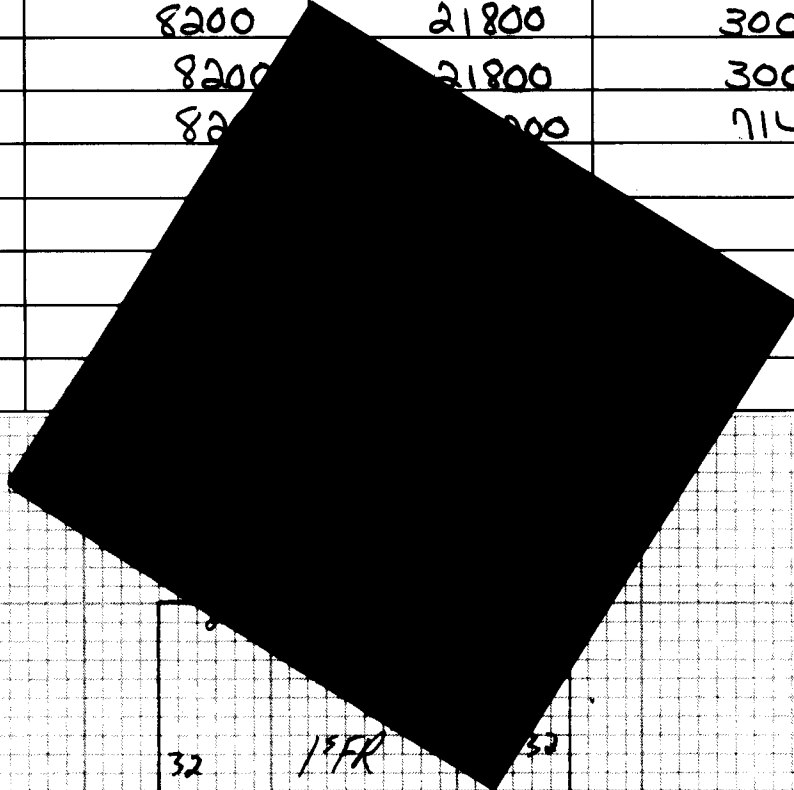

| NO. | TYPE | DATE | DESCRIPTION | AMOUNT | REMARKS |
|-----|------|------|-------------|--------|---------|
|     |      |      |             |        |         |
|     |      |      |             |        |         |

119-316

NOTES:

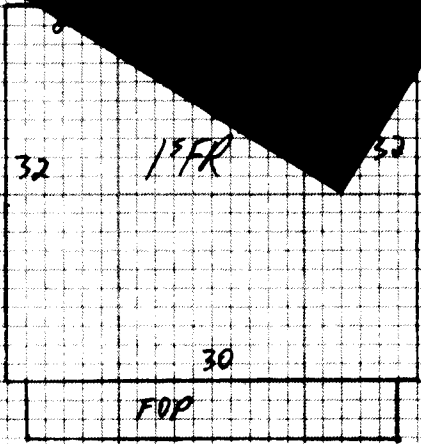



Property Identification Run Dt: 4/24/2000 Owner Name/Address  
 Map #: 00000000007038 FIELDS WILSON & DONNA  
 Acct #: 000003820-001 RT 1 BOX 380  
 Address: HAYSI VA 24256  
 City/St: ,

Legal Description 001 of 02  
 BARTLICK  
 5.95 AC  
 143 C - 1694

Occupancy: DWELLING  
 Dwelling Type: DW MH/Type: /  
 Use/Class: /SINGLE/FAM RES SUBURB  
 Year Assd: 2000  
 Zoning:  
 District: SANDLICK

Year Built: 1995  
 Year Rmld:  
 Year Effd:  
 Condition: FAIR  
 On Site Date: (MC) 4/27/1999  
 Review Date: ( )

Deed Bk/Pg: 315/ 448  
 Acreage: 5.95  
 Land Use:  
 Total Mineral:  
 Total Land: 16000  
 Total Imp: 44400  
 Total Value: 60400

----- Improvement Description -----  

|                    |                  |                   |
|--------------------|------------------|-------------------|
| <u>Exterior</u>    | <u>Interior</u>  | <u>Site</u>       |
| CONST-WOOD FRAME   | NO. ROOMS - 6    | STREET-PAVED      |
| EXT*1-VINYL        | NO. BEDROOMS - 3 | UTILTY-PUB WATER  |
| FOUND-PIERS        | NO. BATHS - 2    | UTILTY-SEPTIC SYS |
| ROOF_-COMP SHINGLE | FLOOR-CARPET     |                   |
|                    | FLOOR-VINYL      |                   |
|                    | INTER-SHEET ROCK |                   |

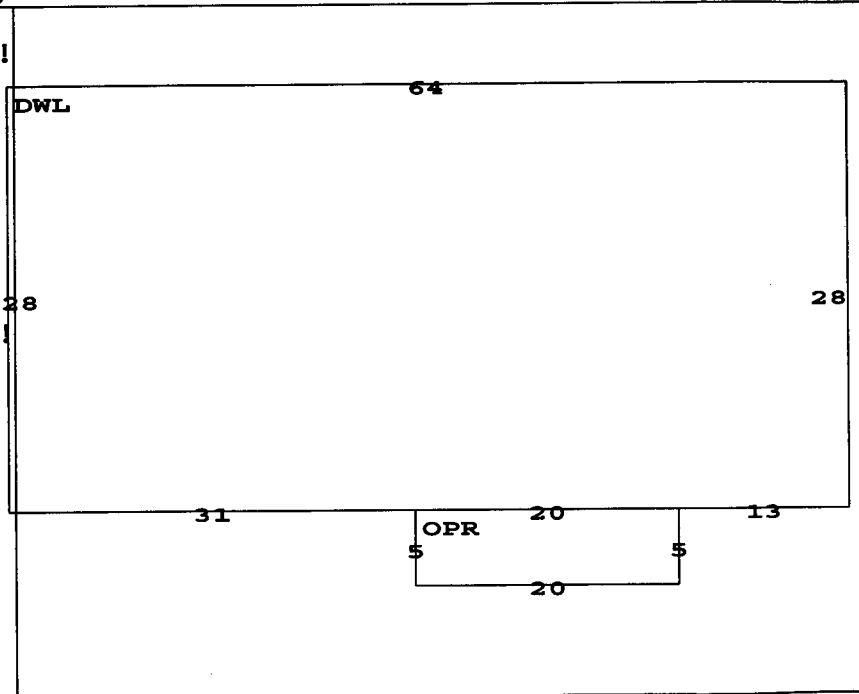

----- Dwelling Valuation -----

| <u>Item</u>              | <u>Size</u> | <u>Rate</u> | <u>Value</u> |
|--------------------------|-------------|-------------|--------------|
| DWELLING                 | 1792        | 29.00       | 51968        |
| BATH-F 101               | 2           | 2000.00     | 4000         |
| A/C CENTRL               | 1792        | 2.00        | 3584         |
| SWL 401                  | 1           | 5500.00     | 5500         |
| HEAT-CNTRL               | 1792        | 1.50        | 2688         |
| OPR                      | 100         | 14.00       | 1400         |
| Grade Factor (D-10)      |             |             | .75          |
| Replacement Cost New     |             |             | 51825        |
| Phys Depr. % (.160)      |             | - FAIR      | 8292         |
| <b>Total Bldg. Value</b> |             |             | <b>43500</b> |

----- Other Improvements Valuation -----

| <u>Desc</u>            | <u>Length</u> | <u>Width</u> | <u>Size</u> | <u>Grade</u> | <u>Rate</u> | <u>FV/Pct</u> | <u>Value</u> |
|------------------------|---------------|--------------|-------------|--------------|-------------|---------------|--------------|
| STORAGE ME             |               |              | 200         |              |             |               |              |
| STORAGE FR             |               |              | 100         |              |             |               |              |
| STORG-NCV              |               |              |             |              |             |               |              |
| STORAGE ME             |               |              | 600         |              |             |               |              |
| <b>Total Imp Value</b> |               |              | <b>900</b>  |              |             |               |              |

| <u>Sec</u> | <u>Type</u> | <u>Str</u> | <u>Description</u> | <u>Area</u> |
|------------|-------------|------------|--------------------|-------------|
| DWL        | DWELLING    | 1.00       | E64S28W13W20W31N28 | 1792        |
| OPR        | OPR         | 1.00       | E20S5W20N5         | 100         |

----- Land Valuation -----

| <u>Meth</u>             | <u>Cls</u> | <u>Desc</u> | <u>Grd</u> | <u>Size</u>  | <u>Depth</u> | <u>Rate</u> | <u>FV/Pct</u> | <u>Value</u> |
|-------------------------|------------|-------------|------------|--------------|--------------|-------------|---------------|--------------|
| A                       | 200        | H/S W/DWL   | G          | 2.00         |              | 6000.00     |               | 12000        |
| A                       | 300        | RESIDUAL    | F          | 3.95         |              | 1000.00     |               | 3950         |
| <b>Total Land Value</b> |            |             |            | <b>5.950</b> |              |             |               | <b>16000</b> |

|                               | <u>Cur. Value</u> | <u>Prev. Value</u> | <u>%Inc.</u> |
|-------------------------------|-------------------|--------------------|--------------|
| Land                          | 16000             | 8200               | 195 %        |
| Improvements                  | 44400             | 63200              | 70 %         |
| <b>Total</b>                  | <b>60400</b>      | <b>71400</b>       | <b>85 %</b>  |
| <b>Average Price Per Acre</b> |                   | <b>2681</b>        |              |

Property Identification Run Dt: 4/24/2000 Owner Name/Address  
Map #: 00000000007038 FIELDS WILSON & DONNA  
Cct #: 000003820-001 RT 1 BOX 380  
Address: HAYSI VA 24256  
City/St: ,

Legal Description 002 of 02  
BARTLICK  
5.95 AC  
143 C - 1694

Bk/Pg: 315/ 448

----- Comments -----!

143C (A) 1694  
NO CHANGE WAS MADE DURING HEARING.  
MOVED HOME TO IMPROVEMENT ONLY CARD PER R.R.  
04-24-00. ALL OF LAND WAS DEEDED TO WILSON &  
DONNA FIELDS IN DB 315 PG 448. MR. & MRS. FIELDS  
WANTED HELEN FIELDS' HOME PUT ON AN IMPROVEMENT  
ONLY CARD. (CARD #20812)  
CHANGE WAS MADE 4-24-00, HAD THE WRONG NUMBER OF  
BATHS, CORRECTED

-----!  
Total Property Value

60400

Property Identification Run Dt: 4/24/2000 Owner Name/Address  
 Map #: 00000000020812  
 Acct #: 001828116-001  
 Address:  
 City/St: ,

FIELDS' HELEN  
 RT 1 BOX 380  
 HAYSI VA 24256

Legal Description 001 of 01  
 BARTLICK  
 IMPROVEMENT ONLY  
 143C-1694

Occupancy: DWELLING  
 Dwelling Type: CONV MH/Type: /  
 Use/Class: /SINGLE/FAM RES SUBURB  
 Year Assd:  
 Zoning:  
 District: SANDLICK

Year Built: 1930  
 Year Rmld: 1998  
 Year Effd:  
 Condition: FAIR  
 On Site Date: (MC) 4/27/1999  
 Review Date: ( )

Bk/Pg: /  
 Acreage: .00  
 Land Use:  
 Total Mineral:  
 Total Land:  
 Total Imp: 26200  
 Total Value: 26200

----- Improvement Description -----  
 Exterior Interior Site  
 CONST-WOOD FRAME NO. ROOMS - 7 STREET-PAVED  
 EXT\*1-ALUMINUM NO. BEDROOMS - 3 UTILITY-PUB WATER  
 FOUND-CINDER BLOCK NO. BATHS - 1 UTILITY-SEPTIC SYS  
 ROOF\_-COMP SHINGLE FLOOR-TILE  
 INTER-PANEL  
 INTER-SHEET ROCK

----- Dwelling Valuation -----  

| Item                     | Size | Rate    | Value        |
|--------------------------|------|---------|--------------|
| DWELLING                 | 1248 | 30.02   | 37464        |
| BATH-F 101               | 1    | 2000.00 | 2000         |
| A/C CNTRL                | 1248 | 2.00    | 2496         |
| SWL 401                  | 1    | 5500.00 | 5500         |
| HEAT-CNTRL               | 1248 | 1.50    | 1872         |
| OPR                      | 168  | 14.00   | 2352         |
| OPR                      | 208  | 14.00   | 2912         |
| Grade Factor ( D-05)     |      |         | .80          |
| Replacement Cost New     |      |         | 43680        |
| Phys Depr. % (.400 )     |      | - FAIR  | 17472        |
| <b>Total Bldg. Value</b> |      |         | <b>26200</b> |

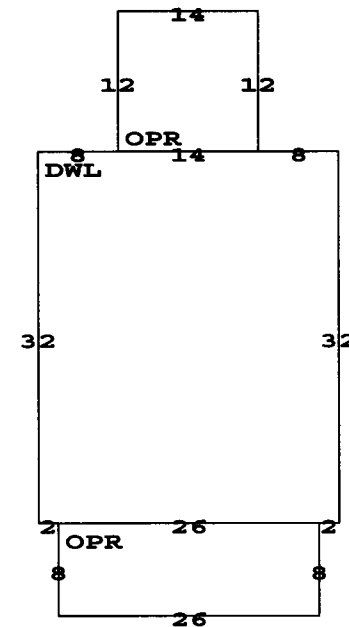

----- Comments -----  
 MOVED HOME SITE FROM CARD #7038 04-24-00 PER R.R.  
 SEE CARD #7038 FOR ADDITIONAL INFORMATION.  
 HAD TWO HALF-BATHS LISTED ON CARD, ONLY ONE FULL  
 BATH LISTED ON WORK-UP SHEET. CHANGED 04-24-00.  
 -----  
 Total Property Value 26200

| Sec | Type     | Str  | Description              | Area |
|-----|----------|------|--------------------------|------|
| DWL | DWELLING | 1.30 | E8E14E8S32W2W26W2<br>N32 | 1248 |
| OPR | OPR      | 1.00 | E14N12W14S12             | 168  |
| OPR | OPR      | 1.00 | E26S8W26N8               | 208  |

-----  

|                        | Cur. Value   | Prev. Value | %Inc. |
|------------------------|--------------|-------------|-------|
| Land                   |              |             |       |
| Improvements           | 26200        |             |       |
| <b>Total</b>           | <b>26200</b> |             |       |
| Average Price Per Acre |              |             |       |