

CLASS	2	LEGAL DESCRIPTION BUCK BRANCH 3AC
ZONING		
DISTRICT	04	

EDUARDE CARSON Etals  
~~RT 4 BOX 144~~ c/o Douglas Edwards  
~~CLINTWOOD VA 4033~~ Bethlehem Church  
 Pilot, VA ~~24228~~  
 24138

DATE RECORDED 2-1-74  
 DEED OR WILL BOOK DB 0164 0032  
 CONSIDERATION

1992			
1993			
1994	3,600	17,400	21,000
1995	3,600	17,400	21,000
1996			
1997			
1998			
1999			
2000			
2001			
2002			
2003			

DATE RECORDED 6-1-99  
 DEED OR WILL BOOK 27,686  
 CONSIDERATION

DATE RECORDED 11-29-99  
 DEED OR WILL BOOK 350,759  
 CONSIDERATION (3 tracts) 5000

DATE RECORDED  
 DEED OR WILL BOOK  
 CONSIDERATION

DATE RECORDED  
 DEED OR WILL BOOK  
 CONSIDERATION

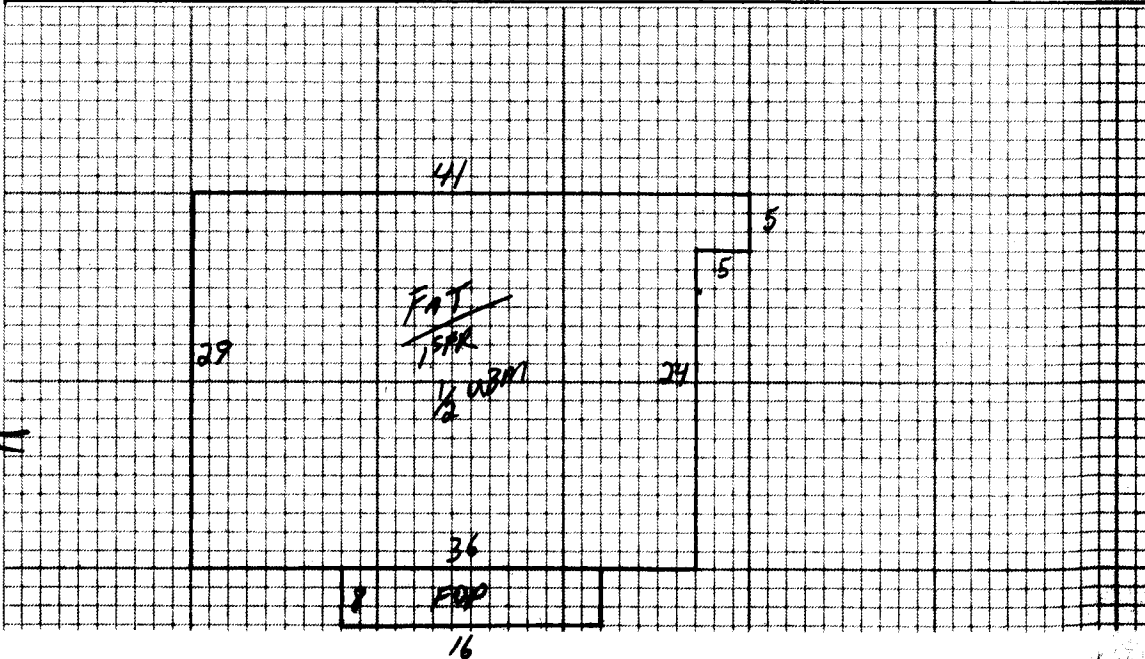

NOTES: Martha Fuller Edwards deeded her interest  
 in this tract to Dorothy Mustard Etals DB  
 350, PG 759

