

SANDLICK DISTRICT

00000000006586

~~BOYD CLYDE & WIFE~~ LORENE
~~RT 2 BOX 91~~
~~HAYSI VA~~

24256

DATE RECORDED 4-28-97
 DEED OR WILL BOOK 525 0111
 602 0355
 CONSIDERATION Quit Claim

Boyd, Danny R.
 Rt. 2 Box 91
 Haysi, VA 24256

DATE RECORDED 12-16-99
 DEED OR WILL BOOK 351,309
 CONSIDERATION (2 Tracts)

DATE RECORDED
 DEED OR WILL BOOK
 CONSIDERATION

DATE RECORDED
 DEED OR WILL BOOK
 CONSIDERATION

DATE RECORDED
 DEED OR WILL BOOK
 CONSIDERATION

BUILDING PERMITS

TYPE	DATE	NO.	DESCRIPTION

CLASS 5
 ZONING
 DISTRICT 04

LEGAL DESCRIPTION
 WOLF PEN
 3 TRACTS
 53 AC

1992			
1993			
1994	18,300	29,000	47,300
1995	18,300	29,000	47,300
1996			
1997			
1998			
1999			
2000			
2001			
2002			
2003			

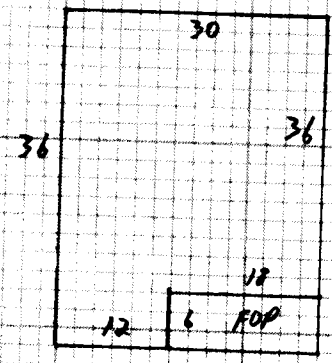

NOTES:

Well	✓	Comp. Sh.	✓	Wood Siding		Yr. Built	1st	Remod.		Bemt. [] 2nd []	Plaster		BATH(S) / Full [] 1/2 Bath(s) []
		Slate		Brick		No. Stories	1st [] 3rd []				Sheet rock		Modern Bath [] Modern Kitchen []
		Asbestos		Asb. Wood Shg.		S. Level [] S. Foyer []				Total No. Bedrooms	Ceciled		Cent. Heat <u>Oil</u> A/C <u>NO</u>
Wood Frame	✓	Metal		Cin. Block [] Stone []							Panel		✓ Fir. or Wall Furnace [] Stove(s) []
Cin. Block		Tar & Grav.		Stucco [] Con. Block []		Crawl [] Conc. []				HW [] Pine [] Carp. [] Tile []	Unfinished		
Steel Frame		Tile		Aluminum [] Masonite []		Riers [] Cin. Blk. []							
		Shakes		Storm Doors [] Storm Win. []		Slab [] Brick []				Disappearing Stairs	Gd. [] Fair [] Poor [] VP []		Number <u>NO</u>
													Number Chimneys
						Basement Size <u>1/2</u>				Attic Floor & Stairs			Brick [] C. Block []
													Stone [] Metal []

15 FR 978 315 30618

											YR. <u>94</u>	YR.	YR.
Dwelling													
Porch	0	108	6	648									
Porch													
Carport													
Garage													
Cent. A/C													
Basement													
Bemt. Finish													
Attic	978	787		7649									
Fireplace(s)													
Heating													
Bath(s)													
Total				<u>38, 915</u>									
Factor				<u>. 83</u>									
Replacement				<u>32 297</u>									

4 ER MISC Bldg
1 CB MISC II
2 ER hook ups at 2000
old house used for stg

M & L		M & L		MOBILE HOME INFORMATION	Market Value All Improvements	<u>29,000</u>
DATE		DATE		Owner	Market Value All Land	<u>18,300</u>
APPR. <u>NC</u>		APPR.		Make	TOTAL MARKET VALUE	<u>47,300</u>
DATE <u>2/17/94</u>		DATE		Size		
				Not Home [] Time		
				AM [] PM []		
		CLASSIFICATION	ZONING	AGRICULTURE AND VALUE COMPUTATIONS		
		<u>S</u>				

Classification	Depth	Square Footage	Unit Price	Total	Classification	Acres	Rate	Adj.	Total	Classification	Acres	Rate	Adj.	Total
Home Site						<u>2</u>			<u>3000</u>	Home Site				
<u>Pool</u>						<u>51</u>			<u>15300</u>					
Wasteland										Wasteland				
						<u>53</u>			<u>18300</u>					

General Remarks: no charge for treatment because it keeps water in it

Land Cost	\$
Bldg. Cost	\$
Sale Price	\$
Rent	\$
Expenses	\$
Net Rent	\$

BOARD REVIEW NOTES