

YATES LOWELL 4 ELTZ ABETA  
RT HC05 BOX 696  
COEBURN VA

24230

DATE RECORDED 3-15-69  
DEED OR WILL BOOK 308 0141 / 218 0063  
CONSIDERATION 1,000

|          |    |  |
|----------|----|--|
| CLASS    | 2  | LEGAL DESCRIPTION<br>SMITH RIDGE<br><del>SAC</del><br>2.5 AC |
| ZONING   |    |  |
| DISTRICT | 03 |  |

|                   |         |
|-------------------|---------|
| DATE RECORDED     |         |
| DEED OR WILL BOOK | 334-484 |
| CONSIDERATION     |         |
| DATE RECORDED     |         |
| DEED OR WILL BOOK |         |
| CONSIDERATION     |         |
| DATE RECORDED     |         |
| DEED OR WILL BOOK |         |
| CONSIDERATION     |         |
| DATE RECORDED     |         |
| DEED OR WILL BOOK |         |
| CONSIDERATION     |         |

|      |       |        |        |
|------|-------|--------|--------|
| 1992 |       |        |        |
| 1993 |       |        |        |
| 1994 | 4,000 | 22,600 | 26,600 |
| 1995 | 4,000 | 22,600 | 26,600 |
| 1996 |       |        |        |
| 1997 |       |        |        |
| 1998 |       |        |        |
| 1999 | 3800  | 22600  | 26400  |
| 2000 |       |        |        |
| 2001 |       |        |        |
| 2002 |       |        |        |
| 2003 |       |        |        |

|  |  |  |  |  |  |  |  |
|--|--|--|--|--|--|--|--|
|  |  |  |  |  |  |  |  |
|  |  |  |  |  |  |  |  |
|  |  |  |  |  |  |  |  |
|  |  |  |  |  |  |  |  |

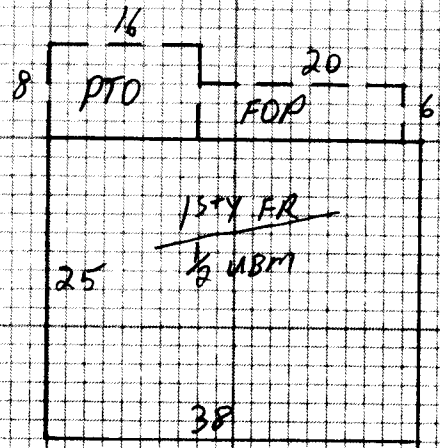

NOTES: .SOAL TO Terry W YATES 334-482 CARD #19680

|             |                                     |             |                                     |                |                                     |             |                          |                      |                          |                    |                          |                     |                          |            |                          |                                     |                                     |                          |                                     |                          |                          |
|-------------|-------------------------------------|-------------|-------------------------------------|----------------|-------------------------------------|-------------|--------------------------|----------------------|--------------------------|--------------------|--------------------------|---------------------|--------------------------|------------|--------------------------|-------------------------------------|-------------------------------------|--------------------------|-------------------------------------|--------------------------|--------------------------|
| Dwelling    | <input checked="" type="checkbox"/> | Comp. Sh.   | <input checked="" type="checkbox"/> | Wood Siding    | <input checked="" type="checkbox"/> | Yr. Built   | 67                       | Remod.               |                          | Bsmt.              | ( )                      | 2nd                 | ( )                      | Plaster    |                          | BATHS                               | /                                   | Full                     | 1/2                                 | Baths                    |                          |
|             |                                     | Slate       |                                     | Brick          |                                     | No. Stories |                          |                      | 1                        | 1st                | (H)                      | 3rd                 | ( )                      | Sheet rock |                          | Modern Bath                         | <input type="checkbox"/>            | Modern Kitchen           | <input type="checkbox"/>            |                          |                          |
|             |                                     | Asbestos    |                                     | Asb. Wood Shg. |                                     | S. Level    | <input type="checkbox"/> | S. Foyer             | <input type="checkbox"/> | Total No. Bedrooms |                          |                     |                          | Ceiled     |                          | Cent. Heat                          | Oil                                 | A/C                      |                                     |                          |                          |
|             |                                     | Metal       |                                     | Cin. Block     | <input type="checkbox"/>            | Stone       | <input type="checkbox"/> |                      |                          |                    |                          |                     |                          | Panel      |                          | <input checked="" type="checkbox"/> | Fir. or Wall Furnace                | <input type="checkbox"/> | Stove(s)                            | <input type="checkbox"/> |                          |
| Wood Frame  | <input checked="" type="checkbox"/> | Tar & Grav. |                                     | Stucco         | <input type="checkbox"/>            | Con. Block  | <input type="checkbox"/> | Crawl                | <input type="checkbox"/> | Conc.              | <input type="checkbox"/> | NW                  | <input type="checkbox"/> | Pine       | <input type="checkbox"/> | Carp.                               | <input checked="" type="checkbox"/> | Tile                     | <input checked="" type="checkbox"/> | Unfinished               |                          |
| Cin. Block  |                                     | Tile        |                                     | Aluminum       | <input type="checkbox"/>            | Masonite    | <input type="checkbox"/> | Riers                | <input type="checkbox"/> | Cin. Blk.          | <input type="checkbox"/> |                     |                          |            |                          |                                     |                                     |                          |                                     | Number                   | NO                       |
| Steel Frame |                                     | Shakes      |                                     | Storm Doors    | <input type="checkbox"/>            | Storm Win.  | <input type="checkbox"/> | Slab                 | <input type="checkbox"/> | Brick              | <input type="checkbox"/> | Disappearing Stairs |                          | Gd.        | <input type="checkbox"/> | Fair                                | <input type="checkbox"/>            | Poor                     | <input type="checkbox"/>            | VP                       | <input type="checkbox"/> |
|             |                                     |             |                                     | Basement Size  | 1/2                                 |             |                          | Attic Floor & Stairs |                          |                    |                          |                     |                          |            |                          |                                     |                                     |                          |                                     | Number Chimneys          |                          |
|             |                                     |             |                                     | Gd.            | <input type="checkbox"/>            | Fair        | <input type="checkbox"/> | Poor                 | <input type="checkbox"/> | VP                 | <input type="checkbox"/> | Bsmt. Finish        |                          | 1/4        | <input type="checkbox"/> | 1/2                                 | <input type="checkbox"/>            | 3/4                      | <input type="checkbox"/>            | Full                     | <input type="checkbox"/> |
|             |                                     |             |                                     | Attic          | <input type="checkbox"/>            | Wells       | <input type="checkbox"/> | Fl.                  | <input type="checkbox"/> |                    |                          | Stone               | ( )                      | Metal      | ( )                      |                                     |                                     |                          |                                     |                          |                          |

1st y 950 30.5 28 975

YR. 94 YR. YR.

Dwelling D 29 509 25% 22 131

FR GAR 24x28

FV 500

Porch 120 8 960  
 Porch PTO 128 7 896

Basement 475 6.5 3087

|                  |        |
|------------------|--------|
| M & L            | M & L  |
| DATE             | DATE   |
| APRP. KJK        | APRP.  |
| DATE 1-11-94     | DATE   |
| CLASSIFICATION 2 | ZONING |

|                                   |                               |        |        |
|-----------------------------------|-------------------------------|--------|--------|
| Owner                             | Market Value All Improvements | 22 600 | 22 600 |
| Make                              | Market Value All Land         | 4 000  | 3 800  |
| Size                              |                               | 26 600 | 26 400 |
| Not Home <input type="checkbox"/> | Time                          |        |        |
| Agric.                            |                               |        |        |
| Hort.                             |                               |        |        |
| Forest                            |                               |        |        |
| Open Space                        |                               |        |        |
| Totals                            |                               |        |        |

Total 33 918  
 Factor .87  
 Replacement 29,509

OWNER

| CLASSIFICATION | ACRES | RATE | ADJ. | CLASSIFICATION | ACRES | RATE | ADJ. |
|----------------|-------|------|------|----------------|-------|------|------|
| Home Site      | 1     |      | 3000 | Home Site      |       |      |      |
|                | 2     | 500  | 1000 |                |       |      |      |
|                | 1/2   |      | 800  |                |       |      |      |
| Wasteland      | 2.5   |      | 3800 | Wasteland      |       |      |      |
|                | 3     |      | 4000 |                |       |      |      |

General Remarks: WATER LEVEL low AT TIMES

LEVEL  SLOPES UP  SLOPES DOWN   
 LOW  STEEP UP  STEEP DOWN

|            |  |
|------------|--|
| Land Cost  |  |
| \$         |  |
| Bldg. Cost |  |
| \$         |  |
| Sale Price |  |
| \$         |  |
| Rent       |  |
| \$         |  |
| Expenses   |  |
| \$         |  |
| Net Rent   |  |
| \$         |  |

BOARD REVIEW NOTES