

13396  
24228

DATE RECORDED  
DEED OR WILL BOOK 101-420  
CONSIDERATION ~~YE~~ SE

CLASS 2  
ZONING  
DISTRICT 01

LEGAL DESCRIPTION  
GEORGES FORK  
6-16-AC, 3.49  
\*\*\*

DATE RECORDED  
DEED OR WILL BOOK  
CONSIDERATION

DATE RECORDED  
DEED OR WILL BOOK  
CONSIDERATION

1986	4300	10,300	14,600
1987	4000	10,300	14,300
1988	4000	10,300	14,300
1989	4000	10,300	14,300
1990	4000	10,300	14,300
1991	4000	10,300	14,300
1992			
1993			
1994			
1995			
1996			
1997			

DATE RECORDED  
DEED OR WILL BOOK  
CONSIDERATION

DATE RECORDED  
DEED OR WILL BOOK  
CONSIDERATION

1986	4300	10,300	14,600
1987	4000	10,300	14,300
1988	4000	10,300	14,300
1989	4000	10,300	14,300
1990	4000	10,300	14,300
1991	4000	10,300	14,300
1992			
1993			
1994			
1995			
1996			
1997			

DATE RECORDED  
DEED OR WILL BOOK  
CONSIDERATION

DATE RECORDED  
DEED OR WILL BOOK  
CONSIDERATION

1986	4300	10,300	14,600
1987	4000	10,300	14,300
1988	4000	10,300	14,300
1989	4000	10,300	14,300
1990	4000	10,300	14,300
1991	4000	10,300	14,300
1992			
1993			
1994			
1995			
1996			
1997			

DATE RECORDED  
DEED OR WILL BOOK  
CONSIDERATION

DATE RECORDED  
DEED OR WILL BOOK  
CONSIDERATION

1986	4300	10,300	14,600
1987	4000	10,300	14,300
1988	4000	10,300	14,300
1989	4000	10,300	14,300
1990	4000	10,300	14,300
1991	4000	10,300	14,300
1992			
1993			
1994			
1995			
1996			
1997			

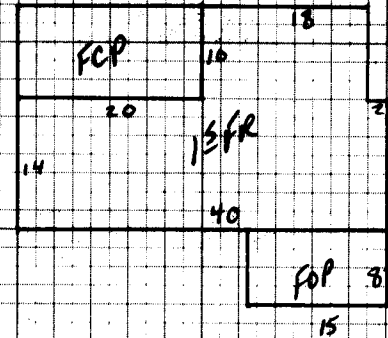
NOTES: .65 AC TO FRANCIS K. CHASE 233-473

Dwelling	<input checked="" type="checkbox"/>	Comp. Sh.		Wood Siding		Yr. Built <u>70</u>	Remod.		Bemt. [ ] 2nd [ ]	Plaster		BATH(S) / Full 1/2 Bath(s)
		Slate		Brick		No. Stories	<u>1</u>		1st [ <u>9</u> ] 2nd [ ]	Sheet rock		Modern Bath <input type="checkbox"/> Modern Kitchen <input type="checkbox"/>
		Asbestos		Asb. Wood Shg.		B. Level <input type="checkbox"/>	B. Foyer <input type="checkbox"/>		Total No. Bathrooms	Cooled		Cent. Heat <input type="checkbox"/> A/C <input type="checkbox"/>
		Metal	<input checked="" type="checkbox"/>	Cin. Block <input type="checkbox"/> Stone <input type="checkbox"/>						Paint	<input checked="" type="checkbox"/>	Fir. or Wall Furnace <input type="checkbox"/> Stove(s) <input type="checkbox"/>
Wood Frame	<input checked="" type="checkbox"/>	Tar & Grav.		Stucco <input type="checkbox"/> Con. Block <input type="checkbox"/>		Crawl <input type="checkbox"/> Conc. <input type="checkbox"/>			HW <input type="checkbox"/> Ptg <input type="checkbox"/> Carp. <input type="checkbox"/> Trs <input type="checkbox"/>	Unfinished		
Cin. Block		Tile		Aluminum <input checked="" type="checkbox"/> Masonite <input type="checkbox"/>		Fibers <input type="checkbox"/> Cin. Blk. <input checked="" type="checkbox"/>						Number <u>1</u>
Steel Frame		Shakes		Storm Doors <input type="checkbox"/> Storm Vln. <input type="checkbox"/>		Slab <input type="checkbox"/> Brick <input checked="" type="checkbox"/>		Disappearing Stairs		Bas. <input type="checkbox"/> Par. <input checked="" type="checkbox"/> Por. <input type="checkbox"/> VP <input type="checkbox"/>		Number Chimneys <u>1</u>
						Basement Size <u>ND</u>		Attic Floor & Stairs				Brick <input checked="" type="checkbox"/> C. Block [ ]
						Basmt. Finish		1/4 <input type="checkbox"/> 1/2 <input type="checkbox"/> 3/4 <input type="checkbox"/> Full <input type="checkbox"/>		Walls <input type="checkbox"/> Fl. <input type="checkbox"/>		Stone [ ] Metal [ ]

158 740 32 23,680

YR. 86 YR. YR.

Dwelling	<u>OLD RW.</u>		<u>E-</u>	<u>20,050</u>	<u>-506</u>	<u>10,025</u>
	<u>23CB Bldg</u>				<u>FV</u>	<u>300</u>
Porch	<u>120</u>	<u>8</u>	<u>960</u>			
Porch						
Carport	<u>200</u>	<u>8</u>	<u>1600</u>			
Garage						
Cent. A/C						
Basement						

M & L	M & L	Market Value All Improvements	<u>10,325</u>
DATE	DATE	Market Value All Land	<u>4564</u> <u>4000</u>
APRP.	APRP.	Size	Cond.
<u>DD</u>		Not Home <input checked="" type="checkbox"/> Time	
DATE	DATE	AM <input checked="" type="checkbox"/> PM <input type="checkbox"/>	
<u>3-1-85</u>		Agric.	
CLASSIFICATION	ZONING	Hort.	
<u>2</u>		Forest	
		Open Space	
		Totals	

Total 28,240  
 Factor .71  
 Replacement 20,050

Land Cost	
\$	
Bldg. Cost	
\$	
Sale Price	
\$	
Rent	
\$	
Expenses	
\$	
Net Rent	
\$	

CLASSIFICATION	ACRES	RATE	ADJ.	CLASSIFICATION	ACRES	RATE	ADJ.
Home Site	<u>1.19</u>			Home Site			
	<u>23.74</u>	<u>400</u>				<u>3000</u>	<u>4256</u> <u>1000</u>
Wasteland				Wasteland			
	<u>4.14</u>					<u>4256</u> <u>4000</u>	

General Remarks:

LEVEL  SLOPES UP  SLOPES DOWN   
 LOW  STEEP UP  STEEP DOWN

BOARD REVIEW NOTES