

JOHN JACKIE & DONNA S  
RT 2 BOX 134T  
CLINTWOOD VA 24228

CLASS 2  
ZONING  
DISTRICT 01

LEGAL DESCRIPTION  
GEORGES FORK  
1.7AC

DATE RECORDED	
DEED OR WILL BOOK	198-166
CONSIDERATION	
DATE RECORDED	
DEED OR WILL BOOK	
CONSIDERATION	
DATE RECORDED	
DEED OR WILL BOOK	
CONSIDERATION	
DATE RECORDED	
DEED OR WILL BOOK	
CONSIDERATION	
DATE RECORDED	
DEED OR WILL BOOK	
CONSIDERATION	

1992	4000	28800	32800
1993	4000	28800	32,800
1994			
1995			
1996			
1997			
1998			
1999			
2000			
2001			
2002			
2003			

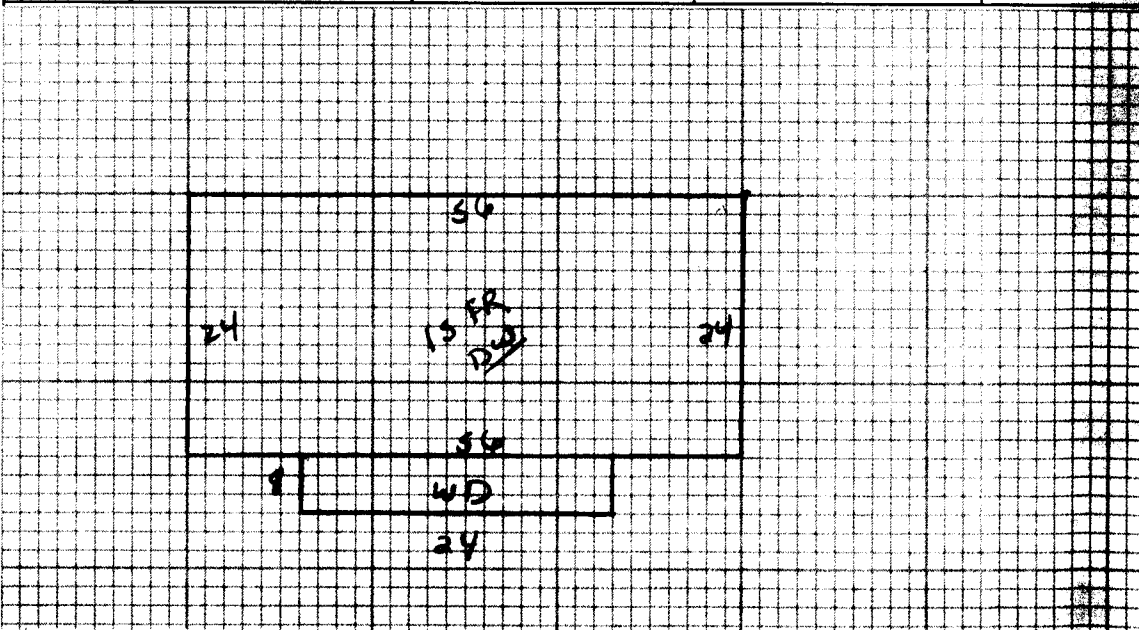

NOTES:

Dwelling <input checked="" type="checkbox"/>	Comp. Sh. <input checked="" type="checkbox"/>	Wood Siding	Yr. Built <u>61</u>	Remod.	Bmnt. <input type="checkbox"/>	2nd <input type="checkbox"/>	Plaster	BATH(s) <u>2</u> Full <input checked="" type="checkbox"/>	1/2 Bath(s)				
	Slate	Brick	No. Stories		1st <u>6</u>	3rd <input type="checkbox"/>	Sheet rock	Modern Bath <input type="checkbox"/>	Modern Kitchen <input type="checkbox"/>				
	Asbestos	Aab. Wood Shg.	S. Level <input type="checkbox"/>	S. Foyer <input type="checkbox"/>	Total No. Bedrooms		Ceolled	Cent. Heat <u>Elec</u>	A/C				
	Metal	Cin. Block <input type="checkbox"/>	Stone <input type="checkbox"/>				Panel	Fir. or Wall Furnace <input type="checkbox"/>	Stoves(s) <input type="checkbox"/>				
Wood Frame <input checked="" type="checkbox"/>	Tar & Grav.	Stucco <input type="checkbox"/>	Con. Block <input type="checkbox"/>	Crawl <input type="checkbox"/>	Conc. <input type="checkbox"/>	HW <input type="checkbox"/>	Fine <input type="checkbox"/>	Carp. <input type="checkbox"/>	Tile <input type="checkbox"/>	Unfinished			
Cin. Block	Tile	Aluminum <input checked="" type="checkbox"/>	Masonite <input type="checkbox"/>	Fiers <input type="checkbox"/>	Cin. Blk. <input checked="" type="checkbox"/>			Number <u>1</u>					
Steel Frame	Shakes	Storm Doors <input type="checkbox"/>	Storm Win. <input type="checkbox"/>	Slab <input type="checkbox"/>	Brick <input type="checkbox"/>	Disappearing Stairs	Gd. <input type="checkbox"/>	Fair <input checked="" type="checkbox"/>	Poor <input type="checkbox"/>	VP <input type="checkbox"/>			
		Basement Size <u>NO</u>		Attic Floor & Stairs				Number Chimneys					
		Gd. <input type="checkbox"/>		Fair <input checked="" type="checkbox"/>	Poor <input type="checkbox"/>	VP <input type="checkbox"/>	Brick <input checked="" type="checkbox"/>		C. Block <input type="checkbox"/>				
		Basmt. Finish		1/4 <input type="checkbox"/>		1/2 <input type="checkbox"/>	3/4 <input type="checkbox"/>	Full <input type="checkbox"/>	Attic <input type="checkbox"/>	Walls <input type="checkbox"/>	Fl. <input type="checkbox"/>	Stone <input type="checkbox"/>	Metal <input type="checkbox"/>

13 ER 1344 28 376 32 YR. 1991 YR. YR.

Dwelling	<u>D</u>	<u>33 909</u>	<u>152</u>	<u>28800</u>
Porch	<u>192 7</u>	<u>1344</u>		
Porch				
Carport				
Garage				
Cent. A/C				
Basement				

Basement	M & L	M & L	Market Value All Improvements	<u>28800</u>
Basmt. Finish	DATE	DATE	Market Value All Land	<u>4000</u>
Attic	APRP. <u>7B3</u>	APRP.	Owner	<u>52800</u>
Fireplace(s)	DATE <u>1-16-91</u>	DATE	Make	
Heating			Year	
Bath(s)			Size	
			Cond.	
			Not Home <input type="checkbox"/>	Time
			AM <input type="checkbox"/>	PM <input type="checkbox"/>
			CLASSIFICATION	ZONING
			<u>2</u>	

Total	<u>38976</u>	Land Cost	
Factor	<u>.87</u>	Bldg. Cost	
Replacement	<u>33909</u>	Sale Price	
		Rent	
		Expenses	
		Net Rent	

CLASSIFICATION	ACRES	RATE	ADJ.	CLASSIFICATION	ACRES	RATE	ADJ.
Home Site	<u>1</u>			Home Site		<u>3500</u>	
	<u>.7</u>					<u>500</u>	
	<u>1.7</u>					<u>4000</u>	

General Remarks:

LEVEL  SLOPES UP  SLOPES DOWN

LOW  STEEP UP  STEEP DOWN

BOARD REVIEW NOTES