

RECORD OF OWNERSHIP

KAYLIFF CLARA HAY
RT. 1 BOX 512
HAYSI VA 24256

DATE RECORDED *10-6-82*
 DEED OR WILL BOOK *214-076*
 CONSID-ERATION *YR- 8000.00*
SE

03924

CLASS **5**
 ZONING
 DISTRICT **02**
 LEGAL DESCRIPTION
LICK CREEK
35AC

	DATE RECORDED	
	DEED OR WILL BOOK	
	CONSID-ERATION	
	DATE RECORDED	
	DEED OR WILL BOOK	
	CONSID-ERATION	
	DATE RECORDED	
	DEED OR WILL BOOK	
	CONSID-ERATION	
	DATE RECORDED	
	DEED OR WILL BOOK	
	CONSID-ERATION	

1986	<i>13,200</i>	<i>10,400</i>	<i>23,600</i>	
1987	<i>13,200</i>	<i>10,400</i>	<i>23,600</i>	
1988	<i>13,200</i>	<i>10,400</i>	<i>23,600</i>	
1989	<i>13,200</i>	<i>10,400</i>	<i>23,600</i>	
1990	<i>13,200</i>	<i>10,400</i>	<i>23,600</i>	
1991	<i>13,200</i>	<i>10,400</i>	<i>23,600</i>	
1992				
1993				
1994				
1995				
1996				
1997				

BUILDING PERMITS

NOTES:

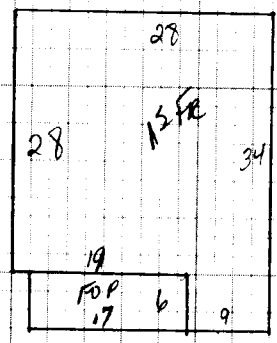

Dwelling	Comp. Sh.	Wood Siding	Yr. Built <u>35</u>	Remod.	Bsmt. [] 2nd []	Plaster	BATH(S) / Full 1/2 Bath(s)
Slate		Brick	No. Stories	1	1st <u>14</u> 3rd []	Sheet rock	Modern Bath <input type="checkbox"/> Modern Kitchen <input type="checkbox"/>
Asbestos		Asb. Wood Shg.	S. Level <input type="checkbox"/> S. Foyer <input type="checkbox"/>		Total No. Bedrooms	Ceciled	Cent. Heat <u>COAL</u> A/C
Metal		Cin. Block <input type="checkbox"/> Stone <input type="checkbox"/>				Panel	Fir. or Wall Furnace <input type="checkbox"/> Stove(s) <input type="checkbox"/>
Wood Frame	Tar & Grav.	Stucco <input type="checkbox"/> Con. Block <input type="checkbox"/>	Crawl <input type="checkbox"/> Conc. <input type="checkbox"/>	HW <input type="checkbox"/> Pine <input type="checkbox"/> Carp. <input type="checkbox"/> Tile <input type="checkbox"/>	Unfinished		
Cin. Block	Tile	Aluminum <input checked="" type="checkbox"/> Masonite <input type="checkbox"/>	Riers <input type="checkbox"/> Cin. Blk. <input checked="" type="checkbox"/>				
Steel Frame	Shakes	Storm Doors <input type="checkbox"/> Storm Win. <input type="checkbox"/>	Slab <input type="checkbox"/> Brick <input type="checkbox"/>	Disappearing Stairs	Gd. <input type="checkbox"/> Fair <input type="checkbox"/> Poor <input type="checkbox"/> VP <input type="checkbox"/>		Number

15R 838 32 26,816

Basement Size <u>NO</u>	Attic Floor & Stairs	Basement Finish	Attic <input type="checkbox"/> Walls <input type="checkbox"/> Fl. <input type="checkbox"/>	YR. <u>86</u>	YR.	YR.
Gd. <input type="checkbox"/> Fair <input type="checkbox"/> Poor <input checked="" type="checkbox"/> VP <input type="checkbox"/>	Basmt. Finish	1/4 <input type="checkbox"/> 1/2 <input type="checkbox"/> 3/4 <input type="checkbox"/> Full <input type="checkbox"/>				

Dwelling			<u>E</u>	<u>20,724</u>	<u>-50%</u>	<u>10,362</u>		
Porch	<u>102</u>	<u>8</u>	<u>816</u>					
Porch								
Carport								
Garage								
Cent. A/C								

Basement	M & L	M & L	MOBILE HOME INFORMATION	Market Value All Improvements	<u>10,362</u>
Bsmt. Finish	DATE	DATE	Owner	Market Value All Land	<u>13,200</u>
Attic	APRP.	APRP.	Make Year		<u>23,562</u>
Fireplace(s)	DATE <u>ML</u>	DATE	Size Cond.		
Heating	DATE <u>17-9-85</u>	DATE	Not Home <input type="checkbox"/> Time		
Bath(s)	CLASSIFICATION <u>5</u>	ZONING	AM <input checked="" type="checkbox"/> PM <input type="checkbox"/>		
Total	<u>27,632</u>				
Factor	<u>.75</u>				
Replacement	<u>20,724</u>				

Land Cost					
Bldg. Cost					
Net Rent					
Expenses					
Net Rent					
Expenses					

PROPERTY FACTORS	CLASSIFICATION	ACRES	RATE	ADJ.	CLASSIFICATION	ACRES	RATE	ADJ.
Public Water	Home Site	<u>1</u>			Home Site			
Public Sewer		<u>34</u>	<u>300</u>					
Well								
Spring								
Septic System	Wasteland				Wasteland			
U. G. Utilities		<u>35</u>						
							<u>13,200</u>	

General Remarks:

LEVEL SLOPES UP SLOPES DOWN

LOW STEEP UP STEEP DOWN

BOARD REVIEW NOTES