

GREEAR JANICE  
RT 4 BOX 67  
CLINTWOOD VA

24228

DATE RECORDED 1-6-83  
DEED OR WILL BOOK DB 0214 0732  
CONSIDERATION 7500.00

CLASS 2  
ZONING  
DISTRICT 02

LEGAL DESCRIPTION  
BIG BRANCH  
.80AC  
178-175B (A) 851

1992			
1993			
1994	3,500	6,300	9,800
1995	3,500	6,300	9,800
1996			
1997			
1998			
1999			
2000			
2001			
2002			
2003			

DATE RECORDED  
DEED OR WILL BOOK  
CONSIDERATION

DATE RECORDED  
DEED OR WILL BOOK  
CONSIDERATION

DATE RECORDED  
DEED OR WILL BOOK  
CONSIDERATION

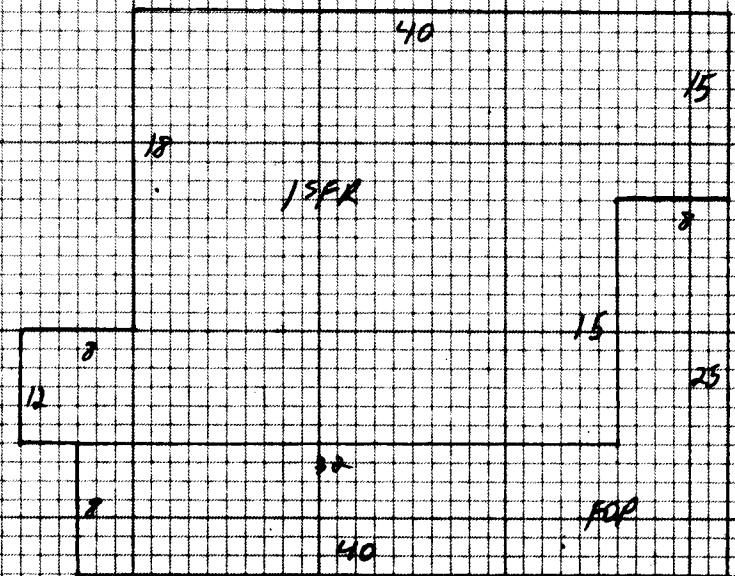

NOTES:

Dwelling <input checked="" type="checkbox"/>	Comp. Sh. <input checked="" type="checkbox"/>	Wood Siding <input checked="" type="checkbox"/>	Yr. Built <u>10</u>	Remod. <input type="checkbox"/>	Bemt. <input type="checkbox"/> 2nd <input type="checkbox"/>	Plaster <input type="checkbox"/>	BATH(S) / Full <input type="checkbox"/> 1/2 Bath(s) <input type="checkbox"/>
	Slate <input type="checkbox"/>	Brick <input type="checkbox"/>	No. Stories <u>1</u>		1st <input checked="" type="checkbox"/> 3rd <input type="checkbox"/>	Sheet rock <input type="checkbox"/>	Modern Bath <input type="checkbox"/> Modern Kitchen <input type="checkbox"/>
	Asbestos <input type="checkbox"/>	Asb. Wood Shg. <input type="checkbox"/>	B. Level <input type="checkbox"/> B. Foyer <input type="checkbox"/>		Total No. Bedrooms <u>1</u>	Cooled <input type="checkbox"/>	Cent. Heat <u>OIL</u> A/C <input type="checkbox"/>
	Metal <input type="checkbox"/>	Cin. Block <input type="checkbox"/> Stone <input type="checkbox"/>				Panel <input type="checkbox"/>	Fr. or Wall Furnace <input type="checkbox"/> Stove(s) <input type="checkbox"/>
Wood Frame <input checked="" type="checkbox"/>	Tar & Grav. <input type="checkbox"/>	Stucco <input type="checkbox"/> Con. Block <input type="checkbox"/>	Crawl <input type="checkbox"/> Conc. <input type="checkbox"/>	NW <input type="checkbox"/> Pine <input type="checkbox"/> Carp. <input checked="" type="checkbox"/> Tile <input type="checkbox"/>	Unfinished <input type="checkbox"/>		
Cin. Block <input type="checkbox"/>	Title <input type="checkbox"/>	Aluminum <input type="checkbox"/> Masonite <input type="checkbox"/>	Flers <input type="checkbox"/> Cin. Blk. <input type="checkbox"/>				
Steel Frame <input type="checkbox"/>	Shakes <input type="checkbox"/>	Storm Doors <input type="checkbox"/> Storm Win. <input type="checkbox"/>	Slab <input type="checkbox"/> Brick <input type="checkbox"/>	Disappearing Stairs <input type="checkbox"/>	Od. <input type="checkbox"/> Fair <input type="checkbox"/> Poor <input checked="" type="checkbox"/> VP <input type="checkbox"/>		Number Chimneys <u>1</u>

<u>15 FR 1176 28 32928</u>	Basement Size <u>ND</u>	Attic Floor & Stairs <input type="checkbox"/>	Number <u>1</u>
	Basmt. Finish <input type="checkbox"/>	1/4 <input type="checkbox"/> 1/2 <input type="checkbox"/> 3/4 <input type="checkbox"/> Full <input type="checkbox"/>	Brick <input type="checkbox"/> C. Block <input type="checkbox"/>
	Od. <input type="checkbox"/> Fair <input type="checkbox"/> Poor <input checked="" type="checkbox"/> VP <input type="checkbox"/>	Attic <input type="checkbox"/> Walls <input type="checkbox"/> Fl. <input type="checkbox"/>	Stone <input type="checkbox"/> Metal <input type="checkbox"/>
		YR. <u>1994</u>	YR. <u>1994</u>

Dwelling			<u>E-</u>	<u>25253</u>	<u>75%</u>	<u>6300</u>
Porch	<u>440</u>	<u>6</u>				<u>2640</u>
Porch						
Carport						
Garage						
Cent. A/C						

Basement	M & L	M & L	Market Value All Improvements <u>6300</u>
Basmt. Finish	DATE	DATE	Market Value All Land <u>3500</u>
Attic	APRP <u>DR</u>	APRP	<u>9800</u>
Fireplace(s)	DATE <u>2-3-94</u>	DATE	
Heating	CLASSIFICATION <u>2</u>	ZONING	
Bath(s)			
Total	<u>35568</u>		
Factor	<u>.71</u>		
Replacement	<u>25253</u>		

Land Cost	
\$	
Bldg. Cost	
\$	
Sale Price	
\$	
Rent	
\$	
Expenses	
\$	
Net Rent	
\$	

CLASSIFICATION	ACRES	RATE	ADJ.	CLASSIFICATION	ACRES	RATE	ADJ.
Home Site	<u>1.</u>	<u>3000</u>		Home Site			
	<u>1.81</u>					<u>500</u>	
Wasteland				Wasteland			
	<u>2.81</u>					<u>3500</u>	

General Remarks:

LEVEL  SLOPES UP  SLOPES DOWN

LOW  STEEP UP  STEEP DOWN

BOARD REVIEW NOTES