

PHILLIPS PHOEBE Heirs
 ST RT BOX 65 46 PAUL WITT
 BIRCHLEAF VA 24220

03751

DATE RECORDED
 DEED OR WILL BOOK 79-63
 CONSID- YR- ERATION SP

DATE RECORDED
 DEED OR WILL BOOK
 CONSID- ERATION

DATE RECORDED
 DEED OR WILL BOOK
 CONSID- ERATION

DATE RECORDED
 DEED OR WILL BOOK
 CONSID- ERATION

DATE RECORDED
 DEED OR WILL BOOK
 CONSID- ERATION

BUILDING PERMITS

NOTES: HARRIET LOWELL + Judy Bellamy conveyed their interest in this property to Doyle + Lois Phillips 224-209
 Renee Castle + Lenice 1/2 g 1/10 = 234-122
 Sue Smith 1/2 g 1/10. 202-360

CLASS 5	LEGAL DESCRIPTION FLAT SPUR 25-4AC 8/10ths und int ev 27.36 ac. ***		
ZONING			
DISTRICT 02			

1986	16400	4300	20700	
1987	14700	3900	18600	
1988	14700	3900	18600	
1989	14700	3900	18600	
1990	14700	3900	18600	
1991	14700	3900	18600	
1992				
1993				
1994				
1995				
1996				
1997				

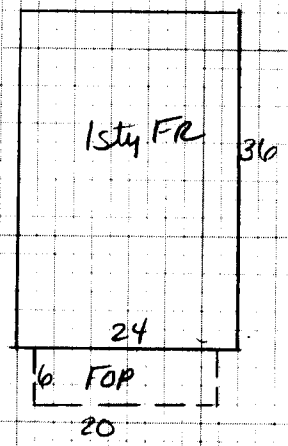

Dwelling <input checked="" type="checkbox"/>	Comp. Sh. <input type="checkbox"/>	Wood Siding <input type="checkbox"/>	Yr. Built OS	Remod. <input type="checkbox"/>	Bsmt. [] 2nd []	Plaster <input type="checkbox"/>	BATH(S) <input checked="" type="checkbox"/> Full <input type="checkbox"/> 1/2 Bath(s)
	Slate <input type="checkbox"/>	Brick <input type="checkbox"/>	No. Stories	1	1st <input checked="" type="checkbox"/> 3rd []	Sheet rock <input checked="" type="checkbox"/>	Modern Bath <input type="checkbox"/> Modern Kitchen <input type="checkbox"/>
	Asbestos <input type="checkbox"/>	Asb. Wood Shg. <input checked="" type="checkbox"/>	S. Level <input type="checkbox"/> S. Foyer <input type="checkbox"/>	Total No. Bedrooms		Ceiled <input type="checkbox"/>	Cent. Heat <input checked="" type="checkbox"/> COAL <input type="checkbox"/> A/C
	Metal <input checked="" type="checkbox"/>	Cin. Block <input type="checkbox"/> Stone <input type="checkbox"/>				Panel <input type="checkbox"/>	Fir. or Wall Furnace <input type="checkbox"/> Stove(s) <input type="checkbox"/>
Wood Frame <input checked="" type="checkbox"/>	Tar & Grav. <input type="checkbox"/>	Stucco <input type="checkbox"/> Con. Block <input type="checkbox"/>	Crawl <input type="checkbox"/> Conc. <input type="checkbox"/>	HW <input type="checkbox"/> Pine <input type="checkbox"/> Carp. <input type="checkbox"/> Tile <input checked="" type="checkbox"/>	Unfinished <input type="checkbox"/>		
Cin. Block <input type="checkbox"/>	Tile <input type="checkbox"/>	Aluminum <input type="checkbox"/> Masonite <input type="checkbox"/>	Riers <input type="checkbox"/> Cin. Blk. <input type="checkbox"/>			Number <input type="checkbox"/>	
Steel Frame <input type="checkbox"/>	Shakes <input type="checkbox"/>	Storm Doors <input type="checkbox"/> Storm Win. <input type="checkbox"/>	Slab <input type="checkbox"/> Brick <input type="checkbox"/>	Disappearing Stairs <input type="checkbox"/>	Gd. <input type="checkbox"/> Fair <input type="checkbox"/> Poor <input type="checkbox"/> VP <input type="checkbox"/>	Number Chimneys <input type="checkbox"/>	
			Basement Size <input checked="" type="checkbox"/> NO	Attic Floor & Stairs <input type="checkbox"/>			Brick [] C. Block []
			Gd. <input type="checkbox"/> Fair <input type="checkbox"/> Poor <input type="checkbox"/> VP <input type="checkbox"/>	Bsmt. Finish <input type="checkbox"/>	1/4 <input type="checkbox"/> 1/2 <input type="checkbox"/> 3/4 <input type="checkbox"/> Full <input type="checkbox"/>	Attic <input type="checkbox"/> Walls <input type="checkbox"/> Fl. <input type="checkbox"/>	Stone [] Metal []

Lot 864 31.5 27216

YR. 86 YR. YR.

Dwelling	F-	16342	80%	3268
Porch <input type="checkbox"/>	120	8	9100	
Porch	3-MOBILE HOMES ON THIS PROPERTY 1-MOBILE HOME HAS AN ADDITION 12x20 1000			
Carport				
Garage				
Cent. A/C				
Basement	M & L	M & L	MOBILE HOME INFORMATION	Market Value All Improvements 4300
Bsmt. Finish	DATE	DATE	Owner	Market Value All Land 16400
Attic	APRP. MR	APRP.	Make Year	20700
Fireplace(s)	DATE 9-10-85	DATE	Size Cond.	
Heating	CLASSIFICATION S	ZONING	Not Home <input type="checkbox"/> Time	
Bath(s)			AM <input type="checkbox"/> PM <input type="checkbox"/>	

Total 28176
Factor .58
Replacement 16342

Land Cost	\$
Bldg. Cost	\$
Sale Price	\$
Rent	\$
Expenses	\$
Net Rent	\$

PROPERTY FACTORS		CLASSIFICATION	ACRES	RATE	ADJ.	CLASSIFICATION	ACRES	RATE	ADJ.
Public Water	Paved	Home Site	4			Home Site			
Public Sewer	Gravel	Poor	21.4	300				10,000	16420
Well	Dirt								
Spring	No Road								
Septic System	Curb & Gutter	Wasteland				Wasteland			
U. G. Utilities	Sidewalk		25.4						16420

General Remarks:

LEVEL SLOPES UP SLOPES DOWN
 LOW STEEP UP STEEP DOWN

BOARD REVIEW NOTES

Clemensfield

27.36
61-525-
4.78
69-72

Charles Phillips
Edna Estate
Henry C. Chasden

1/10 end in
2 trts 27.36 + 4.78

Clouse Phillip (Widower)

11-5-74 180-519

Norman Small Bellows (July)

7-9-81
4-16-86
1/16 in
27.36 + 4.78
234-209

Doyal Phillip (Lain)

8 pts
not standing

Nancy Laforce
1/2
1/10 a
201-16

See Smith

1/16 in
27.24

See Smith
Edna Mae Niece

Edna's pt.
1/16
23K-722

Ronnie Carth (E)

Charles Phillip (C.J.)

1/14 ac.
99-394

Clyde Laforce
Edna Niece

Basil Laforce
Edna Niece

Roy Laforce
Edna Niece

Edna Mae Laforce Niece (Eugene)

for Laforce (Francis)

Edna Niece (Roy)

1/16 ac.
10-19-79
200-148
200-151
M.T. (Sue) Smith
1/2 ea in 1/4 ac.

79 ac in 1/4 ac. - Clyde Smith

1/6 - Nancy Laforce

1/6 - Basil Laforce

1/6 - Edna Mae Laforce

1/6 - Roy Laforce

1/6 - Edna Niece

1/6 - 1/2 Allen Laforce

1/2 ea in 1/4 ac.