

WENTON TREVORE ET ALS  
 BOX 85  
 MCCLURE VA 24269

CLASS	2	LEGAL DESCRIPTION MCCLURE LOT 58
ZONING		
DISTRICT	02	

DATE RECORDED	
DEED OR WILL BOOK	106-479
CONSIDERATION	
DATE RECORDED	
DEED OR WILL BOOK	
CONSIDERATION	
DATE RECORDED	
DEED OR WILL BOOK	
CONSIDERATION	
DATE RECORDED	
DEED OR WILL BOOK	
CONSIDERATION	
DATE RECORDED	
DEED OR WILL BOOK	
CONSIDERATION	

1992	2500	29,500	32,000
1993	2500	29,500	32,000
1994			
1995			
1996			
1997			
1998			
1999			
2000			
2001			
2002			
2003			

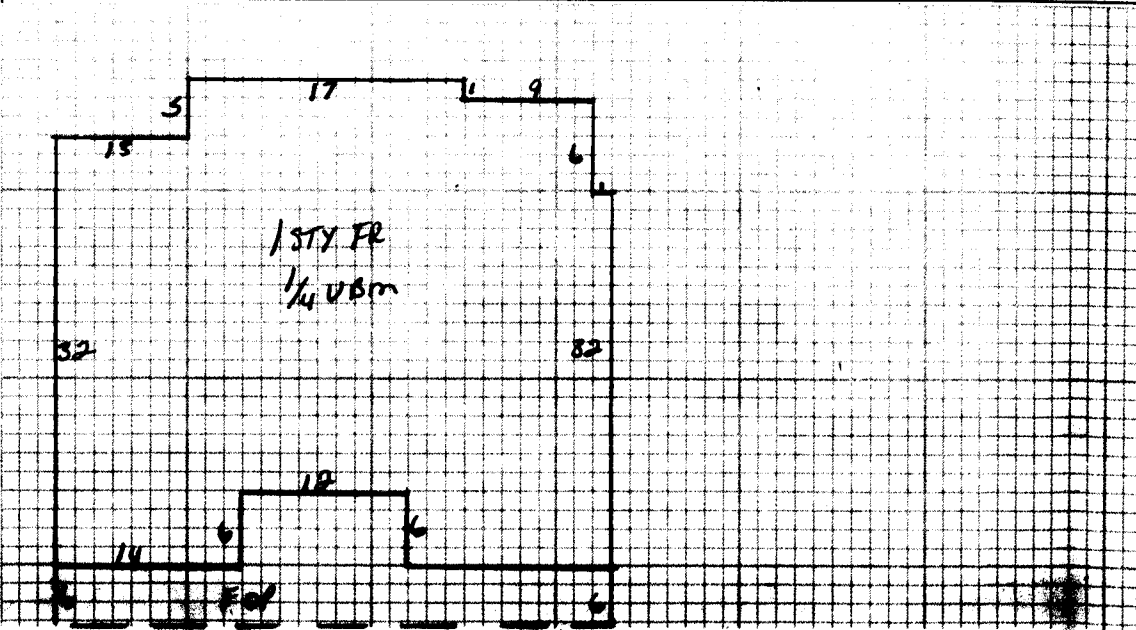

NOTES:

Dwelling	Comp. Sh.	Wood Siding	Yr. Built	Remod.	Basmt.	1st	2nd	3rd	Plaster	BATHS	Full	1/2	Remod.
	State	Brick	No. Stories			1st	2nd	3rd	Sheet rock	Modern Bath			Modern Kitchen
	Asbestos	Asb. Wood Shg.	B. Level	S. Floor	Total No. Bedrooms				Ceiled	Cent. Heat	Cold		AG
	Metal	Cin. Block	Stone						Panel	Fir. or Wall Furnace			Stove
Wood Frame	Tar & Grav.	Stucco	Con. Block	Crawl	Conc.	HW	Fin	Carp.	Tile	Unfinished			
Cin. Block	Tile	Aluminum	Masonry	Riers	Cin. Bk.								
Steel Frame	Shakes	Storm Doors	Storm Win.	Slab	Brick	Disappearing Stairs				Gd.	Fair	Poor	VP

Basement Size	Attic Floor & Stairs	Number	
Gd. Fair Poor VP	Basmt. Finish	1/4	110

1st Yr 1347 29.5 39,736

Yr. 1991	Yr.	Yr.
----------	-----	-----

Dwelling													
Porch													
Porch													
Carport													
Garage													
Cent. A/C													

Basement	336	6.5	2184	M & L	M & L	Owner	Market Value All Improvements	29,500
Basmt. Finish				DATE	DATE	Make	Market Value All Land	2,500
Attic				APRP.	APRP.	Year	TOTAL MARKET VALUE	32,000
Fireplace(s)				DATE	DATE	Size		
Heating			1347	1-7-91		Cond.		
Bath(s)				CLASSIFICATION	ZONING	Not Home		

Total	45,139					AM	PM		Land Cost			
Factor	.87								\$			
Replacement	39,270								Bldg. Cost			

Home Site	LOT			2500	Home Site				Sale Price			
-----------	-----	--	--	------	-----------	--	--	--	------------	--	--	--

Public Water	Paved								\$			
Public Sewer	Gravel								\$			
Well	Dirt								Rent			
Spring	No Road								\$			
Septic System	Curb & Gutter								Expenses			
N.A. Utilities	Sidewalk								\$			

BOARD REVIEW NOTES