

~~EREX Equitable Resources Energy Co~~
~~P O BOX 313 1989 East Stone Dr.~~
~~NOVA VA~~ P.O. Box 1983
 Kingsport, TN 37662
 24272

EQUITABLE PRODUCTION COMPANY
 EAST REGION
 1989 EAST STONE DRIVE
 PO BOX 1983
 KINGSFORT TN 37662-1983

DATE RECORDED	
DEED OR WILL BOOK	
CONSIDERATION	
DATE RECORDED	
DEED OR WILL BOOK	
CONSIDERATION	
DATE RECORDED	
DEED OR WILL BOOK	
CONSIDERATION	
DATE RECORDED	
DEED OR WILL BOOK	
CONSIDERATION	

CLASS	4	LEGAL DESCRIPTION LICK CREEK IMP ONLY
ZONING		
DISTRICT	02	

1992			
1993			
1994		15,700 20,700	15,700 20,700
1995		20,700	20,700
1996			
1997			
1998			
1999			
2000			
2001			
2002			
2003			

TYPE	DATE

NOTES: MOVED PER PERMIT # 124-93 BUILDING TANKS
 NEAR INJECTED WELL.

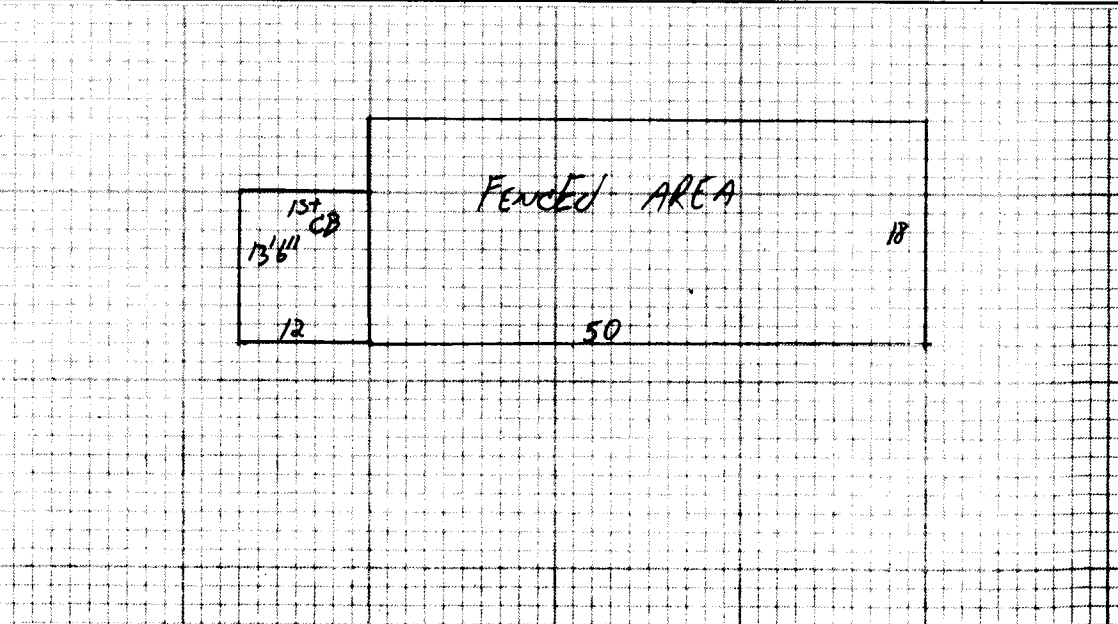

Dwelling	Comp. Sh.	Wood Siding	Yr. Built	Remod.	Bsmt. [] 2nd []	Plaster	BATH(S) Full 1/2 Bath(s)
	Slate	Brick	No. Stories		1st [] 3rd []	Sheet rock	Modern Bath <input type="checkbox"/> Modern Kitchen <input type="checkbox"/>
	Asbestos	Asb. Wood Shg.	S. Level <input type="checkbox"/> S. Foyer <input type="checkbox"/>		Total No. Bedrooms	Ceiled	Cent. Heat <input type="checkbox"/> A/C <input type="checkbox"/>
	Metal	Cin. Block <input type="checkbox"/> Stone <input type="checkbox"/>				Panel	Fir. or Wall Furnace <input type="checkbox"/> Stove(s) <input type="checkbox"/>
Wood Frame	Tar & Grav.	Stucco <input type="checkbox"/> Con. Block <input type="checkbox"/>	Crawl <input type="checkbox"/> Conc. <input type="checkbox"/>	HW <input type="checkbox"/> Pine <input type="checkbox"/> Carp. <input type="checkbox"/> Tile <input type="checkbox"/>	Unfinished		
Cin. Block	Tile	Aluminum <input type="checkbox"/> Masonite <input type="checkbox"/>	Riers <input type="checkbox"/> Cin. Blk. <input type="checkbox"/>				
Steel Frame	Shakes	Storm Doors <input type="checkbox"/> Storm Win. <input type="checkbox"/>	Slab <input type="checkbox"/> Brick <input type="checkbox"/>	Disappearing Stairs		Gd. <input type="checkbox"/> Fair <input type="checkbox"/> Poor <input type="checkbox"/> VP <input type="checkbox"/>	Number

Basement Size	Attic Floor & Stairs	Brick [] C. Block []
Gd. <input type="checkbox"/> Fair <input type="checkbox"/> Poor <input type="checkbox"/> VP <input type="checkbox"/>	Basmt. Finish	Stone [] Metal []
	1/4 <input type="checkbox"/> 1/2 <input type="checkbox"/> 3/4 <input type="checkbox"/> Full <input type="checkbox"/>	Attic <input type="checkbox"/> Walls <input type="checkbox"/> Fl. <input type="checkbox"/>
		YR. 94

	Dwelling	Area	Value	Rate	Value	Rate	Value	Rate
	misc. Bldg. 13x12	156	20	3120				3120
	Con. slab 50x18	900	8	7200				7200
Porch	Fer. Con. + Wire	900	6	5400				5400
Porch	MISC BLDG 16x10	160	20	3200				3200
Carport	Fer. Con + WIRE	300	6	1800				1800
Garage								
Cent. A/C								
Basement	M & L	M & L	Market Value All Improvements		15720			20,700
Basmt. Finish	DATE	DATE	Owner					
Attic	APPR. M.S.	APPR.	Make	Year	15720			20,700
Fireplace(s)	DATE 2-3-94	DATE	Size	Cond.				
Heating	CLASSIFICATION	ZONING	Not Home <input type="checkbox"/> Time					
Bath(s)			AM <input type="checkbox"/> PM <input type="checkbox"/>					
Total			Agric.					Land Cost
Factor			Hort.					\$
Replacement			Forest					Bldg. Cost
			Open Space					\$
			Totals					\$

Property Factors	Classification	Acres	Rate	Adj.	Classification	Acres	Rate	Adj.
Public Water	Home Site				Home Site			
Public Sewer								
Well								
Spring								
Septic System	Wasteland				Wasteland			
U. G. Utilities								

General Remarks:

LEVEL SLOPES UP SLOPES DOWN

LOW STEEP UP STEEP DOWN

BOARD REVIEW NOTES