

BOWMAN IOWA C/O IKE BOWMAN ST RT BOX 278 BIRCHLEAF VA 24220	DATE RECORDED	
	DEED OR WILL BOOK	
	CONSIDERATION	
	DATE RECORDED	
	DEED OR WILL BOOK	
	CONSIDERATION	
	DATE RECORDED	
	DEED OR WILL BOOK	
	CONSIDERATION	
	DATE RECORDED	
	DEED OR WILL BOOK	
	CONSIDERATION	
	DATE RECORDED	
	DEED OR WILL BOOK	
	CONSIDERATION	

CLASS	2	LEGAL DESCRIPTION FRYING PAN IMPROVEMENTS ONLY
ZONING		
DISTRICT	02	

YEAR	VALUE OF LAND	VALUE OF IMPROV.	TOTAL VALUE	
1992		13,500	13,500	
1993		13,500	13,500	
1994				
1995				
1996				
1997				
1998				
1999				
2000				
2001				
2002				
2003				

BUILDING PERMIT					
NO.	TYPE	DATE	% COM.	DATE REC.	APPROVED

NOTES: This DBL wide on Prop. owned by Ike Bowman
 Card # 2113

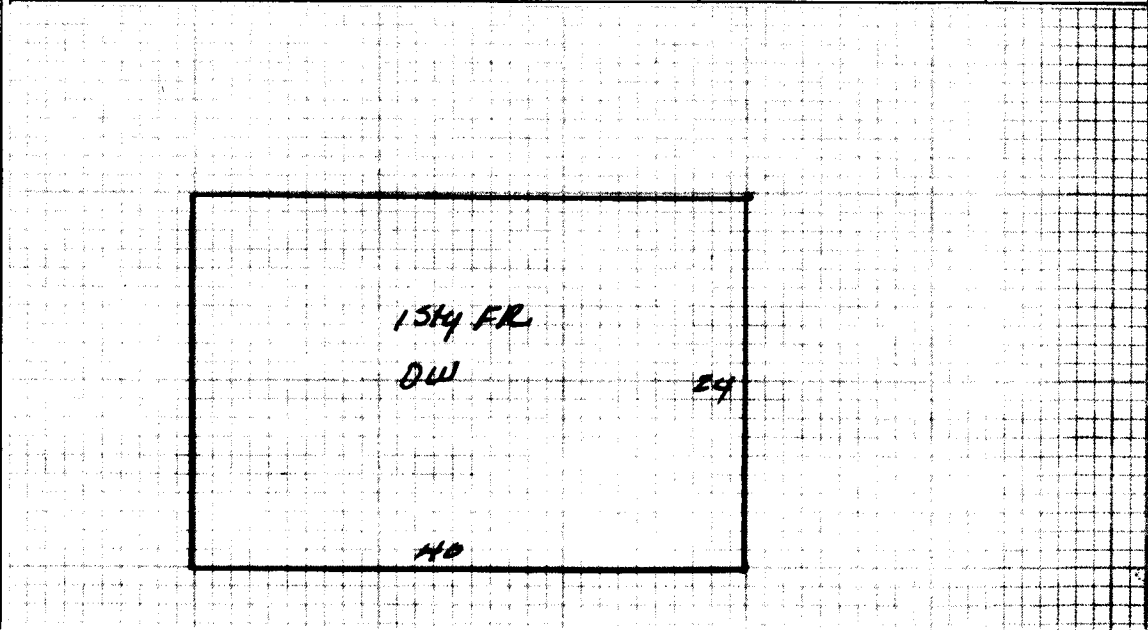

Dwelling	Comp. Sh.	Wood Siding	Yr. Built	Remod.	Bemt. [] 2nd []	Plaster	BATH(S) Full 1/2 Bath(s)
	Slate	Brick	No. Stories		1st [] 3rd []	Sheet rock	Modern Bath <input type="checkbox"/> Modern Kitchen <input type="checkbox"/>
	Asbestos	Asb. Wood Shg.	S. Level <input type="checkbox"/> S. Foyer <input type="checkbox"/>		Total No. Bedrooms	Ceclied	Cent. Heat <input type="checkbox"/> A/C <input type="checkbox"/>
	Metal	Cin. Block <input type="checkbox"/> Stone <input type="checkbox"/>				Panel	Fir. or Wall Furnace <input type="checkbox"/> Stove(s) <input type="checkbox"/>
Wood Frame	Tar & Grav.	Stucco <input type="checkbox"/> Con. Block <input type="checkbox"/>	Crawl <input type="checkbox"/> Conc. <input type="checkbox"/>	HW <input type="checkbox"/> Pine <input type="checkbox"/> Carp. <input type="checkbox"/> Tile <input type="checkbox"/>	Unfinished		
Cin. Block	Tile	Aluminum <input type="checkbox"/> Masonite <input type="checkbox"/>	Riers <input type="checkbox"/> Cin. Blk. <input type="checkbox"/>				Number
Steel Frame	Shakes	Storm Doors <input type="checkbox"/> Storm Win. <input type="checkbox"/>	Slab <input type="checkbox"/> Brick <input type="checkbox"/>	Disappearing Stairs	Gd. <input type="checkbox"/> Fair <input type="checkbox"/> Poor <input type="checkbox"/> VP <input type="checkbox"/>		Number Chimneys

Dw 960 2019,200

Basement Size	Attic Floor & Stairs	Brick [] C. Block []
Gd. <input type="checkbox"/> Fair <input type="checkbox"/> Poor <input type="checkbox"/> VP <input type="checkbox"/>	Basmt. Finish	1/4 <input type="checkbox"/> 1/2 <input type="checkbox"/> 3/4 <input type="checkbox"/> Full <input type="checkbox"/>
		Attic <input type="checkbox"/> Walls <input type="checkbox"/> Fl. <input type="checkbox"/>
		Stone [] Metal []
		YR. 1991

Dwelling	DBL wide	D-	15,936	15%	13,500
Porch					
Porch					
Carport					
Garage					
Cent. A/C					

Basement	M & L	M & L	Market Value All Improvements	13,500
Basmt. Finish			Market Value All Land	
Attic	DATE	DATE	Owner	
Fireplace(s)			Make	Year
Heating	APRP.	APRP.	Size	Cond.
Bath(s)	DATE	DATE	Not Home <input type="checkbox"/> Time	
	Total	19,200	AM <input type="checkbox"/> PM <input type="checkbox"/>	
	Factor	.83		
	Replacement	15,936		

DATE	5-28-91	CLASSIFICATION	ZONING	2	Agric.		Land Cost	
					Hort.		\$	
					Forest		Bldg. Cost	
					Open Space		\$	
					Totals		Sale Price	
							\$	
							Rent	
							\$	
							Expenses	
							\$	
							Net Rent	
							\$	

CLASSIFICATION	ACRES	RATE	ADJ.	CLASSIFICATION	ACRES	RATE	ADJ.
Home Site				Home Site			
Public Water	Paved						
Public Sewer	Gravel						
Well	Dirt						
Spring	No Road						
Septic System	Curb & Gutter	Wasteland		Wasteland			
U. G. Utilities	Sidewalk						

General Remarks:

LEVEL SLOPES UP SLOPES DOWN

LOW STEEP UP STEEP DOWN

BOARD REVIEW NOTES