

ERVINTON DISTRICT

00000000017866

RECORD OF OWNERSHIP

COLLINS JOHN JR & STEPHANIE  
~~P O BOX 24~~ Rt. 2 Box 548 A  
 HAYSI VA

24256

DATE RECORDED 12/3/91  
 DEED OR WILL BOOK DB 0277 0105

CONSIDERATION

DATE RECORDED

DEED OR WILL BOOK

CONSIDERATION

DATE RECORDED

DEED OR WILL BOOK

CONSIDERATION

DATE RECORDED

DEED OR WILL BOOK

CONSIDERATION

DATE RECORDED

DEED OR WILL BOOK

CONSIDERATION

BUILDING PERMITS

NO.	TYPE	DATE	% COMP.	DATE FINAL	APPRAISAL	APPRAISAL

NOTES: From Edna Thomas 204-088 card #4025

CLASS 2  
 ZONING  
 DISTRICT 02

LEGAL DESCRIPTION  
 LICK CREEK  
 0.25 AC  
 178-147D (A) 1551-A

YEAR	VALUE OF LAND	VALUE OF IMPROV.	TOTAL VALUE	ACRES
1992				
1993				
1994	2,500	22,500	25,000	
1995				
1996				
1997				
1998				
1999				
2000				
2001				
2002				
2003				

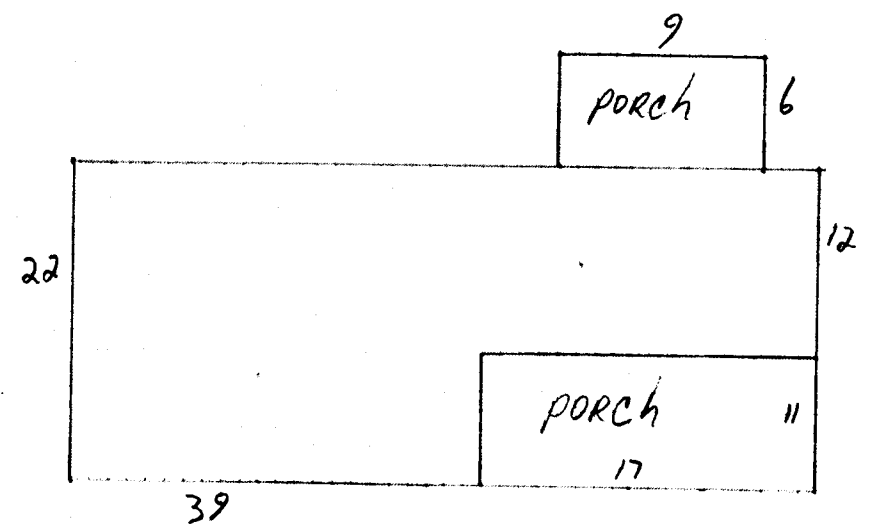

Dwelling	Comp. Sh.	Wood Siding	Yr. Built	Remod.	Bsmt. [ ] 2nd [ ]	Plaster	BATH(S) Full 1/2 Bath(s)
	Slate	Brick	No. Stories		1st [ ] 3rd [ ]	Sheet rock	Modern Bath [ ] Modern Kitchen [ ]
	Asbestos	Asb. Wood Shg.	S. Level [ ] S. Foyer [ ]		Total No. Bedrooms	Ceciled	Cent. Heat [ ] A/C [ ]
	Metal	Cin. Block [ ] Stone [ ]				Panel	Fir. or Wall Furnace [ ] Stove(s) [ ]
Wood Frame	Tar & Grav.	Stucco [ ] Con. Block [ ]	Crawl [ ] Conc. [ ]	HW [ ] Pine [ ] Carp. [ ] Tile [ ]	Unfinished		
Cin. Block	Tile	Aluminum [ ] Masonite [ ]	Riers [ ] Cin. Blk. [ ]				Number
Steel Frame	Shakes	Storm Doors [ ] Storm Win. [ ]	Slab [ ] Brick [ ]	Disappearing Stairs		Gd. [ ] Fair [ ] Poor [ ] VP [ ]	Number Chimneys

ITEM	SIZE	RATE	VALUE	RATE	VALUE	Gd. [ ] Fair [ ] Poor [ ] VP [ ]	Basmt. Finish	Attic Floor & Stairs	Attic [ ] Walls [ ] Fl. [ ]	Stone [ ] Metal [ ]
1STY	869	31	26929							

LINE	DESCRIPTION	SIZE	GRADE	AGE	RATE	REPLACEMENT	COND.	DEPR.	YR.	Market Value	Market Value	Market Value
	Dwelling		D			24694		10%	1994	22224		
	Cinder Block Storage Bldg.								FV	300		
Porch	54	6	324									
Porch	187	6	1122									
Carport												
Garage												
Cent. A/C												
Basement												

Bsmt. Finish	M & L	M & L	MOBILE HOME INFORMATION	Market Value All Improvements	22500
Attic	DATE	DATE	Owner	Market Value All Land	2500
Fireplace(s)	APBP	APRP.	Make	TOTAL MARKET VALUE	25000
Heating	DATE	DATE	Size	Cond.	
Bath(s)	DATE	DATE	Not Home [ ] Time	Acreage	Use Value
Total	28385		AM [ ] PM [ ]		
Factor	.87		INFORMATION BY		
Replacement	24694		CLASSIFICATION	ZONING	

FRONTAGE	DEPTH	SQUARE FOOTAGE	UNIT PRICE	DEPTH FACTOR	FRONT FT. RATE	TOTAL	ADJ.	10 TOTAL APPRAISAL	UNIT PRICE	DEPTH FACTOR	FRONT FT. RATE	TOTAL	ADJ.	10 TOTAL APPRAISAL
								94						

PROPERTY FACTORS	CLASSIFICATION	ACRES	RATE	ADJ.	CLASSIFICATION	ACRES	RATE	ADJ.
Utilities	Home Site				Home Site			
Street or Road								
Public Water	Paved	.25						
Public Sewer	Gravel							
Well	Dirt							
Spring	No Road							
Septic System	Curb & Gutter							
U. G. Utilities	Sidewalk							
	Wasteland				Wasteland			
	Total Acreage	.25			Total Acreage			
	Total Value Land				Total Value Land			2500

LEVEL [ ] SLOPES UP [ ] SLOPES DOWN [ ]	General Remarks: Trailer Built Around
LOW [ ] STEER UP [ ] STEEP DOWN [ ]	

Property and Income Information	Land Cost	\$
	Bldg. Cost	\$
	Sale Price	\$
	Rent	\$
	Expenses	\$
	Net Rent	\$

BOARD REVIEW NOTES

865-5319

1992 DICKENSON COUNTY REAL ESTATE TAX		1992 DICKENSON COUNTY REAL ESTATE TAX	
DISTRICT ERVINTON DISTRICT NUMBER 1655 TAX LEVY .65		DISTRICT ERVINTON DISTRICT NUMBER 1655 TAX LEVY .65	
LAND VALUE	IMPROVEMENT OR BLDG. VALUE	LAND VALUE	IMPROVEMENT OR BLDG. VALUE
2500	22500	2500	22500
TOTAL VALUE	TOTAL VALUE	TOTAL VALUE	TOTAL VALUE
25000	25000	25000	25000
TAX DUE DECEMBER 5 162.50		TAX DUE DECEMBER 5 162.50	
DESCRIPTION 0000000017866 LICK CREEK 0.25 AC 178-147D (A) 1551-A		DESCRIPTION 0000000017866 LICK CREEK 0.25 AC 178-147D (A) 1551-A	
COLLINS JOHN JR & STEPHANIE P O BOX 24 HAYSI VA 24256		COLLINS JOHN JR & STEPHANIE P O BOX 24 HAYSI VA 24256	
DO NOT SEPARATE THESE TICKETS RETURN BOTH PORTIONS TO TREASURER'S OFFICE FOR VALIDATION.		DO NOT SEPARATE THESE TICKETS RETURN BOTH PORTIONS TO TREASURER'S OFFICE FOR VALIDATION.	
SEE REVERSE SIDE FOR FURTHER INSTRUCTIONS AND INFORMATION ON PAYING BY MAIL.		SEE REVERSE SIDE FOR FURTHER INSTRUCTIONS AND INFORMATION ON PAYING BY MAIL.	