

MILAN DEBRA ANN  
BOX 894  
CLINTWOOD VA 24228

DATE RECORDED 8-14-87  
DEED OR WILL BOOK 246-347  
CONSIDERATION 37,000

CLASS 2  
ZONING  
DISTRICT 01

LEGAL DESCRIPTION  
GEORGES FORK  
2.87 AC

DATE RECORDED	
DEED OR WILL BOOK	
CONSIDERATION	
DATE RECORDED	
DEED OR WILL BOOK	
CONSIDERATION	
DATE RECORDED	
DEED OR WILL BOOK	
CONSIDERATION	
DATE RECORDED	
DEED OR WILL BOOK	
CONSIDERATION	

1992	4200	26700	30900
1993	4200	26700	30900
1994			
1995			
1996			
1997			
1998			
1999			
2000			
2001			
2002			
2003			

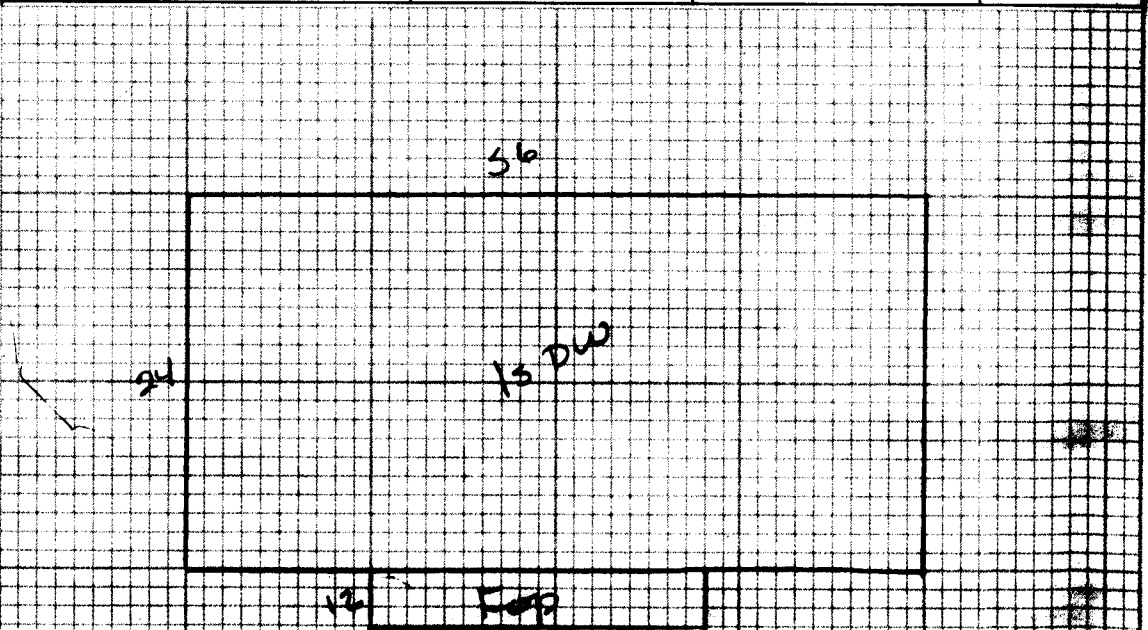

NOTES:

DW	Dwelling	<input checked="" type="checkbox"/>	Comp. Sh.	<input checked="" type="checkbox"/>	Wood Siding	<input type="checkbox"/>	Yr. Built <u>78</u>	Remod.	<input type="checkbox"/>	Bemt.	<input type="checkbox"/>	1st <input type="checkbox"/>	2nd <input type="checkbox"/>	Plaster	<input type="checkbox"/>	BATHS	Full <input type="checkbox"/>	1/2 <input type="checkbox"/>
			Stone	<input type="checkbox"/>	Brick	<input type="checkbox"/>	No. Stories	<input type="checkbox"/>	1st <input checked="" type="checkbox"/>	2nd <input type="checkbox"/>	Sheet rock	<input type="checkbox"/>	Modern Bath <input type="checkbox"/>	Modern Kitchen <input type="checkbox"/>				
			Asbestos	<input type="checkbox"/>	Aab. Wood Shg.	<input type="checkbox"/>	S. Level <input type="checkbox"/>	S. Floor <input type="checkbox"/>	Total No. Bedrooms	<input type="checkbox"/>	Cooked	<input type="checkbox"/>	Cont. Heat <input checked="" type="checkbox"/>	A/C	<input type="checkbox"/>			
			Metal	<input type="checkbox"/>	Cin. Block <input type="checkbox"/>	Stone <input type="checkbox"/>					Panel	<input checked="" type="checkbox"/>	Flr. or Wall Furnace <input type="checkbox"/>	Stove <input type="checkbox"/>				
		Wood Frame	<input checked="" type="checkbox"/>	Tar & Grav.	<input type="checkbox"/>	Stucco <input type="checkbox"/>	Con. Block <input type="checkbox"/>	Crawl <input type="checkbox"/>	Conc. <input type="checkbox"/>	MW <input type="checkbox"/>	Pine <input type="checkbox"/>	Corp. <input checked="" type="checkbox"/>	Tile <input checked="" type="checkbox"/>	Unfinished	<input type="checkbox"/>			

<u>15 PR</u>	<u>1344</u>	<u>28</u>	<u>37632</u>														
Porch	<u>288</u>	<u>10</u>	<u>2880</u>														
Porch																	
Carport																	
Garage																	
Cent. A/C																	
Basement																	



General Remarks:

SLOPES UP  SLOPES DOWN

STEEP UP  STEEP DOWN