

ERVINTON DISTRICT

00000000017448

|          |    |  |
|----------|----|--|
| CLASS    | 2  | LEGAL DESCRIPTION<br>TRAMMEL<br>LOT 30 |
| ZONING   |    |  |
| DISTRICT | 02 |  |

LEFTWICH MILDRED REGINA  
RT 1 BOX 1002  
TRAMMEL VA

24289

DATE RECORDED **9-2-86**  
DEED OR WILL BOOK DB 0239 0746  
CONSIDERATION **3000.00**

|      |       |       |       |
|------|-------|-------|-------|
| 1992 |       |       |       |
| 1993 |       |       |       |
| 1994 | 1,500 | 2,700 | 4,200 |
| 1995 | 1,500 | 2,700 | 4,200 |
| 1996 |       |       |       |
| 1997 |       |       |       |
| 1998 |       |       |       |
| 1999 |       |       |       |
| 2000 |       |       |       |
| 2001 |       |       |       |
| 2002 |       |       |       |
| 2003 |       |       |       |

DATE RECORDED  
DEED OR WILL BOOK  
CONSIDERATION

DATE RECORDED  
DEED OR WILL BOOK  
CONSIDERATION

DATE RECORDED  
DEED OR WILL BOOK  
CONSIDERATION

DATE RECORDED  
DEED OR WILL BOOK  
CONSIDERATION

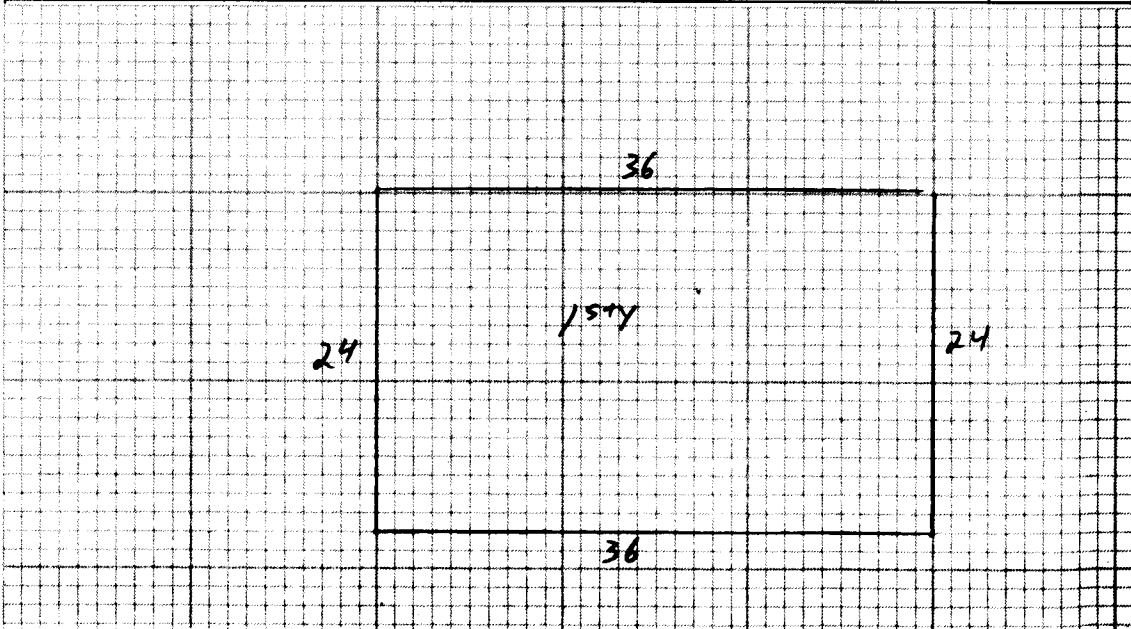

NOTES: *Jm. Byrd Estate*  
*239-746 Deed of Correction*

|             |                                     |             |                                     |  |                                     |   |        |  |            |   |
|-------------|-------------------------------------|-------------|-------------------------------------|--|-------------------------------------|---|--------|--|------------|---|
| Dwelling    | <input checked="" type="checkbox"/> | Comp. Sh.   | <input checked="" type="checkbox"/> | Wood Siding  | <input checked="" type="checkbox"/> | Yr. Built   | Remod. | Bmnt. [ ] 2nd [ ]  | Plaster    | BATH(S) Full 1/2 Bath(s)  |
|             |                                     | Slate       |                                     | Brick  |                                     | No. Stories   | /      | 1st [ ] 3rd [ ]  | Sheet rock | Modern Bath <input type="checkbox"/> Modern Kitchen <input type="checkbox"/>    |
|             |                                     | Asbestos    |                                     | Asb. Wood Shg.   |                                     | S. Level <input type="checkbox"/> S. Foyer <input type="checkbox"/> |        | Total No. Bedrooms   | Ceciled    | Cent. Heat <input type="checkbox"/> A/C <input type="checkbox"/>                |
|             |                                     | Metal       |                                     | Cin. Block <input type="checkbox"/> Stone <input type="checkbox"/>       |                                     |   |        |  | Panel      | Fir. or Wall Furnace <input type="checkbox"/> Stove(s) <input type="checkbox"/> |
| Wood Frame  | <input checked="" type="checkbox"/> | Tar & Grav. |                                     | Stucco <input type="checkbox"/> Con. Block <input type="checkbox"/>      |                                     | Crawl <input type="checkbox"/> Conc. <input type="checkbox"/>       |        | HW <input type="checkbox"/> Pine <input type="checkbox"/> Carp. <input type="checkbox"/> Tile <input type="checkbox"/> | Unfinished |   |
| Cin. Block  |                                     | Tile        |                                     | Aluminum <input type="checkbox"/> Masonite <input type="checkbox"/>      |                                     | Riers <input type="checkbox"/> Cin. Blk. <input type="checkbox"/>   |        |  |            |   |
| Steel Frame |                                     | Shakes      |                                     | Storm Doors <input type="checkbox"/> Storm Win. <input type="checkbox"/> |                                     | Slab <input type="checkbox"/> Brick <input type="checkbox"/>        |        | Disappearing Stairs  |            |   |

|               |  |                      |  |  |  |              |  |  |  |  |  |   |  |
|---------------|--|----------------------|--|--|--|--------------|--|--|--|--|--|---|--|
| Basement Size |  | Attic Floor & Stairs |  | Gd. <input type="checkbox"/> Fair <input type="checkbox"/> Poor <input type="checkbox"/> VP <input type="checkbox"/> |  | Bmnt. Finish |  | 1/4 <input type="checkbox"/> 1/2 <input type="checkbox"/> 3/4 <input type="checkbox"/> Full <input type="checkbox"/> |  | Attic <input type="checkbox"/> Walls <input type="checkbox"/> Fl. <input type="checkbox"/> |  | Stone <input type="checkbox"/> Metal <input type="checkbox"/> |  |
| 1574          |  | 864                  |  | 29   |  | 25,056       |  |  |  | YR. 94   |  | YR.   |  |

|           |       |    |        |     |      |
|-----------|-------|----|--------|-----|------|
| Dwelling  | 24436 | E- | 17,789 | 85% | 2668 |
| Porch     |       |    |        |     |      |
| Porch     |       |    |        |     |      |
| Carport   |       |    |        |     |      |
| Garage    |       |    |        |     |      |
| Cent. A/C |       |    |        |     |      |

|              |                  |        |  |       |
|--------------|------------------|--------|--|-------|
| Basement     | M & L            | M & L  | Market Value All Improvements          | 2700  |
| Bmnt. Finish | DATE             | DATE   | Market Value All Land                  | 1500  |
| Attic        | APRP. MS         | APRP.  | Make                                   | Year  |
| Fireplace(s) | DATE 2-2-94      | DATE   | Size                                   | Cond. |
| Heating      |                  |        | Not Home <input type="checkbox"/> Time |       |
| Bath(s)      | CLASSIFICATION 2 | ZONING | Agric.                                 |       |
| Total        | 25,056           |        | Hort.                                  |       |
| Factor       | .71              |        | Forest                                 |       |
| Replacement  | 17,789           |        | Open Space                             |       |
|              |                  |        | Totals                                 |       |

|            |  |
|------------|--|
| Land Cost  |  |
| Bldg. Cost |  |
| Sale Price |  |
| Rent       |  |
| Expenses   |  |
| Net Rent   |  |

| PROPERTY TAXES  | CLASSIFICATION | ACRES | RATE | ADJ. | CLASSIFICATION | ACRES | RATE | ADJ. |
|-----------------|----------------|-------|------|------|----------------|-------|------|------|
| Public Water    | Paved          |       |      |      | Home Site      |       |      |      |
| Public Sewer    | Gravel         |       |      |      |                |       |      |      |
| Well            | Dirt           |       |      |      |                |       |      |      |
| Spring          | No Road        |       |      |      |                |       |      |      |
| Septic System   | Curb & Gutter  |       |      |      | Wasteland      |       |      |      |
| U. G. Utilities | Sidewalk       |       |      |      |                |       |      |      |
|                 |                | 10+   | 800  | 1500 |                |       |      |      |
|                 |                |       |      |      |                |       |      |      |
|                 |                |       |      |      |                |       |      |      |
|                 |                |       |      |      |                |       |      |      |
|                 |                | 10+   |      | 1500 |                |       |      |      |

General Remarks:

LEVEL  SLOPES UP  SLOPES DOWN

LOW  STEEP UP  STEEP DOWN

BOARD REVIEW NOTES