

LEITCH MILDRED REGINA
 TRAMMEL VA
 Rt. 1 Box 1002
 Trammel, VA 24237

24299

DATE RECORDED 9-2-86
 DEED OR WILL BOOK 239-746
 238-22
 CONSID-ERATION 3000.00

CLASS 2
 ZONING
 DISTRICT 02
 LEGAL DESCRIPTION
 TRAMMEL
 LOT 30

1992	1500	2700	4200
1993	1500	2700	4200
1994			
1995			
1996			
1997			
1998			
1999			
2000			
2001			
2002			
2003			

DATE RECORDED	
DEED OR WILL BOOK	
CONSID-ERATION	
DATE RECORDED	
DEED OR WILL BOOK	
CONSID-ERATION	
DATE RECORDED	
DEED OR WILL BOOK	
CONSID-ERATION	
DATE RECORDED	
DEED OR WILL BOOK	
CONSID-ERATION	

BUILDING PERMITS

NO.	TYPE	DATE	% COMP.	DATE FINAL	APPROVAL	APPROVAL

NOTES: from: Byrd E state
 239-746 - Deed of Connection

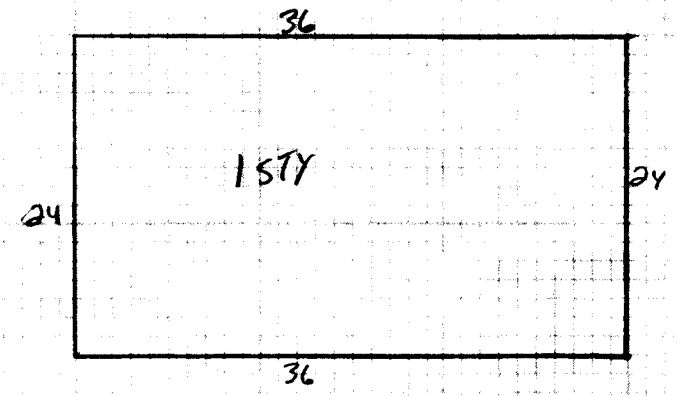

Dwelling <input checked="" type="checkbox"/>	Comp. Sh. <input checked="" type="checkbox"/>	Wood Siding <input checked="" type="checkbox"/>	Yr. Built	Remod.	Bemt. [] 2nd []	Plaster	BATH(S) Full 1/2 Bath(s)
	Slate	Brick	No. Stories		1st [] 3rd []	Sheet rock	Modern Bath <input type="checkbox"/> Modern Kitchen <input type="checkbox"/>
	Asbestos	Asb. Wood Shg.	S. Level <input type="checkbox"/> S. Foyer <input type="checkbox"/>		Total No. Bedrooms	Ceiled	Cent. Heat <input type="checkbox"/> A/C <input type="checkbox"/>
	Metal	Cin. Block <input type="checkbox"/> Stone <input type="checkbox"/>				Panel	Fir. or Wall Furnace <input type="checkbox"/> Stove(s) <input type="checkbox"/>
Wood Frame <input checked="" type="checkbox"/>	Tar & Grav.	Stucco <input type="checkbox"/> Con. Block <input type="checkbox"/>	Crawl <input type="checkbox"/> Conc. <input type="checkbox"/>	HW <input type="checkbox"/> Pine <input type="checkbox"/> Carp. <input type="checkbox"/> Tile <input type="checkbox"/>	Unfinished		
Cin. Block	Tile	Aluminum <input type="checkbox"/> Masonite <input type="checkbox"/>	Riers <input type="checkbox"/> Cin. Blk. <input type="checkbox"/>				Number
Steel Frame	Shakes	Storm Doors <input type="checkbox"/> Storm Win. <input type="checkbox"/>	Slab <input type="checkbox"/> Brick <input type="checkbox"/>	Disappearing Stairs		Gd. <input type="checkbox"/> Fair <input type="checkbox"/> Poor <input type="checkbox"/> VP <input type="checkbox"/>	Number Chimneys

Basement Size		Attic Floor & Stairs		Brick [] C. Block []	
Gd. <input type="checkbox"/> Fair <input type="checkbox"/> Poor <input type="checkbox"/> VP <input type="checkbox"/>		Basmt. Finish		1/4 <input type="checkbox"/> 1/2 <input type="checkbox"/> 3/4 <input type="checkbox"/> Full <input type="checkbox"/>	
		Attic <input type="checkbox"/> Walls <input type="checkbox"/> Fl. <input type="checkbox"/>		Stone [] Metal []	

1STX 864 29 25,056

YR. 1991

Dwelling	24x36	E-	17,789	85%	2668
Porch					
Porch					
Carport					
Garage					
Cent. A/C					

Basement	M & L	M & L	Market Value All Improvements	2700
Basmt. Finish	DATE	DATE	Market Value All Land	1500
Attic	APRP.	APRP.	TOTAL MARKET VALUE	4200
Fireplace(s)	DATE	DATE		
Heating	mc			
Bath(s)	DATE	DATE		

Total	25,056	CLASSIFICATION	2	ZONING	
Factor	71				
Replacement	17,789				

CLASSIFICATION	ACRES	RATE	ADJ.	CLASSIFICATION	ACRES	RATE	ADJ.
Home Site	LOT	800		Home Site			

Public Water	Paved				
Public Sewer	Gravel				
Well	Dirt				
Spring	No Road				
Septic System	Curb & Gutter	Wasteland		Wasteland	
U. G. Utilities	Sidewalk	LOT		1500	

General Remarks:

LEVEL SLOPES UP SLOPES DOWN

LOW STEEP UP STEEP DOWN

Land Cost	
\$	
Bldg. Cost	
\$	
Sale Price	
\$	
Rent	
\$	
Expenses	
\$	
Net Rent	
\$	
BOARD REVIEW NOTES	