

CLASS	3	LEGAL DESCRIPTION GEORGES FORK .6 AC
ZONING		
DISTRICT	01	

ROSE PAUL & BERTHA
RT 2 BOX 47
CLINTWOOD VA

24228

DATE RECORDED	7-24-84
DEED OR WILL BOOK	223-215
CONSIDERATION	30,000

1992	4500	14,700	19,200
1993	4500	14700	19200
1994			
1995			
1996			
1997			
1998			
1999			
2000			
2001			
2002			
2003			

DATE RECORDED	
DEED OR WILL BOOK	
CONSIDERATION	
DATE RECORDED	
DEED OR WILL BOOK	
CONSIDERATION	
DATE RECORDED	
DEED OR WILL BOOK	
CONSIDERATION	

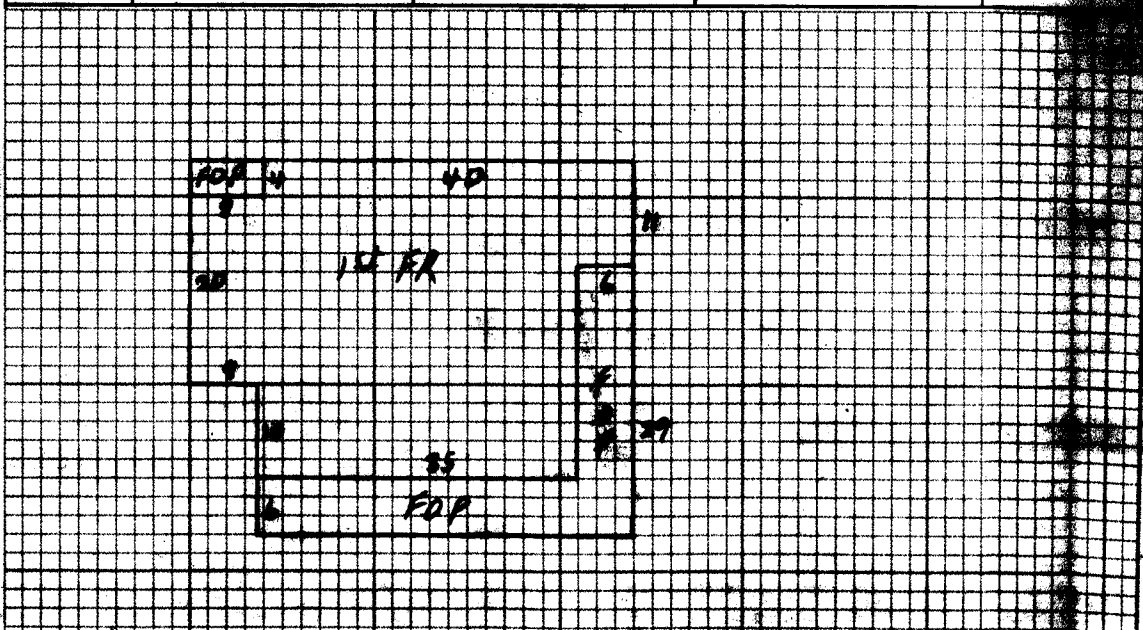

NOTES:

Dwelling <input checked="" type="checkbox"/>	Cont. Sh. <input checked="" type="checkbox"/>	Wood Siding <input checked="" type="checkbox"/>	Vt. Bath <input checked="" type="checkbox"/> Panel	Stair <input type="checkbox"/> 1st <input type="checkbox"/>	Roofing <input type="checkbox"/>	BATHS <input checked="" type="checkbox"/> Full
State	Asbestos	Brick	No. Stories <input type="checkbox"/> /	1st <input type="checkbox"/> 2nd <input type="checkbox"/>	Sheet rock <input checked="" type="checkbox"/>	Modern Bath <input type="checkbox"/> Modern Kitchen <input type="checkbox"/>
Wood Frame <input checked="" type="checkbox"/>	Tile	Ash Wood Sdg.	Pl. <input type="checkbox"/> & Floor <input type="checkbox"/>	Wall <input type="checkbox"/> & Ceiling <input type="checkbox"/>	Concrete <input type="checkbox"/>	Cont. Heat <input checked="" type="checkbox"/> /
Ch. Siding	Tr & Grv.	Cl. Siding <input type="checkbox"/> Slate <input type="checkbox"/>	Chim. <input type="checkbox"/> Cap. <input type="checkbox"/>	Fl. <input type="checkbox"/> & S. <input type="checkbox"/> /	Plaster <input type="checkbox"/>	Fir or Hard Plywood <input type="checkbox"/>
		Stucco <input type="checkbox"/> Cor. Siding <input type="checkbox"/>	Roof <input type="checkbox"/> Ch. Sdg. <input type="checkbox"/>	Sh. <input type="checkbox"/> or Brick <input type="checkbox"/>	Foundation <input type="checkbox"/>	Number <input type="checkbox"/>
		Aluminum <input type="checkbox"/> Synthetic <input type="checkbox"/>	Slab <input type="checkbox"/> or Brick <input type="checkbox"/>	Decorating Sides	Handrail <input type="checkbox"/>	Number Garages <input type="checkbox"/>
		Brick <input type="checkbox"/> or Stone <input type="checkbox"/>	Staircase Size <input type="checkbox"/>	Attic Floor & Stairs	Arch. <input type="checkbox"/> or C. Siding <input type="checkbox"/>	
		Decorative Siding <input type="checkbox"/>	Staircase	Walls <input type="checkbox"/> Pl. <input type="checkbox"/>	Panel <input type="checkbox"/> Metal <input type="checkbox"/>	

1250 194 187

D- 36632 100 14700

384 8 3072

Wash									
Wash									
Garment									
Garage									
Cont. A/C									
Basement									
Spvt. Finish									
Stucco									
Fireplace(s)									
Plumbing									
Roof(s)									
Total	44136								
Factor	.83								
Replacement	36632								

M & L	M & L		Market Value of Improvements	14,200
DATE	DATE	Grav	Market Value of Land	4,500
		Site		18,700
APPR.	APPR.	Site		
DATE	DATE	Not Home <input type="checkbox"/>	Time	
3-12-91				
CLASSIFICATION	ZONING	Agri.		
2		Not.		
		Forest		
		Open Space		
		Land		

	CLASSIFICATION	ACRES	RATE	ADJ.		CLASSIFICATION	ACRES	RATE	ADJ.
Public Water	Paved					Home Site			
Public Sewer	Gravel				4500	Home Site			
Well	Dir								
Spring	No Road								
Septic System	Curb & Gutter					Wetland			
A. G. UTILITIES	Sidewalk	.6			4500				

BOARD REVIEW NOTES