

JOHN JIM & MARY
BOX 161
MOCLURE VA 24269

DATE RECORDED 6-21-84
DEED OR WILL BOOK 222-525
CONSIDERATION \$3,500

CLASS 2
ZONING
DISTRICT 02

LEGAL DESCRIPTION
CANEY CREEK ESTATES
LOT #5
0.34 AC

DATE RECORDED	
DEED OR WILL BOOK	
CONSIDERATION	
DATE RECORDED	
DEED OR WILL BOOK	
CONSIDERATION	
DATE RECORDED	
DEED OR WILL BOOK	
CONSIDERATION	
DATE RECORDED	
DEED OR WILL BOOK	
CONSIDERATION	

1992	3000	49,000	43,000	
1993	3000	40,000	43,000	
1994				
1995				
1996				
1997				
1998				
1999				
2000				
2001				
2002				
2003				

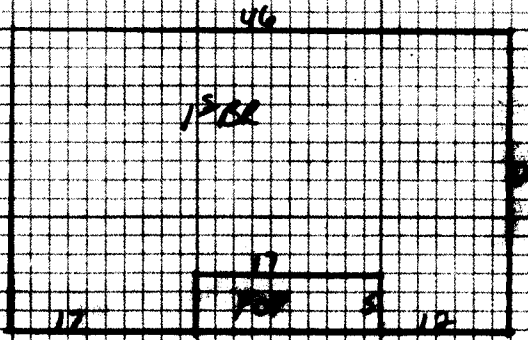

NOTES:

Dwelling	Comp. Sh.	Wood Siding	Yr. Built	Placed	Roof	Plaster	BATHS	Full	% Bath
	Shale	Brick	No. Stories		1st 2nd 3rd	Sheet rock	Modern Bath		Modern
	Asbestos	Ash. Wood Sdg.	B. Level	B. Floor		Quilted	Cont. Heat	Elec	100
	Metal	Cln. Block	Col. Block	Stone		Plaid	Pl. or Wall Furnace		
Wood Frame	Tar & Grav.	Sheds	Conc.	Conc.	Attic Floor & Stairs	Unfinished			
Cln. Block	Title	Aluminum	Masonite	Flare	Cln. Blk.		Number	100	
Steel Frame	Shingles	Storm Doors	Storm Win.	Slab	Brick	Disappearing Stairs	Number Chimneys		
							Brick		C. Block
							Stone		Metal

1111 36.6 40,651

YR. 1991

Dwelling	C-	40,388	58	38,368		
Roof	85	8	680	Concrete block Storage Bldg	FU	200
Roof	120	7	840	Concrete Drive	FU	400
Garage						
Driv. AC						
Basement	M & L	M & L	Market Value All Improvements	40,000		
Basement Finish	DATE	DATE	Market Value All Land	3000		
Basement	APRP.	APRP.	Owner			
Basement	DATE	DATE	Make	Year		
Basement	CLASSIFICATION	ZONING	Size	Cond.		
Basement	2		Not Home	Time		
Basement			AM	PM		
Total	42,071	2-17-91	Agric.			
Factor	.96		Hort.			
Replacement	40,388		Forest			
			Open Space			
			Totals			
			Land Cost			
			Bldg. Cost			
			Sale Price			
			Rent			
			Expenses			
			Net Rent			

CLASSIFICATION	ACRES	RATE	ADJ.	CLASSIFICATION	ACRES	RATE	ADJ.
Home Site	.34		3000	Home Site			
Public Water	Paved						
Public Sewer	Gravel						
Well	Dirt						
Drain	No Road						
Electric System	Curb & Gutter	Wetland		Wetland			
Water Utilities		.34	3000				

BOARD REVIEW NOTES