

SANDLICK DISTRICT

00000000013458

EDWARDS CLARENCE & BERTHA
~~RT BOX~~ Rt HCO1 Baf 84
 BIRCHLEAF VA

24220

DATE RECORDED 8/25/31
 DEED OR WILL BOOK DB 0209 0349
 CONSIDERATION 1600

CLASS 2
 ZONING
 DISTRICT 04

LEGAL DESCRIPTION
 LICK CREEK
~~5.0 AC~~
 30 AC

1992			
1993			
1994	4,200	7,500	11,700
1995	4,200	7,500	11,700
1996			
1997			
1998			
1999			
2000			
2001			
2002			
2003			

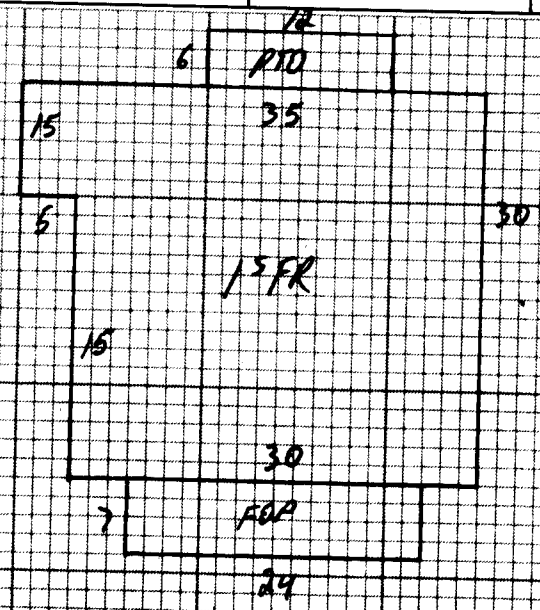

NOTES: See Card # 16922 for information on how this card was changed back to 30 AC

of acknowledgment record in deed book no 118 page 551.

Teste Frenchman O'Quinn Clerk
By Frenchman O'Quinn

CLARENCE EDWARDS ET ALS *
TO I DEED NO. 340444 *
CARL RUFUS EDWARDS *

Edwards, his wife, parties of the first part and Carl Rufus Edwards, party of the
second part.



THIS DEED, made and entered into this July

* 29, 1960, by and between Clarence Edwards and Bertha

Edwards, his wife, parties of the first part and Carl Rufus Edwards, party of the
second part.

WITNESSETH:

That forand in consideration of natural love and affection
the parties of the first part do hereby grant, sell and conveyunto the party of the
second part, with covenants of general warranty, all of that certain tract or parcel
of land lying and being in Dickenson County, Virginia on the waters of Lick Creek
and bounded and described as follows:

BEGINNING at a beech on Upper Hurrigan Branch, S 3 30 W 33 poles to
a bunch of lynns; S 29 E 36 poles to a hickory; S 49 W 18 poles to a hickory on
a spur; N 35 W 40 poles to a hickory in a gap; N 13 W 15 poles to a mpale on a knob;
N 75 W 27½ poles to a white oak near a new fence; down a spur N 20 30 W 26 poles
to a chestnut oak by a fence; N 54 W 13 poles to a chestnut oak; N 2- E 50½ poles
to a small sugar tree by a branch; thencedown said branch N 55 30 W 15 poles to a
small lynn; N 49 E 23 poles to a small white oak; N 64 E 32 poles to a hickory
in a rocky place; N 46 30 E 17 poles to a chesnut oak on a knob; N 75 E 10½ poles
to sone sassafras; S 67 E 12½ poles to a small oak bush; N 68 30 E 7 poles to a
chestnut oak; S 49 30 E 5½ poles to a hickory; S 49 E 13½ poles to a white oak;
S 10 E 29 poles to a black gum; S 38 E 9 poles to a small hickory; S 46 W 9 poles
to a chestnut oak; S 71 3D W 14 poles to a white oak; S 56 E 9½ poles to a sourwood
on a flat place; S 20 W 43 poles to the Beginning, containing six-six (66) acres,
more or less, and being the same land conveyed by Fred Edwards and others to
Clarence Edwards by deed dated March 18, 1957, and of record in the Clerk's Office
of said county in Deed Book No. 113, page 253, reference to which is hereby made
for a more complete description of the land hereby conveyed.

There is excepted and reserved from the operation of this deed such
exceptions and reservations as heretofore make by deeds of record; and thereis also
excepted a life time interest in said land for the parties of the first part, with
the right to live on, use and enjoy the same for their natural lives.

To have and to hold unto the party of the second part his heirs and
assigns forever.

Witness the following signatures and seals.

Clarence Edwards (SEAL)
Bertha Edwards (SEAL)

VIRGINIA, DICKENSON COUNTY, TO-WIT:

I, A. M. Phipps, Commissioner in Chancery for the Circuit Court for

mailed
4.3.60
Clarence Edwards
Bertha Edwards

This deed made and entered into on this the 10th day of August, 1981 by and between Carl Rufus Edwards and Joyce Sue Edwards, husband and wife, parties of the first part, and Clarence Edwards and Bertha Edwards, husband and wife, as joint tenants with the right of survivorship, and not as tenants in common, parties of the second part.

W I T N E S S E T H

That for and in consideration of the sum of One Thousand Six Hundred Dollars (\$1,600.00) cash in hand paid the receipt of which is hereby acknowledged the said parties of the first part do hereby grant, bargain, sell and convey unto the said Clarence Edwards and Bertha Edwards as joint tenants with rights of survivorship and not as tenants in common with covenants of GENERAL WARRANTY AND ENGLISH COVENANTS OF TITLE, all of that certain tract or parcel of land lying and being in Dickenson County, Virginia, on the waters of Lickcreek and bounded and described as follows:

Beginning at a steel stake below the road at the corner of Ralph Edwards and James Henry Stilner property; S 3 30 W 8 poles to a bunch of Lynns; S 29 E 36 poles to a hickory; S 49 W 18 poles to a hickory on a spur; N 35 W 40 poles to a hickory in a gap; N 13 W 15 poles to a maple on a knob; N 75 W 27 1/2 poles to a white oak near a new fence; down a spur N 30 W 26 poles to a chestnut oak by a fence; N 54 W 13 poles to a chestnut oak; N 2 E 50 1/2 poles to a small sugar tree by a branch; thence down said branch N 55 30 W 15 poles to a small Lynn; N 49 E 5 poles to a steel stake below the peach tree on upper Harrigan Branch; then in a southeasterly direction 5 poles to another steel stake below road then in a southeasterly direction 10 poles below road beside apple tree; then in a southeasterly direction 10 poles to a steel stake at end of garden; then in a southeasterly direction 12 poles to another steel stake by a big rock below road; then in a southeasterly direction 15 poles straight above Clarence Edwards water box; then in a southeasterly direction 12 poles beside hickory tree; then in a southeasterly direction 13 poles to a steel stake beside big beech tree; then in a easterly direction 8 poles to a locust post and steel stake; then up the road in a southerly direction 290 feet to locust post and steel stake below road at the corner of Ralph Edwards and James Henry Stilner property back at the beginning containing 30 acres more or less. This portion of land that was conveyed by Clarence Edwards and Bertha Edwards July the 29th 1960 in deed book 118 page 553. This conveyance is made subject to all previous reservations and acceptions which have heretofore been made by proper deeds of record.

1
COMPARED

& mailed

To Carl Rufus Edwards

19.81

Lula Sturge

Dep. clerk

St. Rt. Box 11

Buckley, Va.

PAGE 2

WITNESS, the following signatures and seals:

Carl Rufus Edwards (SEAL)
Carl Rufus Edwards

Joyce Sue Edwards (SEAL)
Joyce Sue Edwards

State Of Virginia
County of Dickenson, to-wit:

I, Jo Ann Edwards a Notary public in and for the
aforesaid State and County do hereby certify that Carl Rufus Edwards and Joyce
Sue Edwards, whose names are signed to the forgoing deed has acknowledged the
same before me on this the 14 day of August 1981.

My Commission expires:

Sept 19, 1983
Jo Ann Edwards
Notary Public

I was commissioned
as Jo Ann Hart

VIRGINIA: In the Clerk's Office of the Circuit Court of Dickenson County, August 25, 1981. This deed was this day received in said office, and upon the certificate of acknowledgment... thereunto annexed and returned to record, at 11:30 o'clock A. M., after payment of 2.00 tax imposed by Sec. 58-54 (b), in deed book 209 page 319.
Teste: Jessie Bailey Clerk.
By Lulab Large Dep. Clerk.
Tax \$ 5.20 Transfer Fee \$ 1.00