

24256
 HAYSI UN

24256

DATE RECORDED 12-23-85
 DEED OR WILL BOOK 232-421
 427
 CONSIDERATION 3 Trchs 430
 150,000

DATE RECORDED
 DEED OR WILL BOOK
 CONSIDERATION

DATE RECORDED
 DEED OR WILL BOOK
 CONSIDERATION

DATE RECORDED
 DEED OR WILL BOOK
 CONSIDERATION

DATE RECORDED
 DEED OR WILL BOOK
 CONSIDERATION

CLASS 1
 ZONING
 DISTRICT 07

LEGAL DESCRIPTION
 HAYSI
 LOTS 7 8 9 10 11 12 BLK 4
 BLOCK 4

0000000001132

1982	38800	411400	450200
1983	38800	411,400	450,200
1984			
1985			
1986			
1987			
1988			
1989			
1990			
1991			
1992			
1993			
1994			
1995			
1996			
1997			
1998			
1999			
2000			
2001			
2002			
2003			

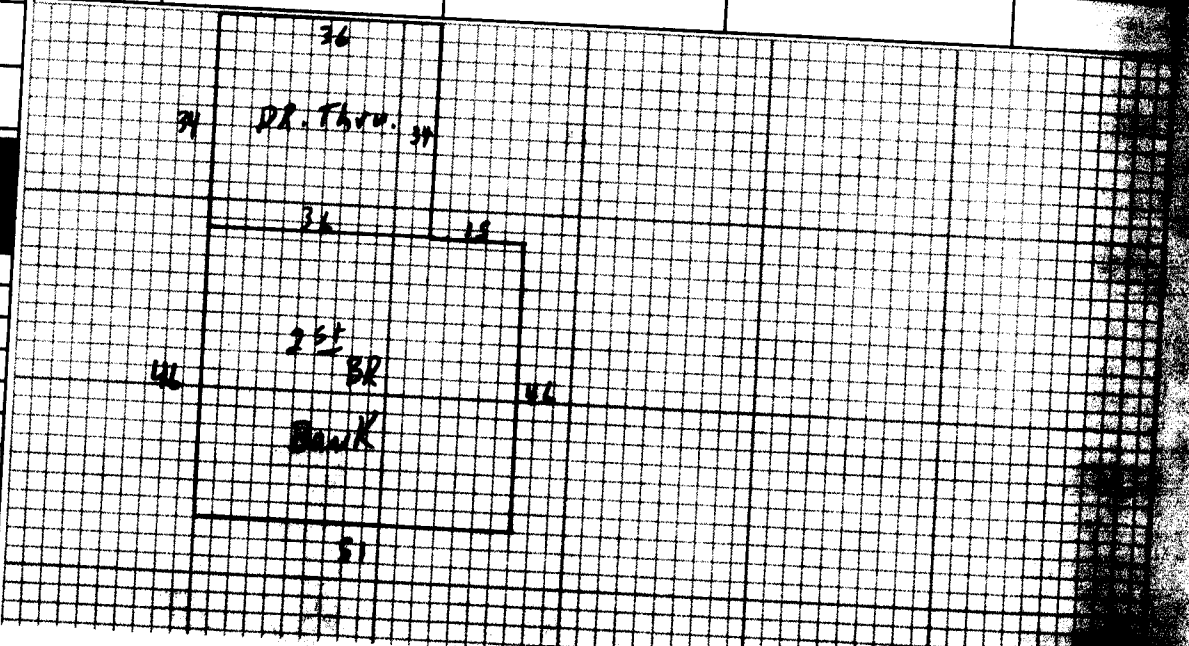

NOTES:

Dwelling	Comp. Sh.	Wood Siding	Yr. Built	Remod.	Bemt.	1st	2nd	3rd	Plaster	BATHS	Full
BANK	✓	Brick	✓	2	1st	3rd			Sheet rock	Modern Bath	Modern
	Asbestos	Asb. Wood Shg.	G. Level	B. Floor	Total No. Bedrooms			Ceiling		Cont. Heat	✓
Wood Frame	Tar & Grav.	Cin. Block	Stone					Panel	✓	Flr. or Wall Furnace	
Cin. Block	Tile	Stucco	Con. Block	Crawl	Conc.	100		Unfinished			
Steel Frame	Shakes	Aluminum	Masonite	Fiers	Cin. Blk.						
		Storm Doors	Storm Win.	Slab	Brick	Disappearing Stairs				Number Chimneys	

Basement Size	Attic Floor & Stairs	Brick	C. Block
Basement Finish	Attic Finish	Stone	Metal
Basement	Attic	YR. 92	YR.

Dwelling	BANK	B	435544	-6%	409500
Porch					
Porch					
Carport					
Garage					
Cent. AC	5320				
Basement					
Bemt. Finish					
Attic					
Fireplace(s)					
Heating					
Bath(s)					
Total	435544				
Factor					
Replacement					

M & L	M & L	Market Value All Improvements	407600
DATE	DATE	Market Value All Land	38800
APRP.	APRP.		436400
DATE	DATE		
CLASSIFICATION	ZONING		

100	350	35000																		
-----	-----	-------	--	--	--	--	--	--	--	--	--	--	--	--	--	--	--	--	--	--

CLASSIFICATION	ACRES	RATE	ADJ.	CLASSIFICATION	ACRES	RATE	ADJ.
Home Site				Home Site			
Public Water				Public Water			
Public Sewer				Public Sewer			
Well				Well			
Spring				Spring			
Electric System				Electric System			
St. B. Utilities				St. B. Utilities			

General Remarks:

Lot 7-8
Lot 12

2500
1300

35000

BOARD REVIEW NOTES