

KISER VIVIAN
BOX 43
HAYSI VA

24256

DATE RECORDED
DEED OR WILL BOOK
CONSIDERATION

DATE RECORDED
DEED OR WILL BOOK
CONSIDERATION

DATE RECORDED
DEED OR WILL BOOK
CONSIDERATION

DATE RECORDED
DEED OR WILL BOOK
CONSIDERATION

DATE RECORDED
DEED OR WILL BOOK
CONSIDERATION

CLASS 1
ZONING
DISTRICT 07

LEGAL DESCRIPTION
PRATER CREEK
.5AC

1992			
1993			
1994	5,000	60,700	65,700
1995	5,000	60,700	65,700
1996			
1997			
1998	5,000	60,700	65,700
1999			
2000			
2001			
2002			
2003			

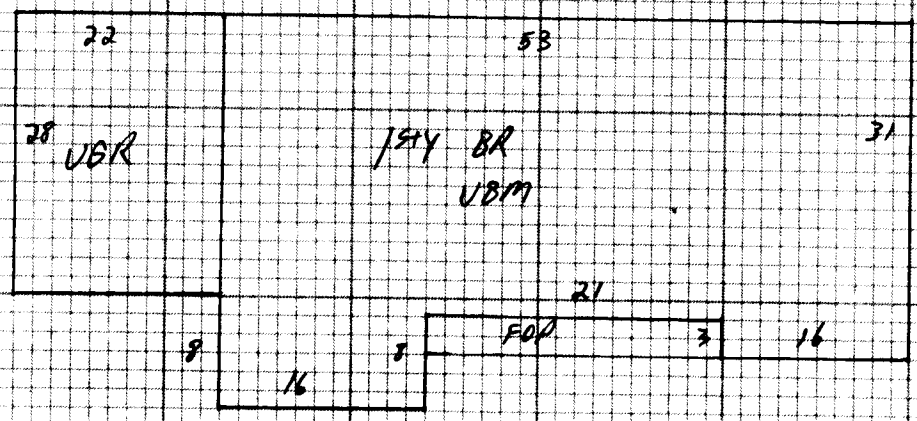

NOTES:

Dwelling	<input checked="" type="checkbox"/>	Comp. Sh.	<input checked="" type="checkbox"/>	Wood Siding		Yr. Built	65	Remod.		Bsmt.	[]	2nd	[]	Plaster		BATH(S)	Full	1/2 Bath(s)			
		Slate		Brick	<input checked="" type="checkbox"/>	No. Stories	1			1st	[]	3rd	[]	Sheet rock	<input checked="" type="checkbox"/>	Modern Bath	<input type="checkbox"/>	Modern Kitchen	<input type="checkbox"/>		
		Asbestos		Asb. Wood Shg.		S. Level	<input type="checkbox"/>	S. Foyer	<input type="checkbox"/>	Total No. Bedrooms				Ceciled		Cent. Heat		A/C			
		Metal		Cin. Block	<input type="checkbox"/>	Stone	<input type="checkbox"/>							Panel		Fir. or Wall Furnace	<input type="checkbox"/>	Stove(s)	<input type="checkbox"/>		
Wood Frame	<input checked="" type="checkbox"/>	Tar & Grav.		Stucco	<input type="checkbox"/>	Con. Block	<input type="checkbox"/>	Crawl	<input type="checkbox"/>	Conc.	<input type="checkbox"/>	HW	<input type="checkbox"/>	Pine	<input type="checkbox"/>	Carp.	<input checked="" type="checkbox"/>	Tile	<input checked="" type="checkbox"/>		
Cin. Block		Tile		Aluminum	<input type="checkbox"/>	Masonite	<input type="checkbox"/>	Riers	<input type="checkbox"/>	Cin. Blk.	<input checked="" type="checkbox"/>			Unfinished							
Steel Frame		Shakes		Storm Doors	<input type="checkbox"/>	Storm Win.	<input type="checkbox"/>	Slab	<input type="checkbox"/>	Brick	<input type="checkbox"/>	Disappearing Stairs		Gd.	<input type="checkbox"/>	Fair	<input type="checkbox"/>	Poor	<input type="checkbox"/>	VP	<input type="checkbox"/>

1574	1660	33	54780																	

Porch	0	63	8	504																
Porch																				
Carport		616	11	6776																
Garage																				
Cent. A/C																				
Basement		1660	6.5	10790																
Bsmt. Finish																				
Attic																				
Fireplace(s)				2000																
Heating																				
Bath(s)																				
Total				74850																
Factor				1																
Replacement				74850																

LEVEL	<input type="checkbox"/>	SLOPES UP	<input type="checkbox"/>	SLOPES DOWN	<input type="checkbox"/>	General Remarks:														
LOW	<input type="checkbox"/>	STEEP UP	<input type="checkbox"/>	STEEP DOWN	<input type="checkbox"/>															